

BENCHMARK:
 Intersection of 28th Street North
 and Regency Park: Brass Disk on
 top of curb.
 Elevation = 1382.88 (NAVD 88)

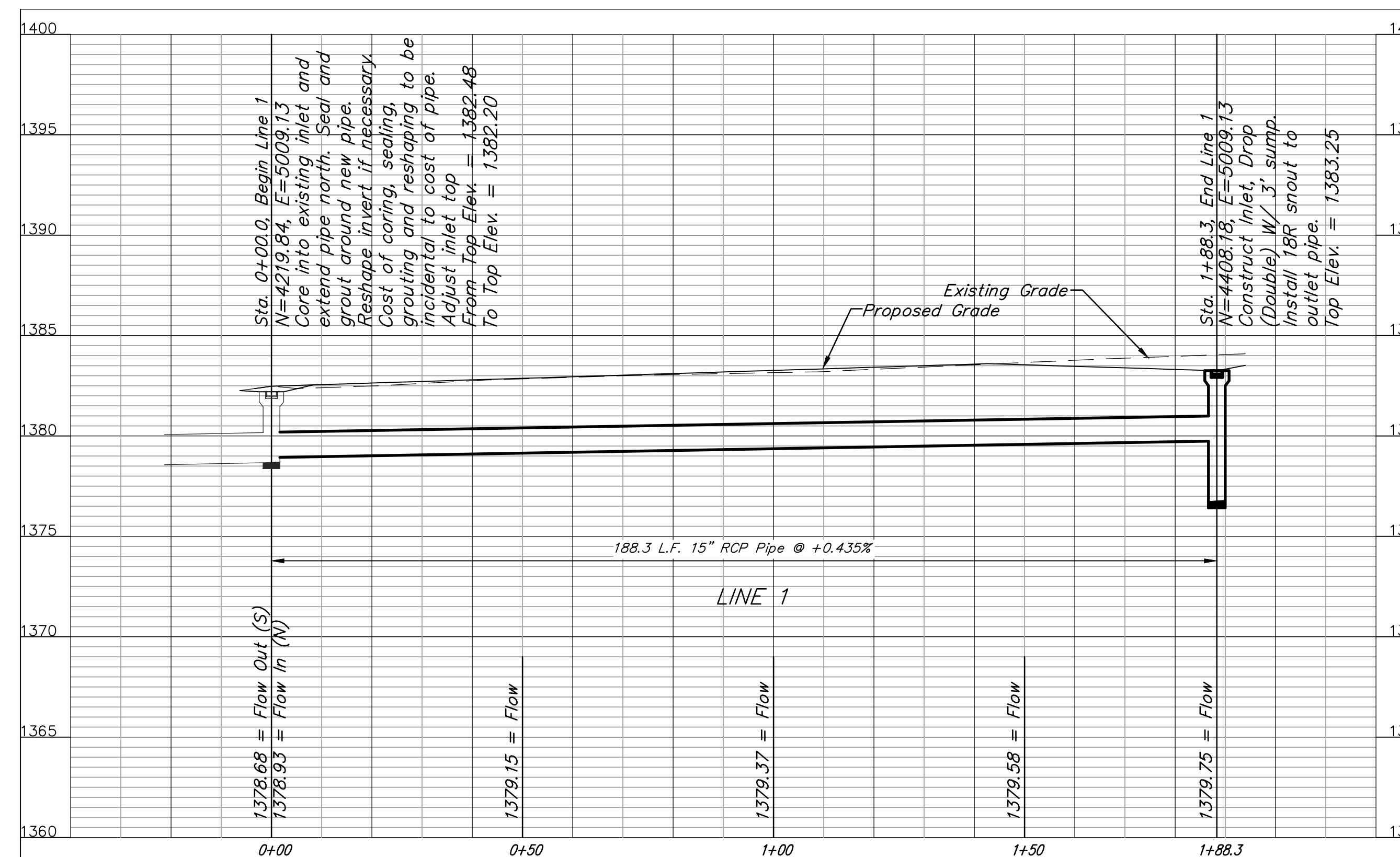
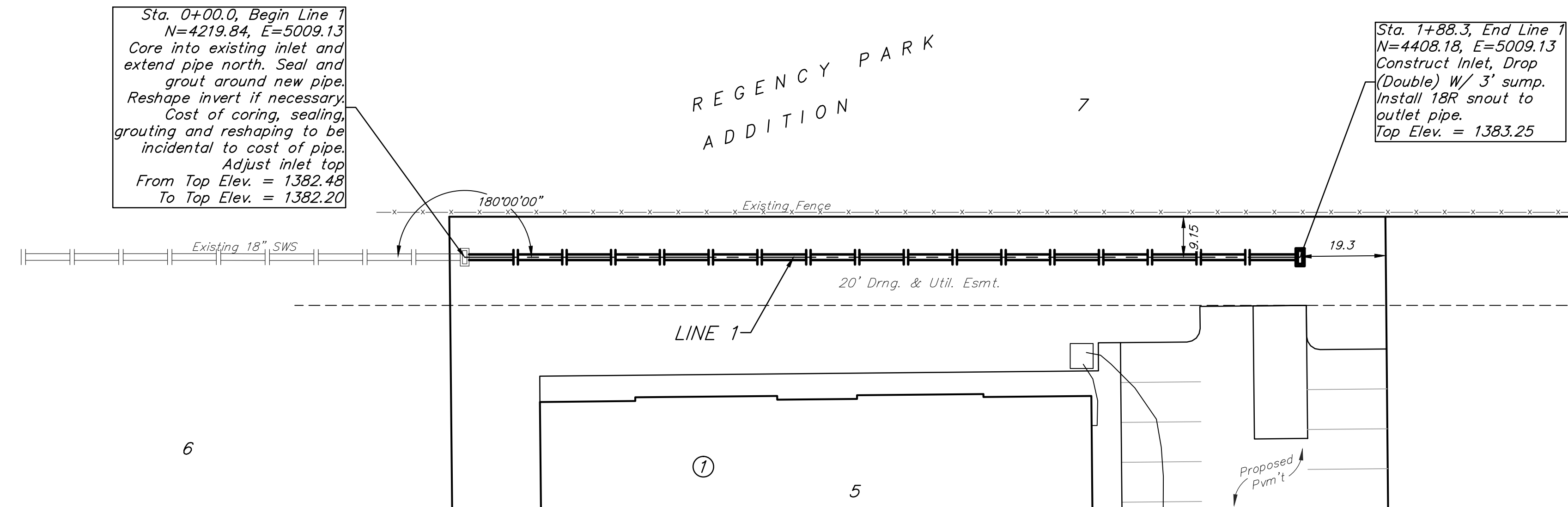
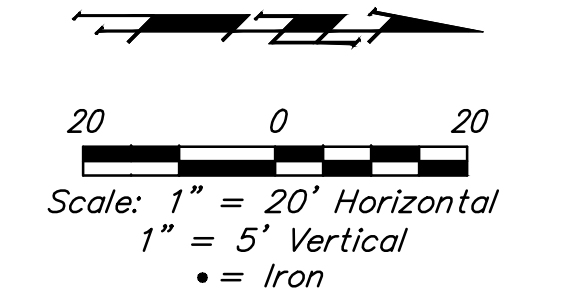

Contractor shall verify
 elevation and alignment of
 existing 18" pipe prior to
 construction and notify
 Engineer of any discrepancy.

	REGENCY PARK ADDITION LINE 1 STORM WATER SEWER IMPROVEMENTS	
	<small>Baughman Company, P.A. 315 Ellis St., Wichita, KS 67211 P 316-262-7271 F 316-262-0149 ENGINEERING SURVEYING PLANNING LANDSCAPE ARCHITECTURE</small>	
PROJECT NUMBER REVISIONS:	DESIGN TJW APPROVED SCALE Noted SHEET	DRAWN TMS DATE 06/15 4 OF 11
<small>SWS.dwg</small>		<small>15-04-E238</small>