

STATE	PROJECT NO.	YEAR	SHEET NO.	TOTAL SHEETS
KANSAS	87 N-0612-01	2015	7	84

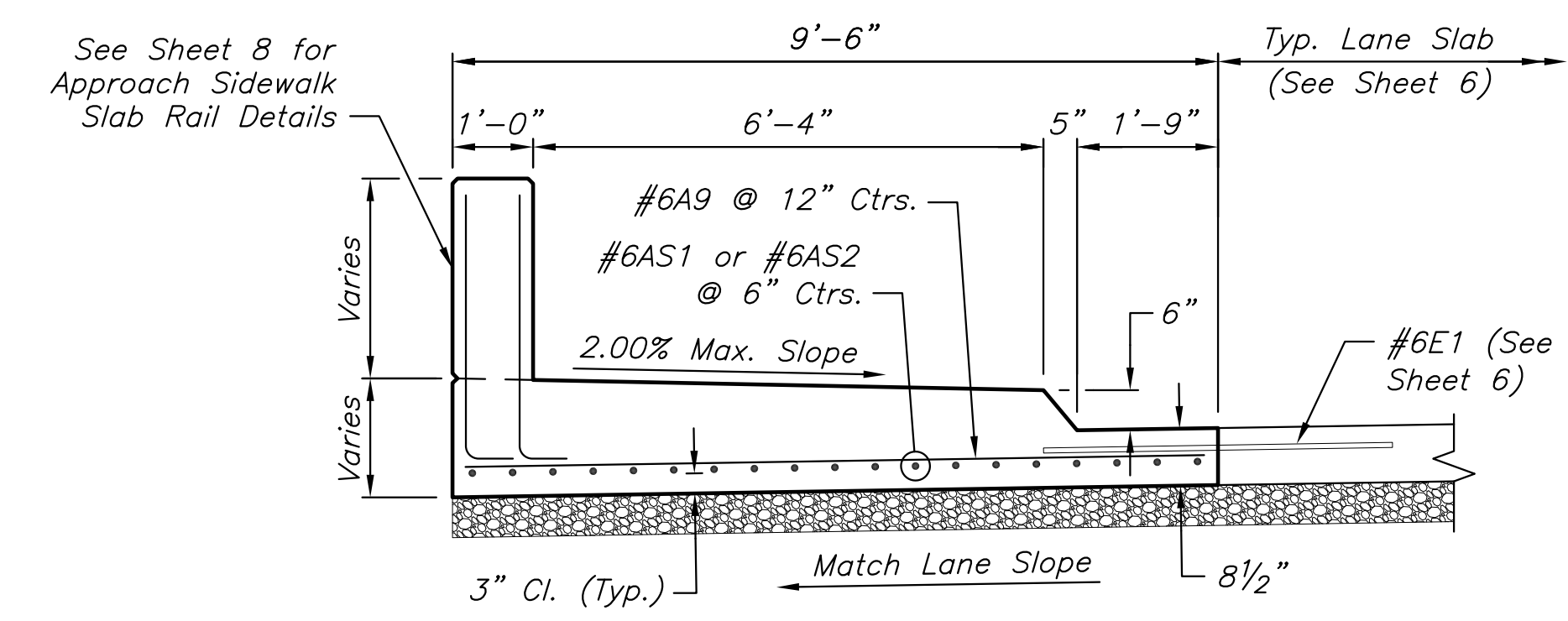

TYPICAL SECTION

Shown Perpendicular to \perp Prop. Impr.
 North Approach Sidewalk Slabs (Looking Forward Station)
 South Approach Sidewalk Slabs (Looking Back Station)

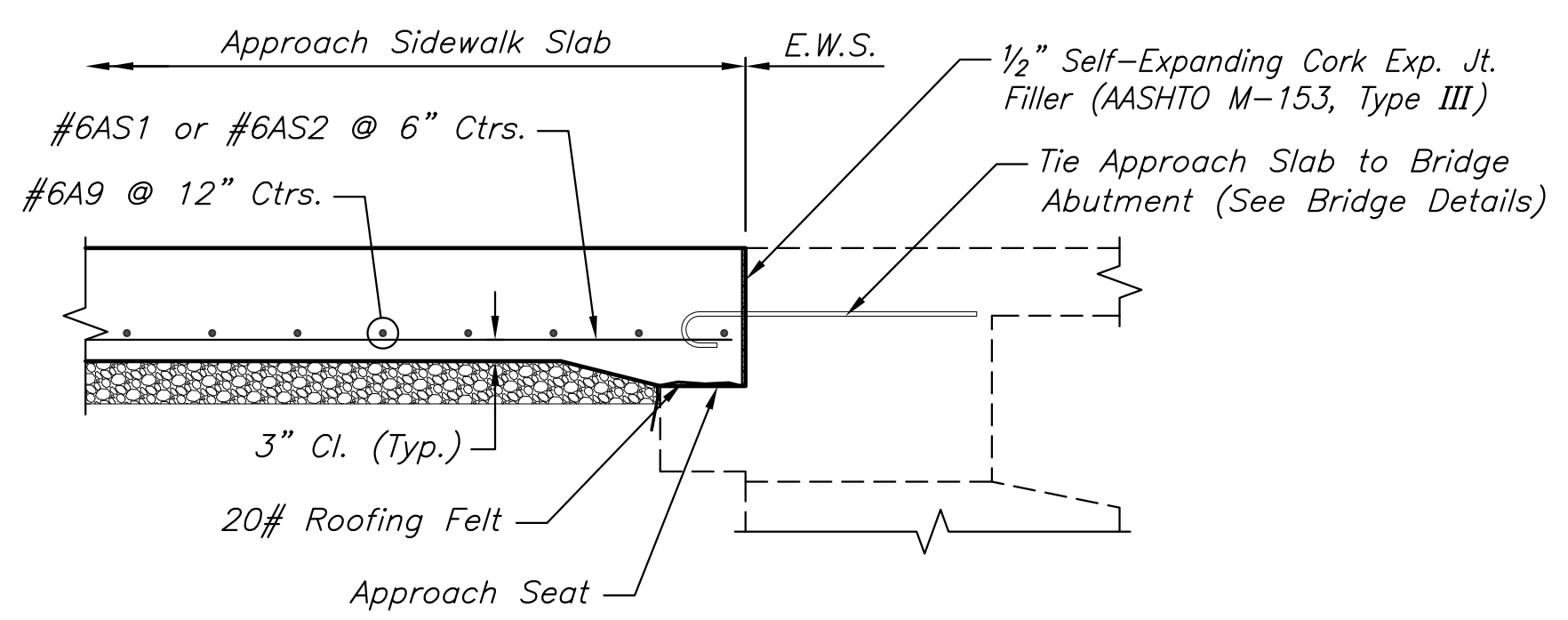

LONGITUDINAL SECTION

At Bridge E.W.S.

GENERAL NOTES

1. Special Concrete Bridge Approach shall be paid for as sq. yds of "Concrete Approach 12", Bridge" and includes all work and materials required to construct the approach slab as shown on this sheet.
2. Approach Transition Rail shall be paid for as lineal feet of "Concrete Safety Barrier, Special".
3. Formed joints shall be edged with 1/4" radius tool for length of joint.
4. Clearance from the face of concrete for all reinforcing steel, unless noted, shall be 2".
5. All casting to existing concrete, if cast previously, shall be brush blasted and power washed prior to casting concrete.
6. All reinforcing steel shall be epoxy coated. All epoxy coating damaged or removed through cutting shall be replaced as required by Specifications.
7. Standard reinforcing bar hooks in accordance with the latest ACI specifications shall be used throughout.
8. All work and materials required for installation of expansion joints shall be subsidiary to the bid item "Concrete Approach 12", Bridge".
9. At the Contractor's option #4x3'-0" tie bars at 15" centers may be substituted for the #6E2 bars at 2'-6" centers.
10. Skew Angle to match existing bridge E.W.S.

BILL OF REINFORCING STEEL (All Approach Sidewalk Slabs)			
Epoxy Coated, Grade 60			
△ See Bending Diagram			
Bar	A9	△ AS1	△ AS2
No.	106	38	38
Size	#6	#6	#6
Length	9'-2"	24'-7"	30'-1"

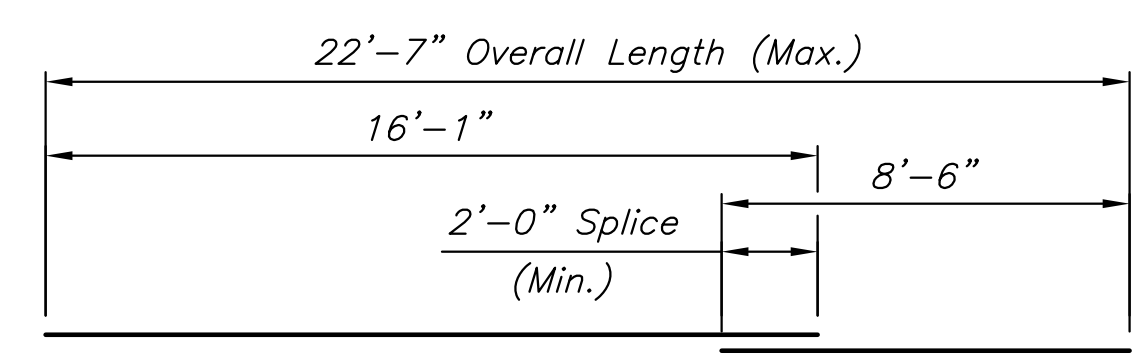

AS1 Series Bar

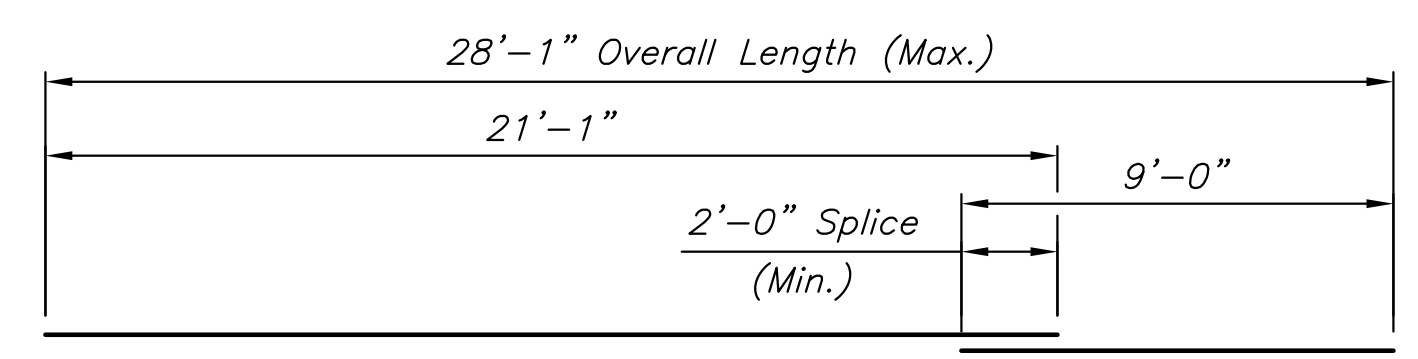

AS2 Series Bar

BAR BENDING DIAGRAMS

All dimensions are out to out of bars

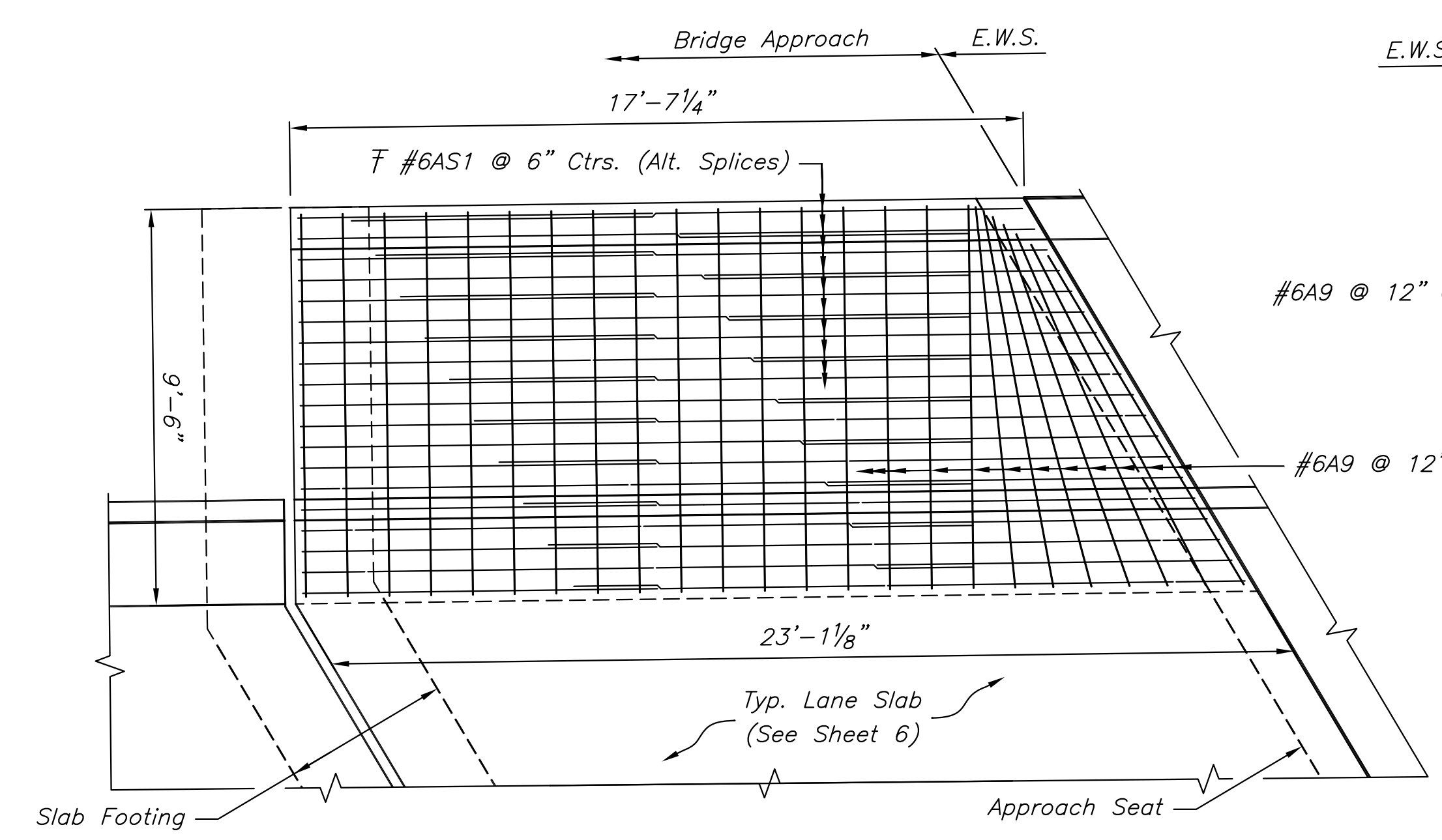

APPROACH SIDEWALK SLAB (SHORT)

West Bridge Approach Shown
 East Approach Sidewalk Slab (Short)
 Dimensions and Reinforcing Identical

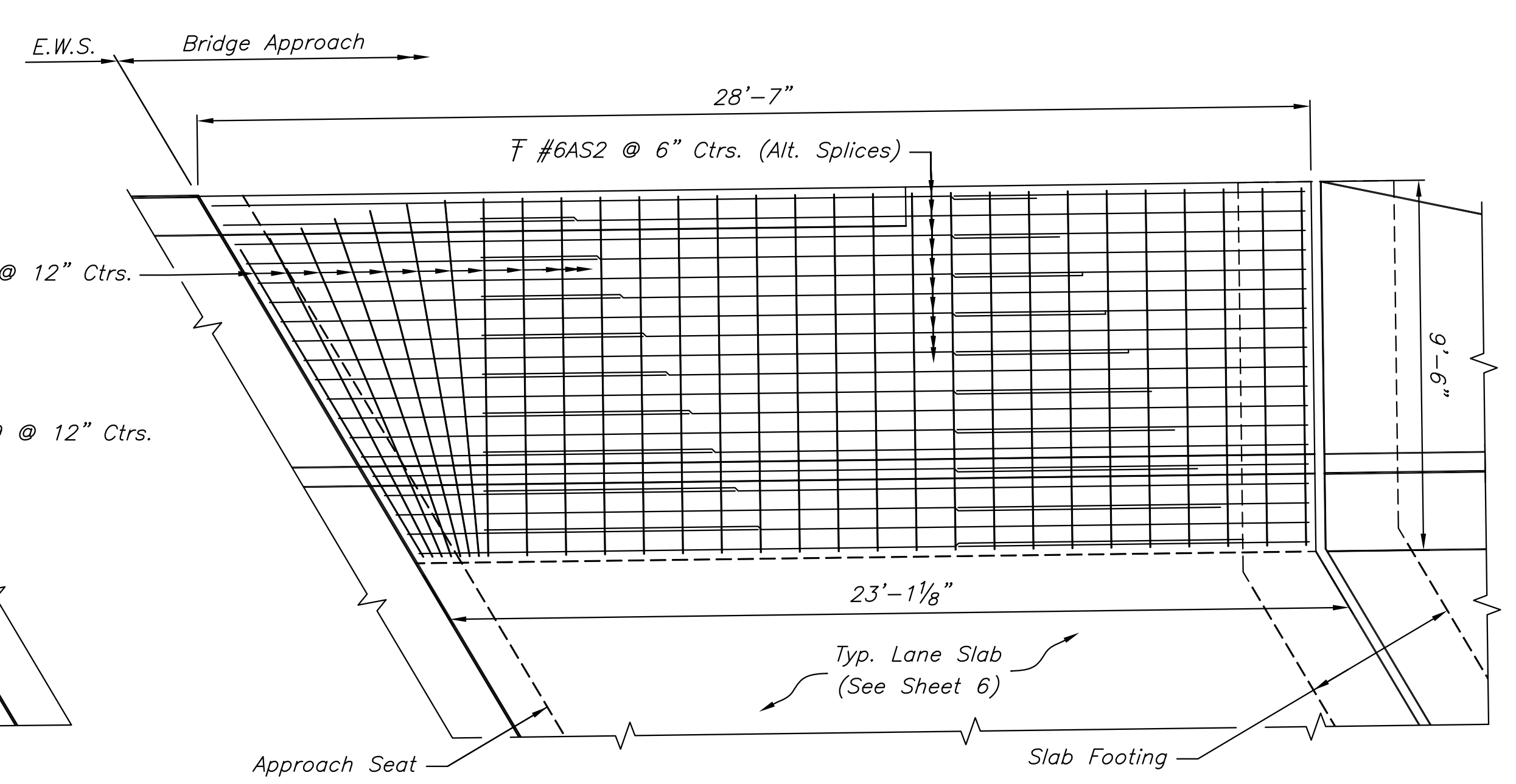

APPROACH SIDEWALK SLAB (LONG)

East Bridge Approach Shown
 West Approach Sidewalk Slab (Long)
 Dimensions and Reinforcing Identical

∇ Increase splice length as required to provide 2" min. cl.



CONSTRUCTION PLANS FOR
21ST STREET BRIDGE AT DERBY REFINERY
 WICHITA, KANSAS

©2013 MKEC Engineering All Rights Reserved
 www.mkec.com
 These drawings and their contents, including, but not limited to, all concepts, designs, & ideas are the exclusive property of MKEC Engineering (MKEC), and may not be used or reproduced in any way without the express consent of MKEC.

APPROACH SIDEWALK SLAB DETAILS

PROJECT NO.	472-85120	
DATE	JULY 2015	
SCALE	NO SCALE	
DESIGNED	DRAWN	CHECKED
KJS	DMU	KJS

NO.	REVISION	DATE

SHEET NO.

PLOTTED: Tuesday, July 21, 2015 10:09AM

J:\PROJECTS\2013\1301040546_21ST BRIDGE AT DERBY REFINERY\CIVIL\CA\PAV1\3548ED03.DWG