

STATE	PROJECT NO.	YEAR	SHEET NO.	TOTAL SHEETS
KANSAS	87 N-0612-01	2015	71	84

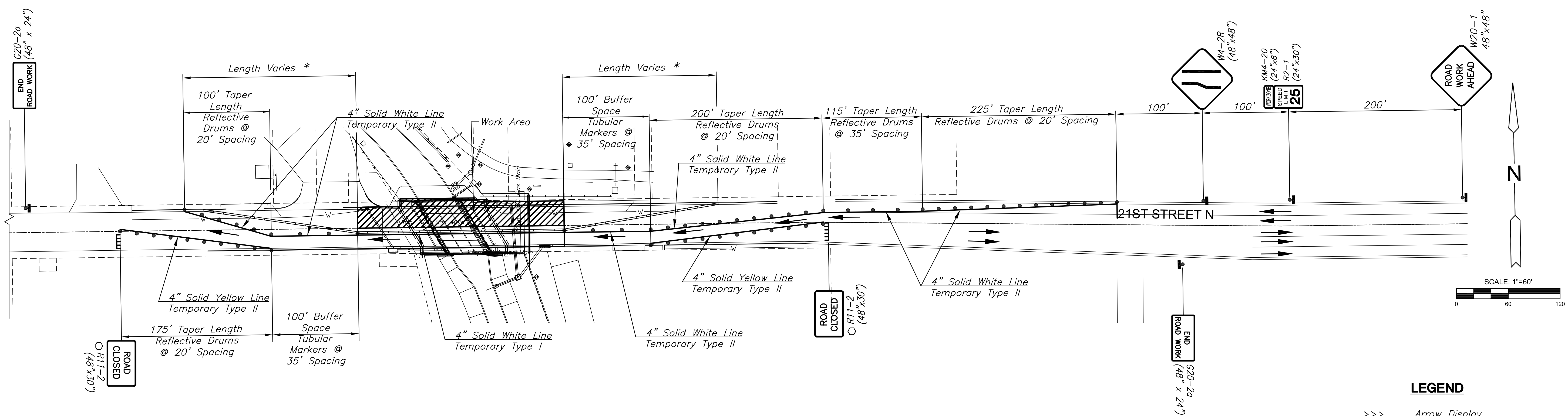

CONSTRUCTION PLANS FOR
21ST STREET BRIDGE AT DERBY REFINERY
 WICHITA, KANSAS



PLAN - PHASE 2

* Temporary Concrete Safety barriers shall be installed on a 6:1 or flatter taper.

The end section of the barrier shall be a tapered section.

The end of the barrier shall have a minimum lateral distance of 6.0 foot to the south of the centerline of 21st Street.

See details in plans for proper anchorage and placement of barrier.

LEGEND

>>>	Arrow Display
	Type III Barricade
○	Mount on Type III Barricade
●	Channelizer
—	Temporary Concrete Safety Barrier
▨	Work Area
→	Traffic Flow
△	Temporary Concrete Safety Barrier

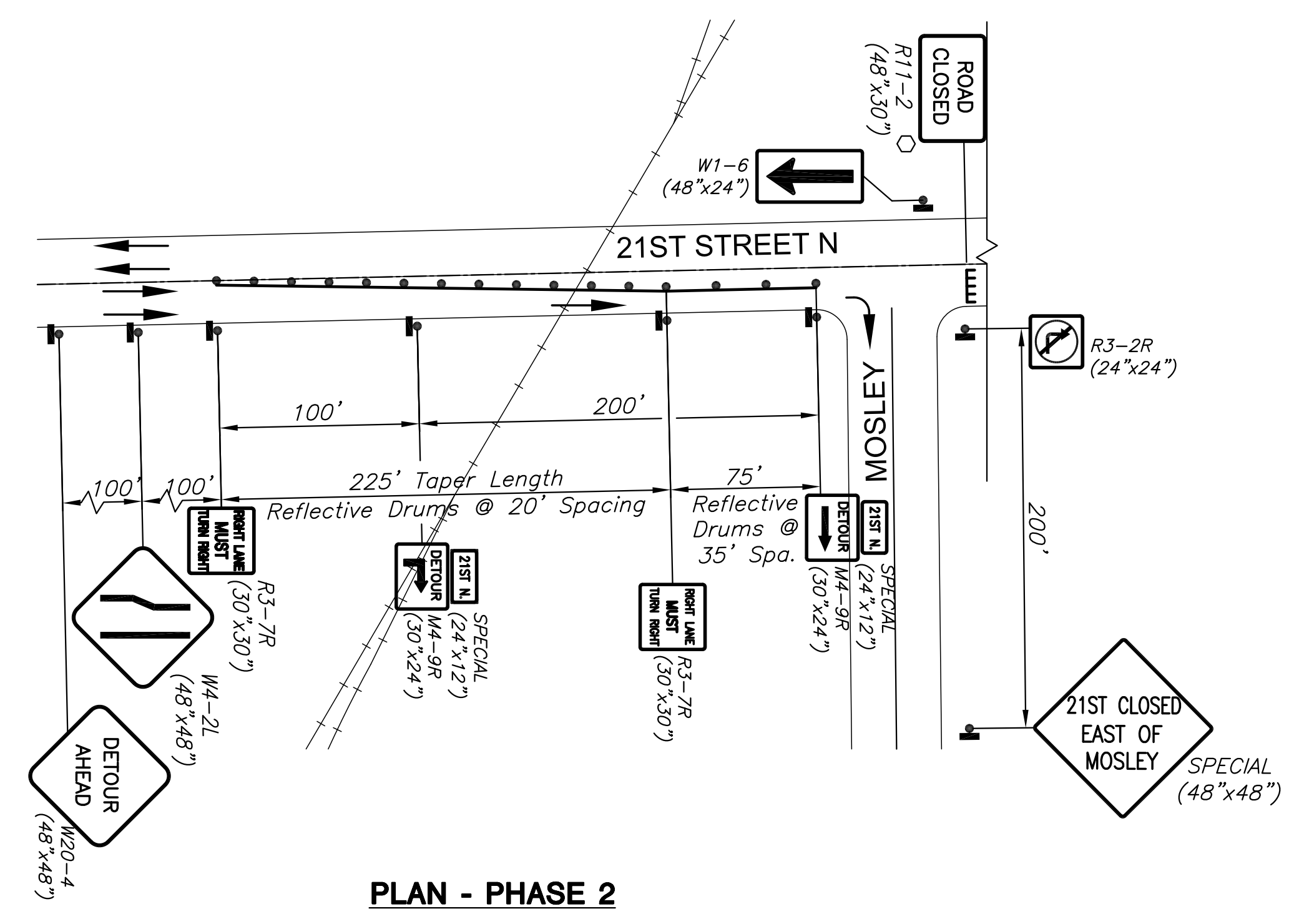

PLAN - PHASE 2

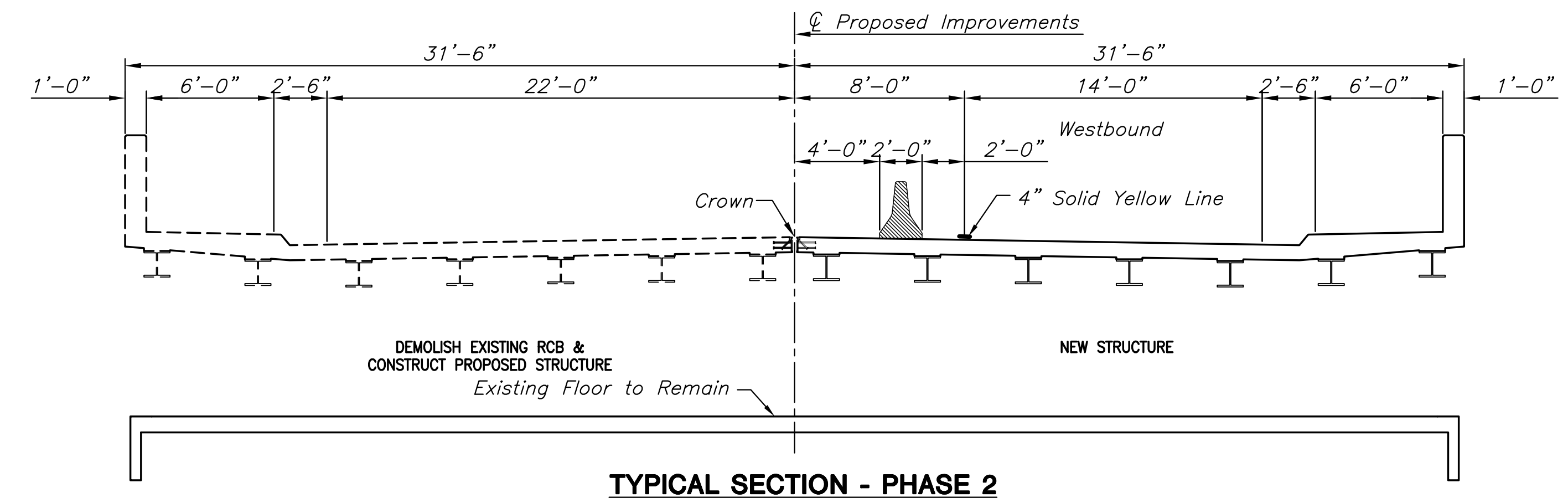

TYPICAL SECTION - PHASE 2

©2015 MKEC Engineering All Rights Reserved www.mkec.com
 These drawings and their contents, including, but not limited to, all concepts, designs, & ideas are the exclusive property of MKEC Engineering (MKEC), and may not be used or reproduced in any way without the express consent of MKEC.

TRAFFIC CONTROL PHASE 2

PROJECT NO.	472-85120	
DATE	JULY 2015	
SCALE	1" = 60'	
DESIGNED	DRAWN	CHECKED
JRA	WNJ	JRA
NO.	REVISION	DATE
SHEET NO.		
71 OF 84		