

Brentwood South Addition

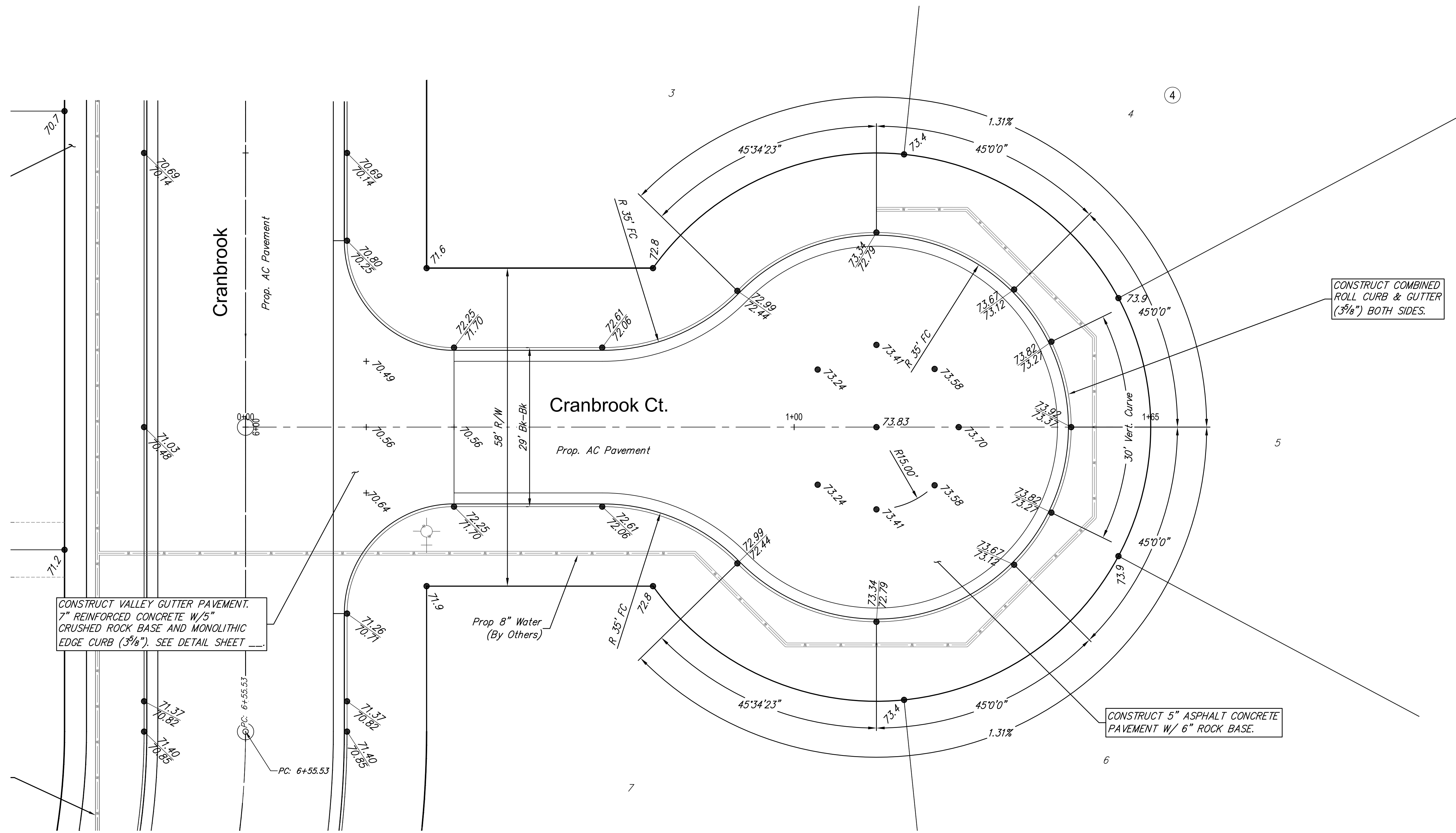

CONSTRUCT VALLEY GUTTER PAVEMENT.  
7" REINFORCED CONCRETE W/5"  
CRUSHED ROCK BASE AND MONOLITHIC  
EDGE CURB (3 3/8"). SEE DETAIL SHEET

CONSTRUCT COMBINED  
ROLL CURB & GUTTER  
(3 3/8") BOTH SIDES.

CONSTRUCT 5" ASPHALT CONCRETE  
PAVEMENT W/ 6" ROCK BASE.

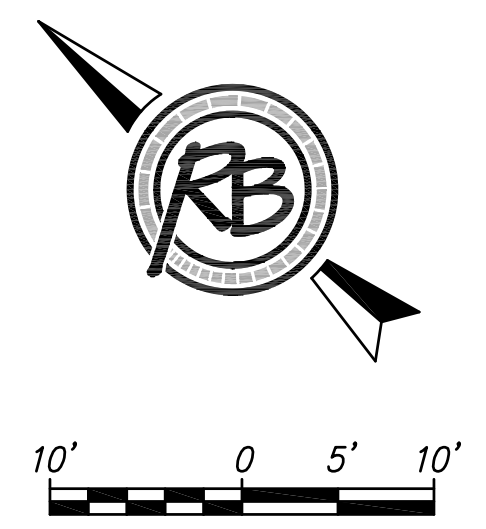

F:\Projects\Projects 4500-4599\4532E (Brentwood South Addition Ph 5 - Base.dwg)

(c) Copyright 2015, Ruggles & Bohm, P.A.

<b>Brentwood South Addition Cranbrook Ct</b>			
SEAL		<b>RUGGLES &amp; BOHM</b>	
		ENGINEERING   SURVEYING   LANDSCAPE ARCHITECTURE   GOVERNMENT 924 NORTH MAIN WICHITA, KANSAS 67203 P (316) 264-8008 F (316) 264-4621 WWW.RBKANSAS.COM	
PROJECT NUMBER <b>472-85218</b>	RB JOB NO. <b>4532E</b>	DWG. SCALE ...	DATE ...
DRAWING FILE 4532E Brentwood South Ph 5 - Base [Cranbrook Ct]			SHEET <b>14</b> OF <b>39</b>