

STATE	PROJECT NO.	YEAR	SHEET NO.	TOTAL SHEETS
KANSAS	87N-0582-01	2015	20	59

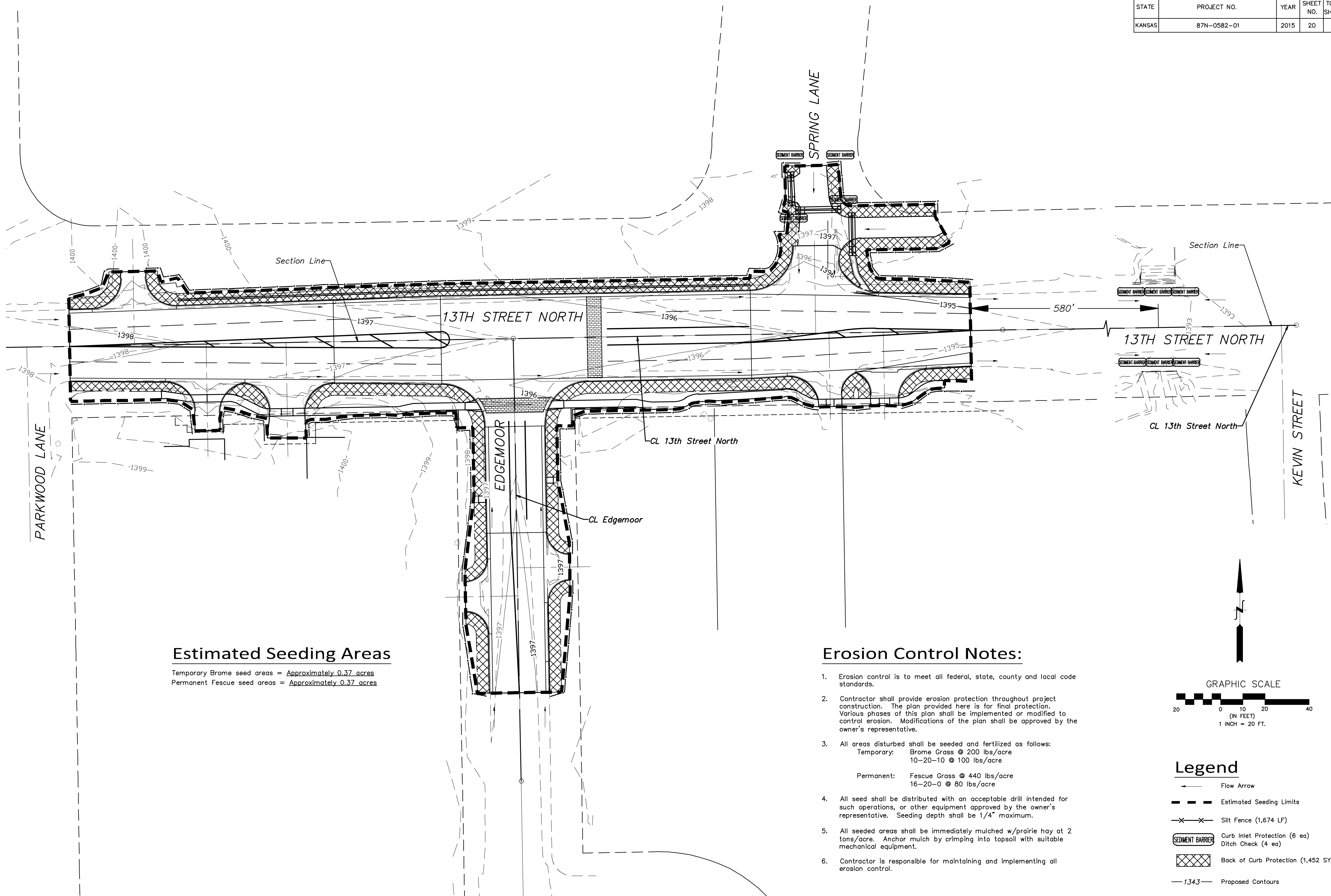

Estimated Seeding Areas

Temporary Brome seed areas = Approximately 0.37 acres
 Permanent Fescue seed areas = Approximately 0.37 acres

Erosion Control Notes:

- Erosion control is to meet all federal, state, county and local code standards.
- Contractor shall provide erosion protection throughout project construction. The plan provided here is for final protection. Various phases of this plan shall be implemented or modified to control erosion. Modifications of the plan shall be approved by the owner's representative.
- All areas disturbed shall be seeded and fertilized as follows:
 Temporary: Brome Grass @ 200 lbs/acre
 10-20-10 @ 100 lbs/acre

 Permanent: Fescue Grass @ 440 lbs/acre
 16-20-0 @ 80 lbs/acre
- All seed shall be distributed with an acceptable drill intended for such operations, or other equipment approved by the owner's representative. Seeding depth shall be 1/4" maximum.
- All seeded areas shall be immediately mulched w/prairie hay at 2 tons/acre. Anchor mulch by crimping into topsoil with suitable mechanical equipment.
- Contractor is responsible for maintaining and implementing all erosion control.

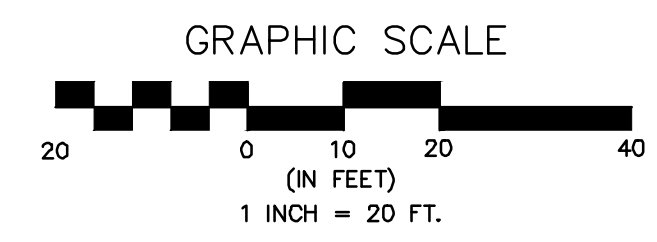

Legend

- > Flow Arrow
- - - - - Estimated Seeding Limits
- x-x-x- Silt Fence (1,674 LF)
- SEEDMENT BARRIER Curb Inlet Protection (6 ea)
Ditch Check (4 ea)
- Back of Curb Protection (1,452 SY)
- 1343- Proposed Contours
- 1393- Existing Contours

13TH & EDGEMOOR	SWPPP	CITY OF WICHITA, KANSAS		GARY JANZEN, P.E. - CITY ENGINEER		No.	Date	By	Approved	Revision
POE & ASSOCIATES, INC. CONSULTING ENGINEERS 544 West Douglas Avenue Wichita, KS 67203 Phone 316.685.4114 FAX 316.685.4444										
FINAL Engineer: J. DICKMAN Designer: J. UNRUH Dwg. P: 102091-102091-Base Job No: 87N-0582-01 Date: 8/31/2015										
20	Sheet								of	59