

FHWA REGION NO.	STATE	PROJECT NO.	YEAR	SHEET NO.	TOTAL SHEETS
7	KANSAS	472-85210	2015	18	28

GENERAL TRAFFIC CONTROL NOTES

1. THE TRAFFIC CONTROL PLAN FOR THIS PROJECT INCLUDES ONE MAJOR PHASE OF WORK. THE CONTRACTOR HAS THE OPTION OF DEVELOPING AN ALTERNATE TRAFFIC CONTROL PLAN AND SUBMITTING IT TO THE ENGINEER FOR REVIEW AND APPROVAL (AT LEAST TWO WEEKS PRIOR TO PROPOSED IMPLEMENTATION).
2. THIS TRAFFIC CONTROL PLAN WILL COVER THE MAJORITY OF THE WORK INVOLVED ON THIS PROJECT. WORK SITUATIONS NOT SPECIFICALLY COVERED BY THE TRAFFIC CONTROL PLANS SHALL BE HANDLED IN ACCORDANCE WITH THE TYPICAL TRAFFIC CONTROL LAYOUTS SHOWN IN THESE PLANS, AND AS DIRECTED BY THE ENGINEER. THE CONTRACTOR SHALL REVIEW ALL PROPOSED TRAFFIC CONTROL LAYOUTS WITH THE ENGINEER IN CHARGE OF CONSTRUCTION PRIOR TO IMPLEMENTATION.
3. THE CONTRACTOR SHALL BE RESPONSIBLE FOR MAINTAINING ACCESS TO ALL ROADWAYS AND PROPERTIES DURING CONSTRUCTION AND SHALL KEEP ALL TRAFFIC LANES CLEAR OF MUD AND DEBRIS.
4. UNLESS OTHERWISE NOTED ON THE TRAFFIC CONTROL PLANS, TEMPORARY PAVEMENT MARKINGS SHALL BE TYPE I TEMPORARY PAVEMENT MARKING TAPE. THE CONTRACTOR SHALL MAINTAIN ALL TEMPORARY PAVEMENT MARKINGS THROUGHOUT THEIR INTENDED SERVICE LIVES.
5. EXISTING SIGNS NECESSARY FOR TRAFFIC DURING CONSTRUCTION SHALL BE ADJUSTED (AND LATER RESET) AS NECESSARY AND AS DIRECTED BY THE ENGINEER IN CHARGE OF CONSTRUCTION TO PROVIDE PROPER VISIBILITY.
6. WHERE AN EXISTING SIGN OR LEGEND IS INDICATED TO BE COVERED, THE CONTRACTOR SHALL COMPLETELY COVER THE SIGN OR SIGN LEGEND USING OPAQUE WATERPROOF MATERIAL. TAPE SHALL NOT BE APPLIED TO THE SIGN FACE. WORK ASSOCIATED WITH SIGN COVERING SHALL BE CONSIDERED SUBSIDIARY TO OTHER TRAFFIC CONTROL BID ITEMS.
7. ONCE THE WORK IS COMPLETE, THE CONTRACTOR SHALL INSTALL ALL PERMANENT MARKINGS AS SHOWN ON THESE PLANS.
8. PLACEMENT OF SIGNS AND OTHER DEVICES SHOWN IN THESE PLANS MAY BE ADJUSTED TO MORE ACCURATELY REFLECT FIELD CONDITIONS, AS DIRECTED BY THE ENGINEER. THE CONTRACTOR IS RESPONSIBLE FOR AVOIDING ANY AND ALL UTILITIES WHEN SETTING SIGN POSTS AND SHALL COORDINATE ACTIVITIES WITH ANY AND ALL UTILITY COMPANIES WHETHER THEIR FACILITY IS SHOWN ON THE PLANS OR NOT. THE ENGINEER IN CHARGE OF CONSTRUCTION WILL APPROVE THE FINAL LOCATION OF ALL TRAFFIC CONTROL DEVICES.
9. ANY WORK REQUIRED FOR HANDLING TRAFFIC DURING CONSTRUCTION THAT IS NOT COVERED BY A SPECIFIC BID ITEM SHALL BE CONSIDERED SUBSIDIARY TO OTHER TRAFFIC CONTROL BID ITEMS.
10. ADDITIONAL NOTES FOR GENERAL TRAFFIC CONTROL AND TRAFFIC CONTROL DEVICES ARE SHOWN ON THE KDOT STANDARD DETAIL SHEETS INCLUDED IN THESE PLANS.

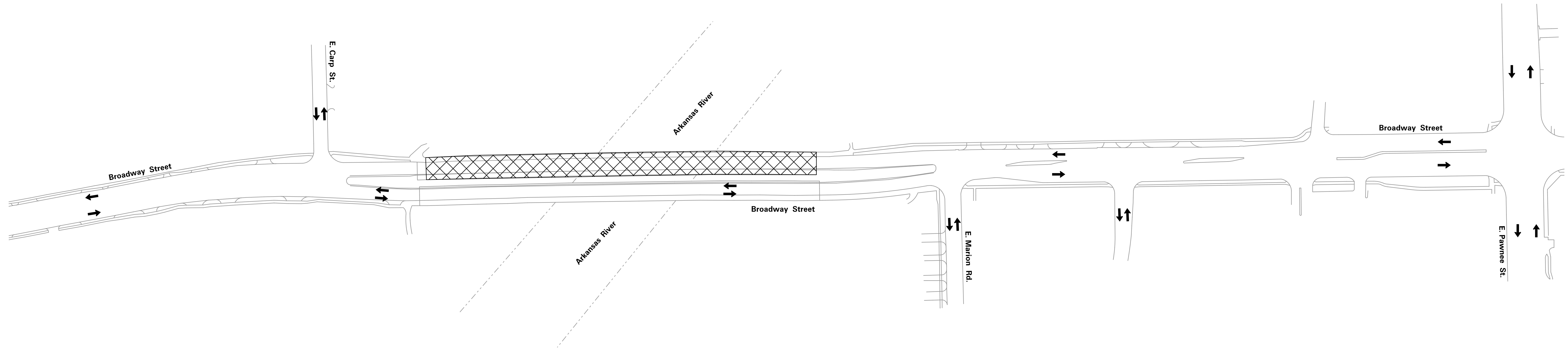
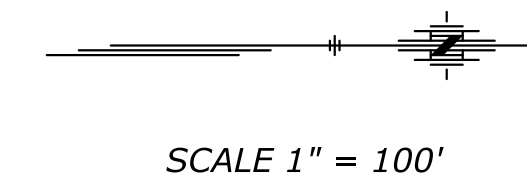

NOTES:

WORK INCLUDES REPAIRING AND RESURFACING THE SOUTHBOUND BRIDGE OVER THE ARKANSAS RIVER.

- TRAFFIC THROUGHOUT CONSTRUCTION SHALL BE MAINTAINED AS FOLLOWS:
- ONE NORTHBOUND AND ONE SOUTHBOUND LANE CARRIED ON THE EXISTING NORTHBOUND BROADWAY STREET TRAVELWAY.
 - ALL SIDE STREETS SHALL REMAIN OPEN DURING CONSTRUCTION. ACCESS TO ALL PROPERTIES SHALL BE MAINTAINED AT ALL TIMES; SEE TRAFFIC CONTROL PLANS FOR MORE INFORMATION.

LEGEND

- WORK AREA
- DIRECTION OF TRAVEL

Plot File: c:\trnsys\stems\pw\local\trnsys\cor\p\pw\aj\dir\me\01924\4CS-101.dgn
 Plot Date: 10/5/2015
 Plot Location:

3				
2				
1				
NO.	DATE	REVISIONS	BY	APP'D
CITY OF WICHITA BR. NO. 53040087000AR30 STA. 236+89.80 CONSTRUCTION SEQUENCING REHABILITATION OF THE JOHN MACK BRIDGE OVER THE KANSAS RIVER				
SHEET NO.	OF	SCALE	APP'D	
DESIGNED		DETAILED	QUANTITIES	CADD
DESIGN CK.		DETAIL CK.	QUAN. CK.	CADD CK.