

BENCHMARK:  
 BM #6 - Chiseled "a" on the Top of Curb on the South Side of Walker Street, 80± East of Centerline of Meridian. Elev. = 1295.44 (NAVD 88)

REGION NO.	STATE	PROJECT NO.	FISCAL YEAR	SHEET NO.	TOTAL SHEETS
7	KANSAS	087-N-0593-01	2015	25	153

PROTECTION CURB				
STA. TO STA. (BASELINE)	ROADWAY	SIDE	HEIGHT	LENGTH (ft.)
77+36.2 - 78+06.9	Meridian	Lt.	6"	70.7
78+18.9 - 78+57.1	Meridian	Lt.	6"	38.2
78+69.1 - 79+02.1	Meridian	Lt.	6"	33.0

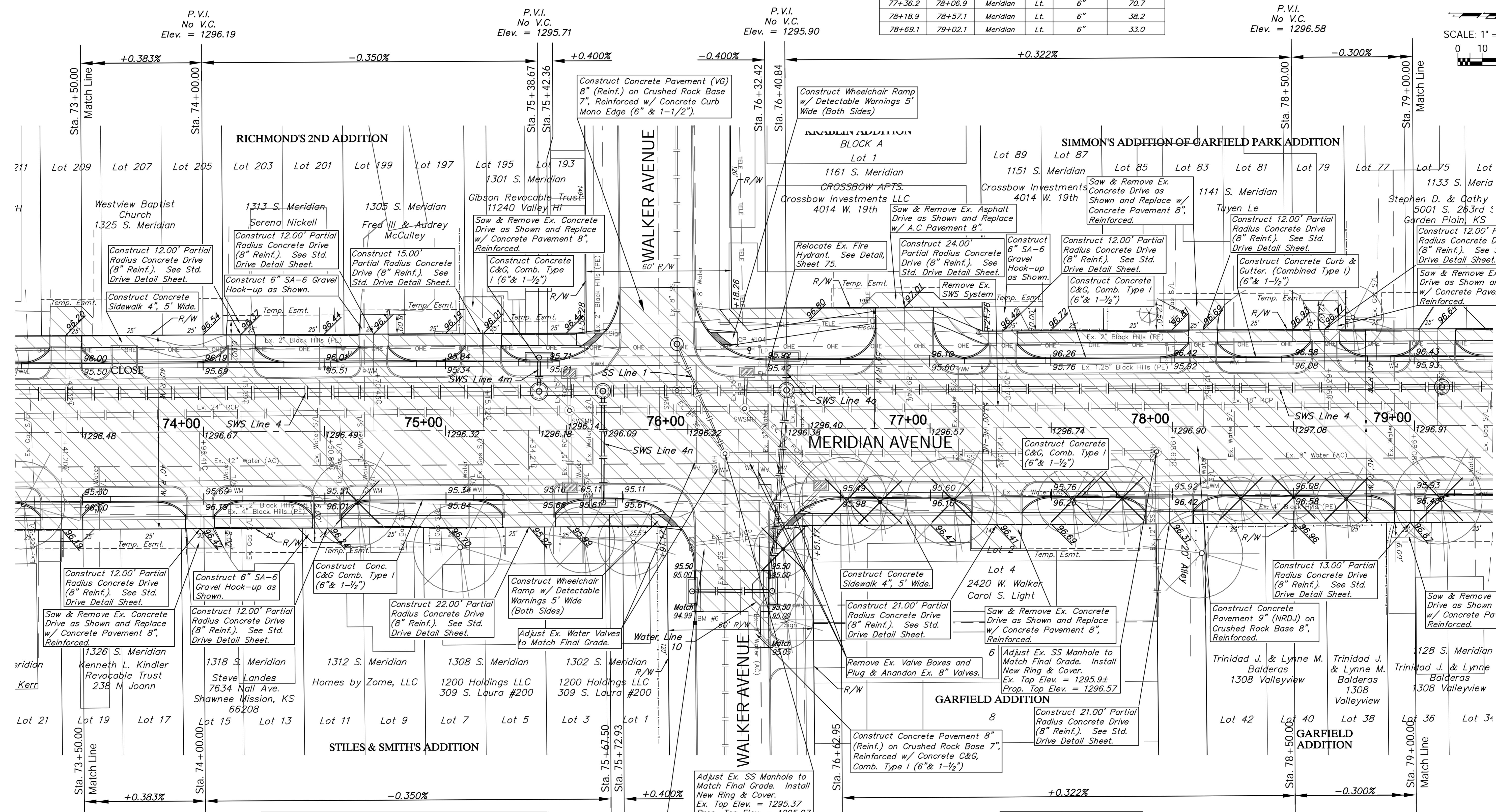
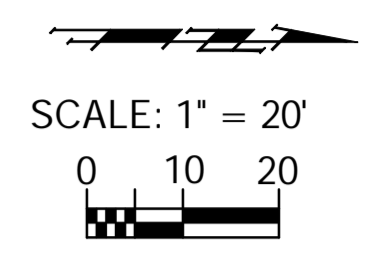

PROTECTION CURB				
STA. TO STA. (BASELINE)	ROADWAY	SIDE	HEIGHT	LENGTH (ft.)
74+04.4 - 74+44.9	Meridian	Rt.	6"	40.5
74+21.6 - 74+64.4	Meridian	Lt.	6"	42.8
74+56.9 - 74+90.0	Meridian	Rt.	6"	33.1
74+76.4 - 75+08.2	Meridian	Lt.	6"	31.8
75+23.2 - 75+54.2	Meridian	Lt.	6"	31.0

Construct Concrete Pavement (VG) 8" (Reinf.) on Crushed Rock Base 7", Reinforced w/ Concrete Curb Mono Edge (6" & 1-1/2").

The Existing 8" AC Water Line in Meridian Shall be Abandoned in Place from Walker to McCormick. See Details, Sheet 74.

Note:  
 Trees/Shrubs to be removed are marked thus:

Design: TPV  
 Drawn: STAFF  
 Approved: TPV  
 Scale: NOTED

Meridian Avenue Paving  
 Sta. 73+50.00 to Sta. 79+00.00