

BENCHMARKS:
 BM #3 - City of Wichita Benchmark Disc in the Southeast Corner
 of the Intersection of Meridian and Harry, 29.5' South
 and 61' East of the Centerline of Both.
 Elev. = 1294.17 (NAVD 88)

REGION NO.	STATE	PROJECT NO.	FISCAL YEAR	SHEET NO.	TOTAL SHEETS
7	KANSAS	087 N-0593-01	2015	30	153

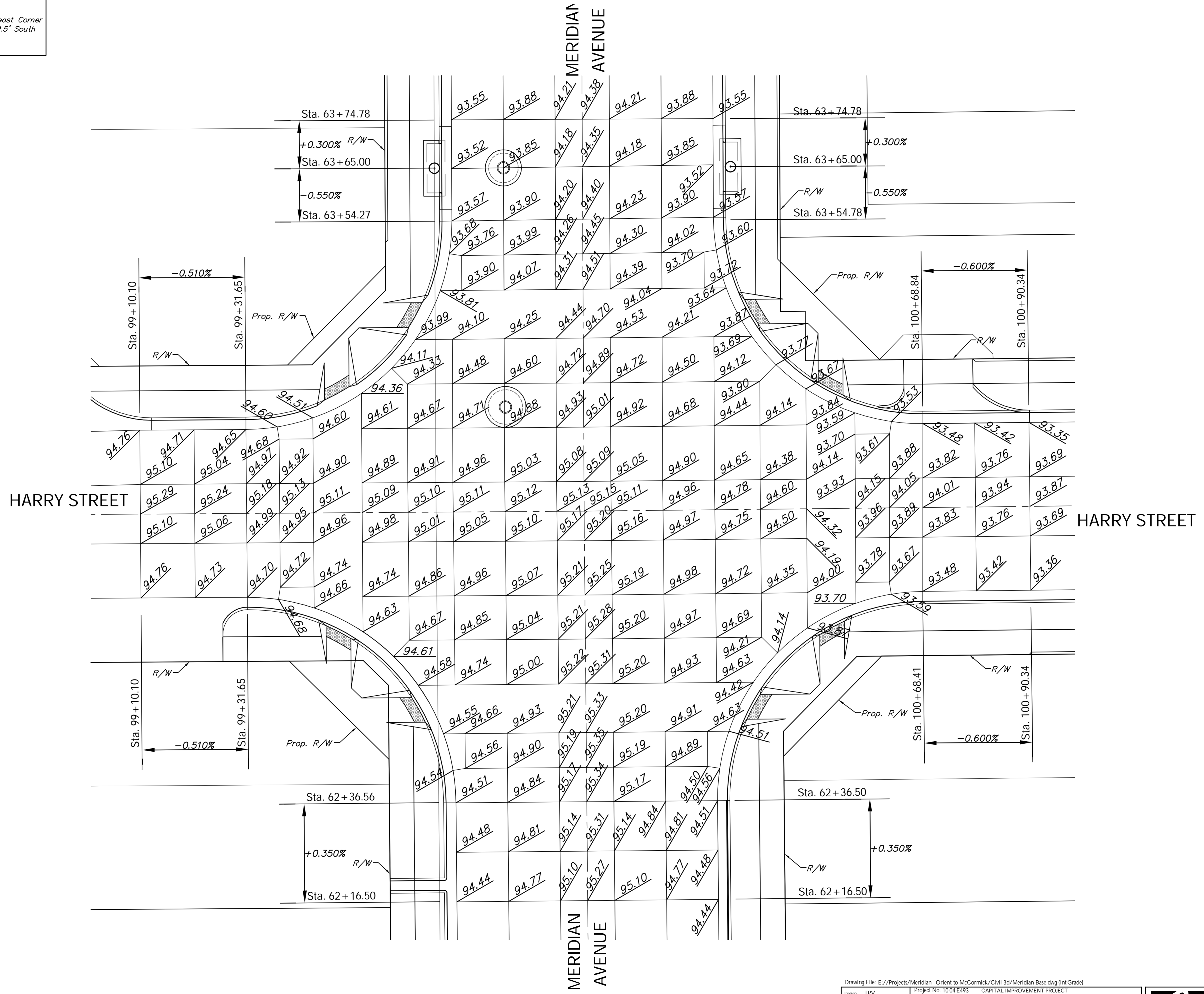
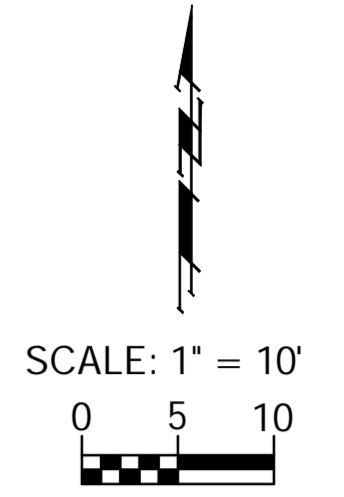

Drawing File: E://Projects/Meridian - Orient to McCormick/Civil 3d/Meridian Base.dwg (IntGrade)

Design: TPV
 Drawn: STAFF
 Approved: TPV
 Scale: NOTED

Project No: 1004E493 CAPITAL IMPROVEMENT PROJECT
MERIDIAN AVENUE & HARRY STREET
INTERSECTION GRADING PLAN
 MERIDIAN AVENUE - PAWNEE AVENUE TO MCCORMICK AVENUE

Baughman Company, P.A.
 315 Ellis St., Wichita, KS 67211 P 316-262-7271 F 316-262-0149
 ENGINEERING | SURVEYING | PLANNING | LANDSCAPE ARCHITECTURE

May 2015
 SHEET
30
 OF
153