

FWHA REGION NO.	STATE	PROJECT NO.	FISCAL YEAR	SHEET NO.	TOTAL SHEETS
7	KANSAS	087 N-0593-01	2015	111	153

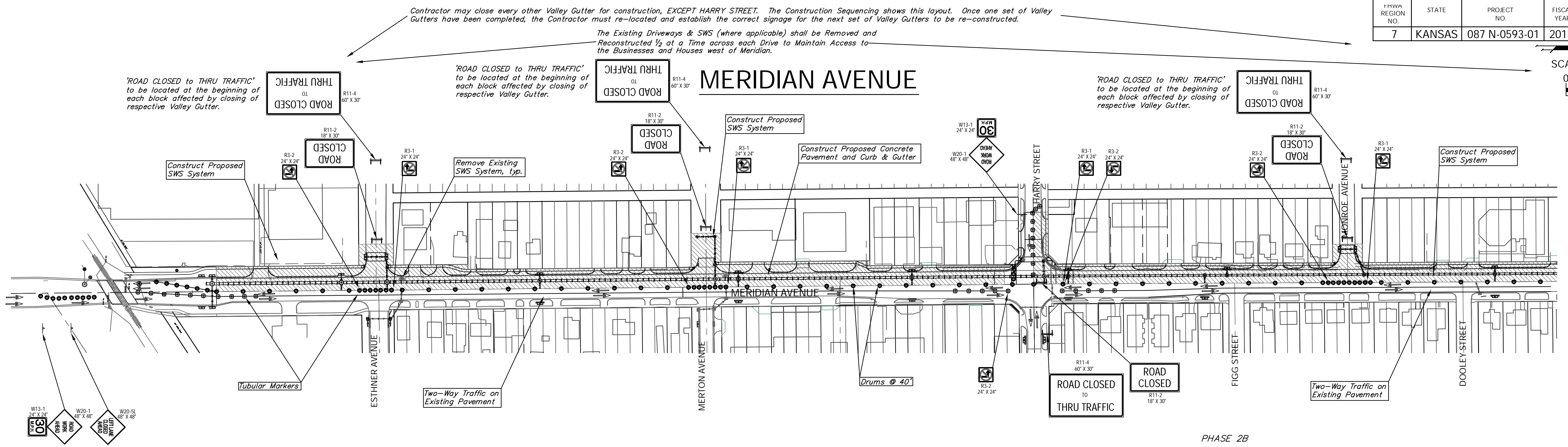

LEGEND

- Work Area
- Reflectorized Drum (40' Spacing)
- Tubular Marker (60' Spacing)
- Type III Barricade
- Traffic Flow Pattern

PHASE 2B

Continue constructing SWS system and new pavement on the west half of Meridian from South of Esthner to McCormick. Keep traffic on the east side of Meridian and construct the west half. Two-way traffic on Meridian is to be carried on existing pavement. Construct the Northwest Quadrant of Harry and Meridian Intersection.

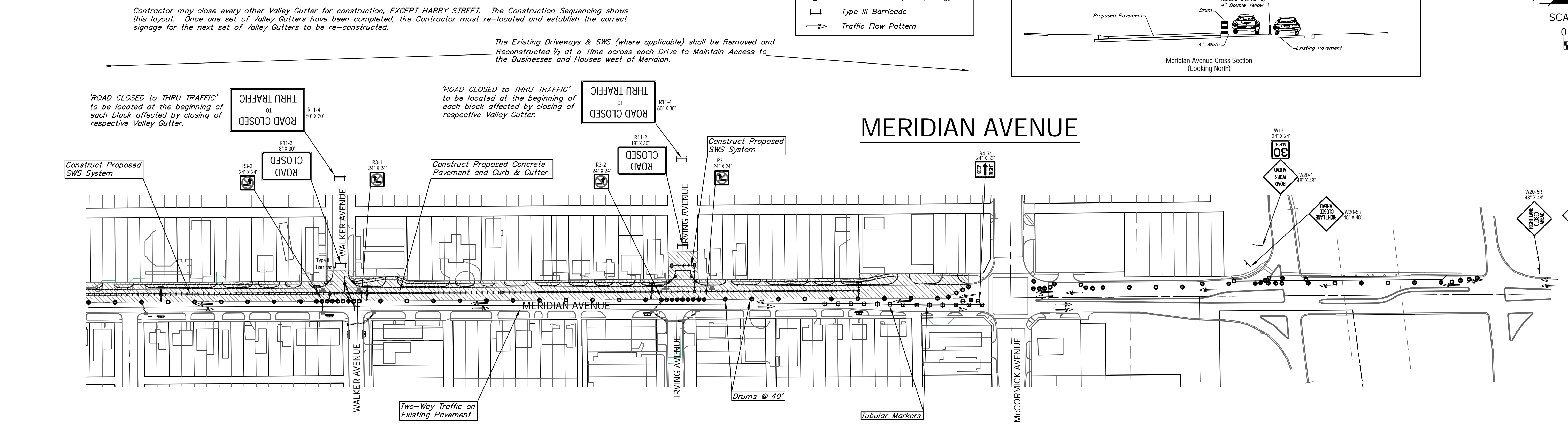
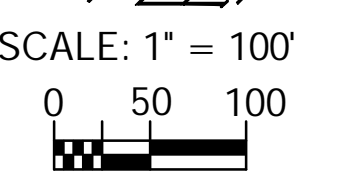
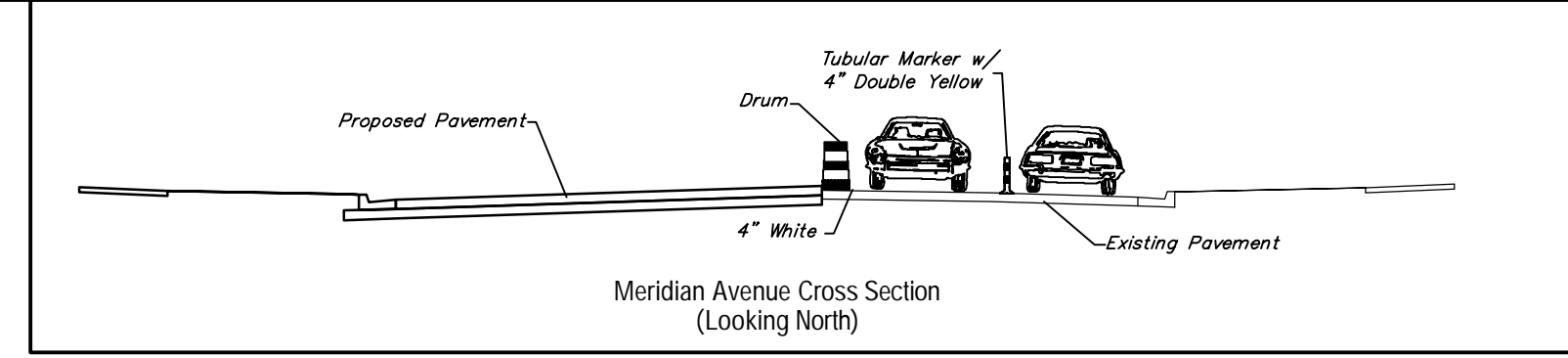

Drawing File: E:\Projects\Meridian - Orient to McCormick\Traffic\Meridian ConSeq.dwg (ConSeq 02)
 Design: TPV
 Drawn: STAFF
 Approved: TPV
 Scale: 1:100

Project No. 1004-E49 CAPITAL IMPROVEMENT PROJECT
MERIDIAN AVENUE CONSTRUCTION
SEQUENCE PLAN - PHASE 2B
 MERIDIAN AVENUE - ORIENT BOULEVARD TO MCCORMICK AVENUE

Baughman Company, P.A.
 315 Ellis St. Wichita, KS 67211 P 316.262.7271 F 316.262.0149
 ENGINEERING | SURVEYING | PLANNING | LANDSCAPE ARCHITECTURE

May 2015
 SHEET
111
 OF
153