

REGION NO.	STATE	PROJECT NO.	FISCAL YEAR	SHEET NO.	TOTAL SHEETS
7	KANSAS	087 N-0593-01	2015	116	153

Harry Street just east of Meridian Avenue will be closed to through traffic during portions of the construction. East-bound traffic on Harry shall be detoured at Meridian, north to McCormick, west to Seneca, and south to Harry. South-bound traffic on Meridian shall be detoured at McCormick, west to Southwest Boulevard or east to Seneca. North-bound traffic on Meridian shall be detoured at Pawnee, west to Southwest Boulevard or east to Seneca.

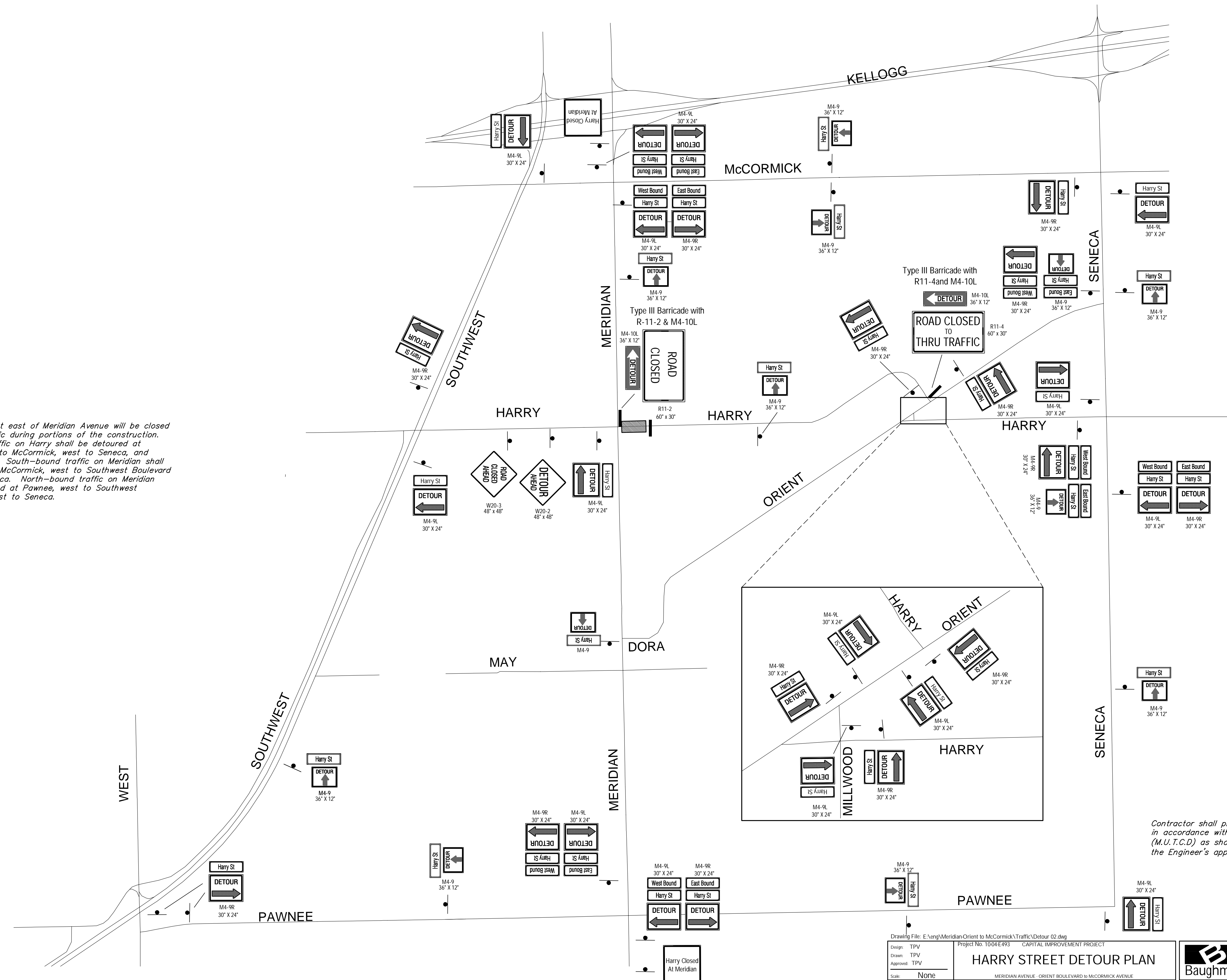

Contractor shall provide, erect, and maintain traffic control devices in accordance with the Manual on Uniform Traffic Control Devices (M.U.T.C.D.) as shown on the Traffic Control plans and subject to the Engineer's approval.

Design: TPV  
 Drawn: TPV  
 Approved: TPV  
 Scale: None

Project No. 1004-E493 CAPITAL IMPROVEMENT PROJECT  
**HARRY STREET DETOUR PLAN**  
 MERIDIAN AVENUE - ORIENT BOULEVARD TO MCCORMICK AVENUE

**Baughman Company, P.A.**  
 315 Ellis St. Wichita, KS 67211 P 316-262-7271 F 316-262-0149  
 ENGINEERING | SURVEYING | PLANNING | LANDSCAPE ARCHITECTURE

May 2015  
 SHEET 116  
 OF 153