

PLOTTED: Wednesday, November 18, 2015 @ 12:39PM  
J:\PROJECTS\2014\14010482\_PREMER\_ESTANCIA\5-CIVIL\CAD\GRD\14482\_GRADING.DWG

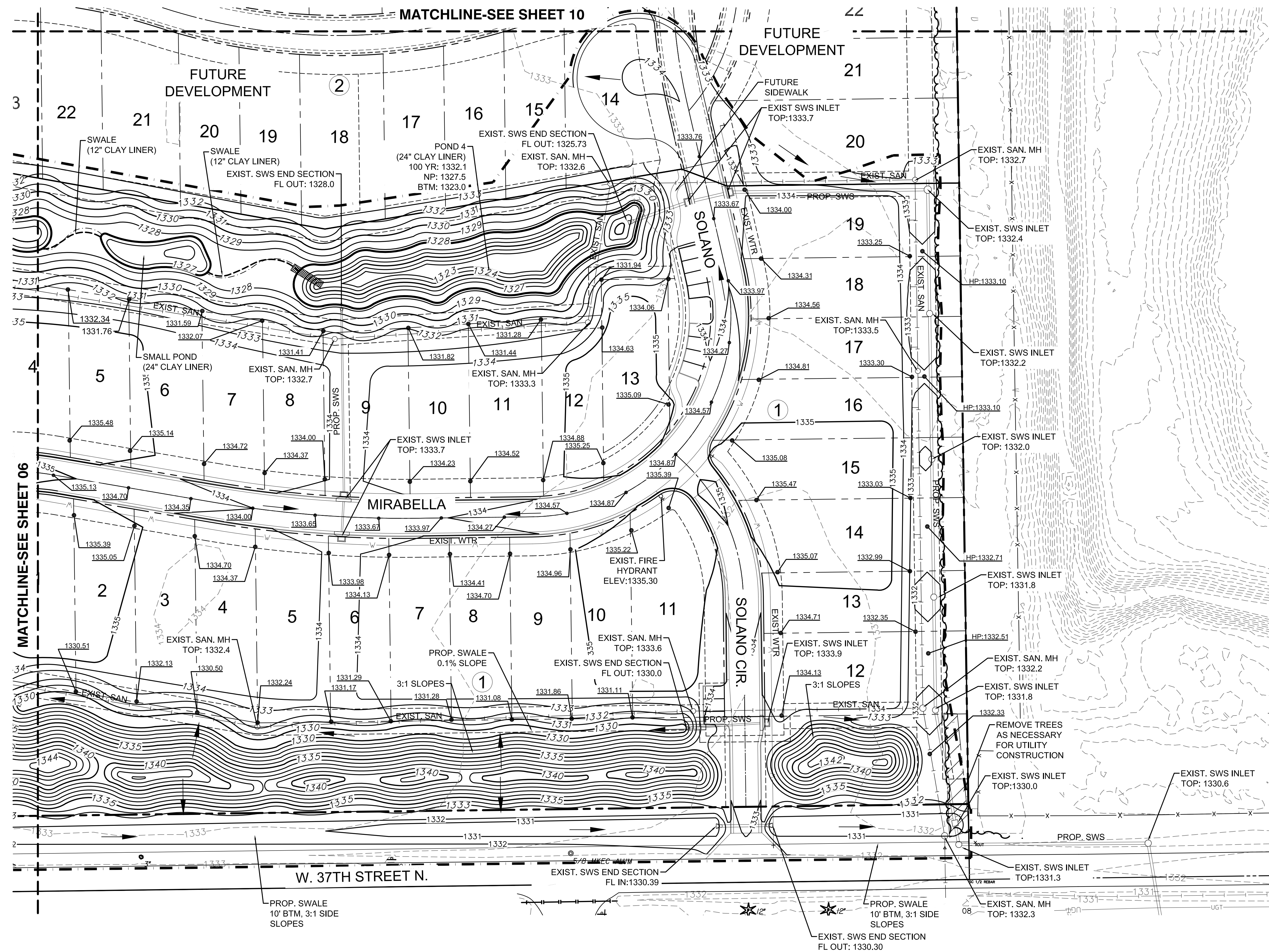

**LEGEND**

- 1250--- EXISTING CONTOUR
- 1250— PROPOSED CONTOUR
- W — WATER LINE
- PROP. STORMWATER SEWER
- EXISTING SANITARY SEWER
- EXISTING STORMWATER SEWER
- UGT — EXISTING UNDERGROUND TELEPHONE
- UGE — EXISTING UNDERGROUND ELECTRICAL
- OHE — EXISTING OVERHEAD ELECTRICAL
- — — LIMITS OF GRADING
- — — SWALE
- 1329.86 SPOT ELEVATIONS
- ▨ TREE REMOVAL
- ▩ RIP-RAP

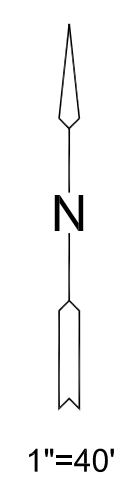

**NOTES:**  
VERTICAL DATUM USED IS NAVD88.  
ALL GRADING IS TO FINISHED GRADED.  
CONTRACTOR SHALL OVER EXCAVATE ROADS TO TOP OF SUBGRADE. REFER TO ROAD CROSS SECTION DETAIL, SEE SHEET 11.

©2015 MKEC Engineering All Rights Reserved  
www.mkec.com  
These drawings and their contents, including, but not limited to, all concepts, designs, & ideas are the exclusive property of MKEC Engineering (MKEC), and may not be used or reproduced in any way without the express consent of MKEC.

**GRADING PLAN**

PROJECT NO.	468-85070	
DATE	NOV. 2015	
SCALE	1"=40'	
DESIGNED	DRAWN	CHECKED
MLP	MLP	GJA
NO.	REVISION	DATE

GREGORY J. ALLIUM  
LICENSED PROFESSIONAL ENGINEER  
KANSAS  
11159  
11/18/15