

PLAN	CHECKED	DATE
	CHECKED	

PROFILE	CHECKED	DATE
	CHECKED	

SHEET 10-30-2015 12:29:46 PM BY BET
 Plot Scale 1:1 11-02-2015 9:06:30 AM BY BET
 U:\Wichita-Civil\2015\15120\001\Wm\Drawings\15120-001-10C-RCB LAYOUT

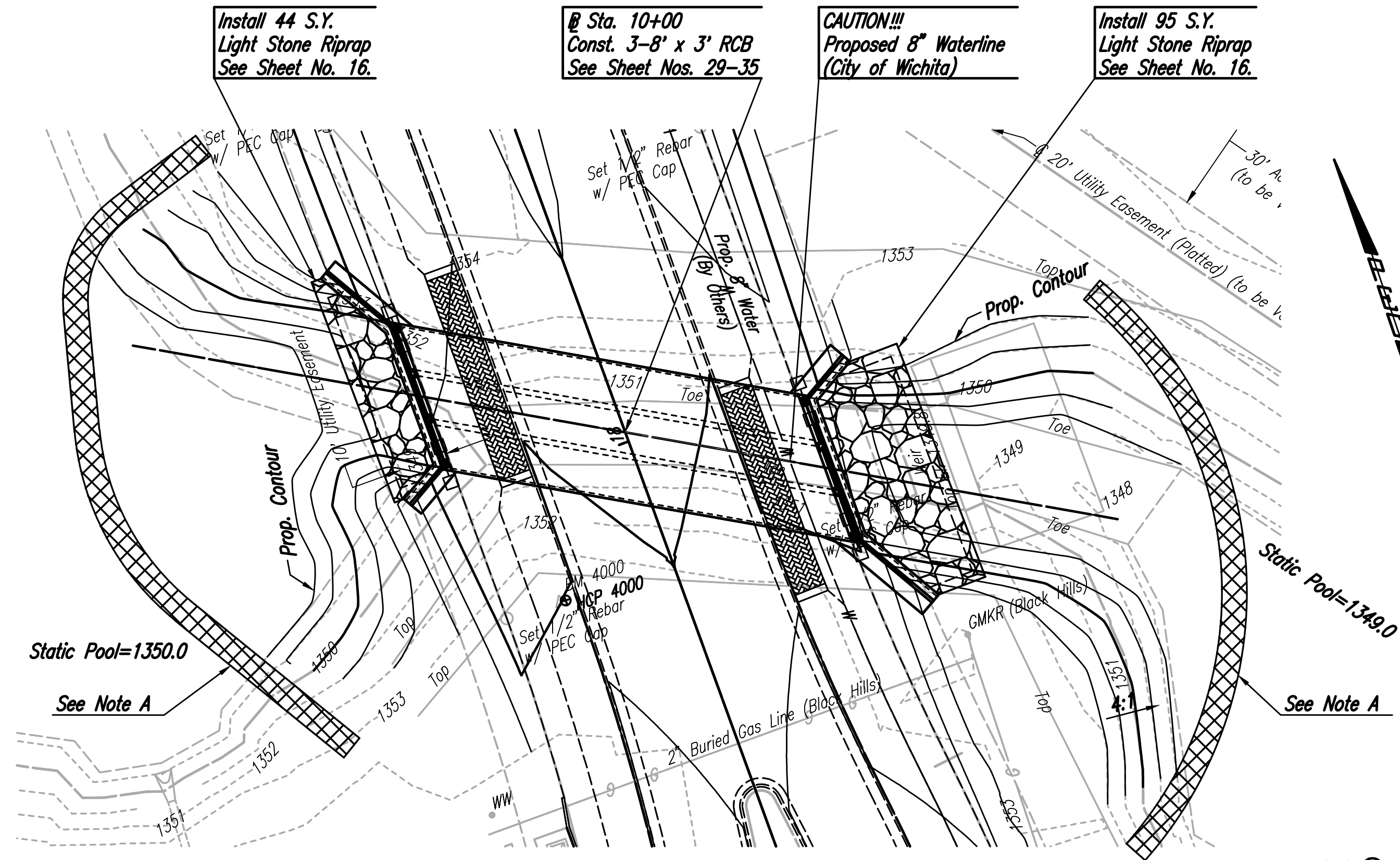

WEST 3'-8" X 3' RCB

Note (A): Construct Suitable Cofferdam and/or Dewater as Necessary to Construct RCB. Cofferdam may be of Compacted Earth Material or Sheet Piles. Upon Completion of Drainage Improvements, Remove Cofferdam and Restore Pond Banks to Pre-Construction Condition. This work shall be Subsidiary to RCB.

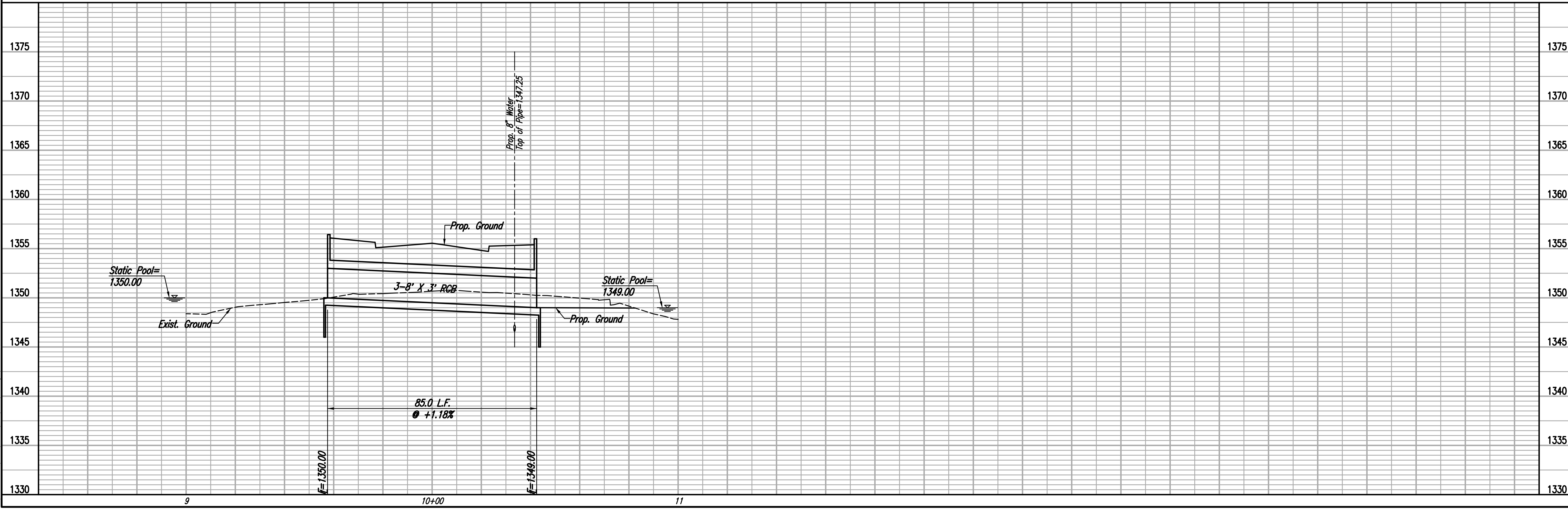
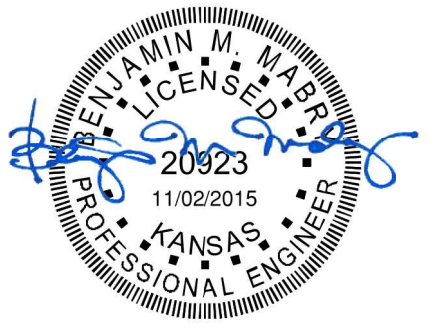
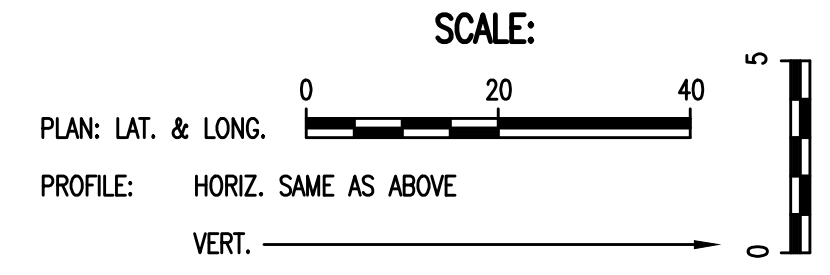

NEWMARKET OFFICE 2ND-PHASE 2 PAVING AND INCIDENTAL DRAINAGE IMPROVEMENTS

RCB LAYOUT

PROFESSIONAL ENGINEERING CONSULTANTS, P.A.
 303 SOUTH TOPEKA WICHITA, KS 67202
 316-262-2881 www.pec1.com

PEC

Designed By: BMM, TBK
 Drawn By: BJS

Job No.: 35-15120-001
 Date: November 2015

GARY JANZEN, P.E. - CITY ENGINEER
 CITY OF WICHITA, PROJECT NO. 472-84991

SHEET 10 OF 36