

C CURVE DATA						
A=14°50'35" L D=11° 27' 33" R=500.00' L=129.53' T=65.13' F=4.22'						
CURVE DATA BASED ON C radius A/2=7' 25" 17.5'						
C STATION	C ARC LENGTH	FACE CURB LENGTH LEFT CURB	FACE CURB LENGTH RIGHT CURB	CHORD LENGTH 8' OFF LEFT FACE CURB	CHORD LENGTH 8' OFF RIGHT FACE CURB	DEFLECTION ANGLE
18+80.30						0°00'00.0"
19+00.00	19.70'	18.91'	20.49'	18.60'	20.80'	01°07'43.4"
19+10.00	10.00'	9.60'	10.40'	9.44'	10.56'	00°34'22.6"
19+15.00	5.00'	4.80'	5.20'	4.72'	5.28'	00°17'11.3"
19+25.00	10.00'	9.60'	10.40'	9.44'	10.56'	00°34'22.6"
19+50.00	25.00'	24.00'	26.00'	23.60'	26.40'	01°25'56.6"
19+55.32	5.32'	5.11'	5.53'	5.02'	5.62'	00°18'17.3"
19+75.00	19.68'	18.89'	20.47'	18.58'	20.78'	01°07'39.3"
19+85.00	10.00'	9.60'	10.40'	9.44'	10.56'	00°34'22.6"
20+00.00	15.00'	14.40'	15.60'	14.16'	15.84'	00°51'34.0"
20+09.83	9.83'	9.44'	10.22'	9.28'	10.38'	00°33'47.8"
TOTAL	129.53'	124.35'	134.71'			07°25'17.5"

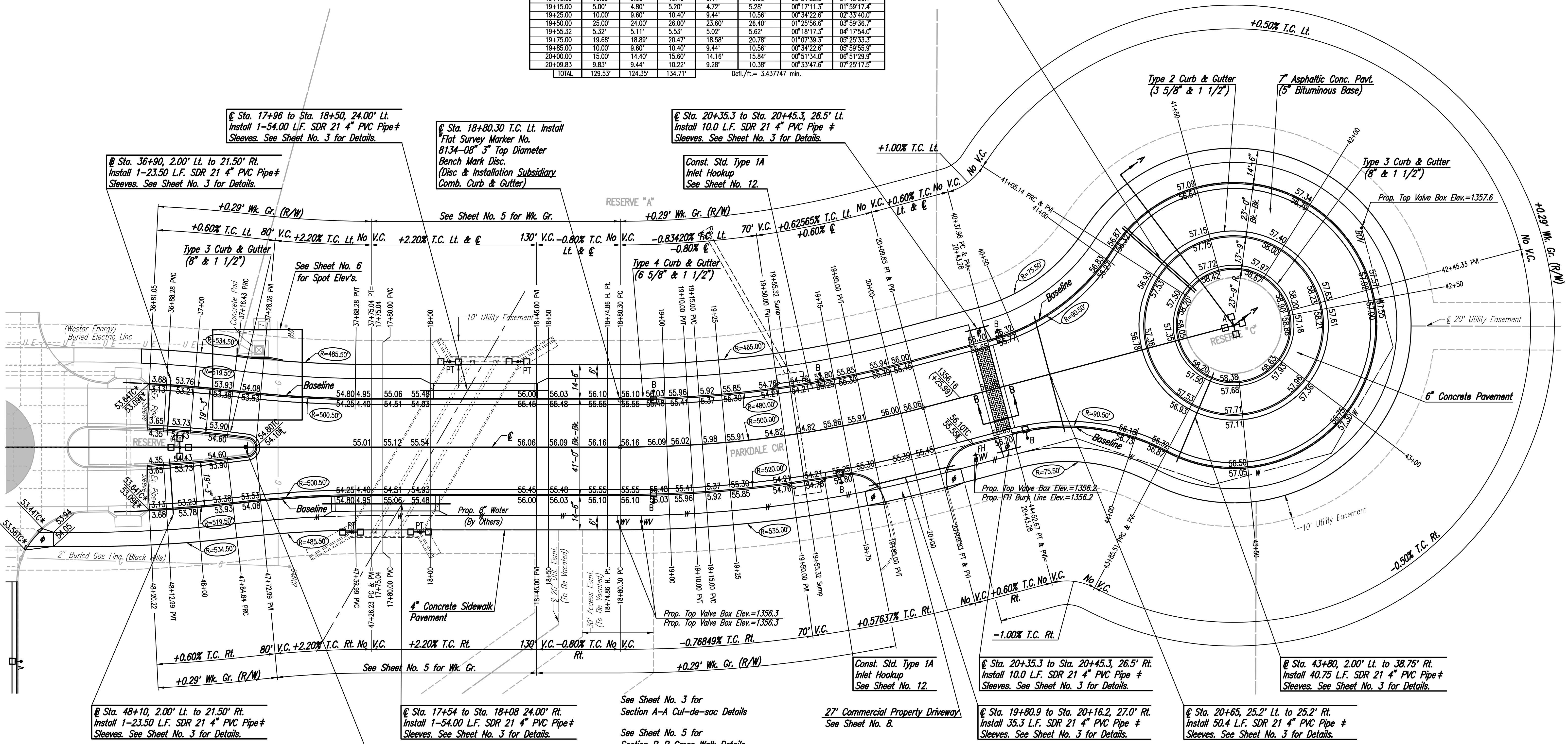
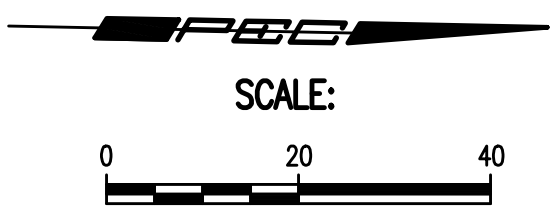

@ Sta. 17+96 to Sta. 18+50, 24.00' Lt. Install 1-54.00 L.F. SDR 21 4" PVC Pipe # Sleeves. See Sheet No. 3 for Details.

@ Sta. 18+80.30 T.C. Lt. Install Flat Survey Marker No. 8134-08 3" Top Diameter Bench Mark Disc. (Disc & Installation Subsidiary Comb. Curb & Gutter)

@ Sta. 20+35.3 to Sta. 20+45.3, 26.5' Lt. Install 10.0 L.F. SDR 21 4" PVC Pipe # Sleeves. See Sheet No. 3 for Details.

@ Sta. 41+15, 2.00' Lt. to 38.75' Rt. Install 2-40.75 L.F. SDR 21 4" PVC Pipe # Sleeves. See Sheet No. 3 for Details.

@ Sta. 36+90, 2.00' Lt. to 21.50' Rt. Install 1-23.50 L.F. SDR 21 4" PVC Pipe # Sleeves. See Sheet No. 3 for Details.

Const. Std. Type 1A Inlet Hookup See Sheet No. 12.

@ Sta. 48+10, 2.00' Lt. to 21.50' Rt. Install 1-23.50 L.F. SDR 21 4" PVC Pipe # Sleeves. See Sheet No. 3 for Details.

@ Sta. 17+54 to Sta. 18+08 24.00' Rt. Install 1-54.00 L.F. SDR 21 4" PVC Pipe # Sleeves. See Sheet No. 3 for Details.

@ Sta. 20+35.3 to Sta. 20+45.3, 26.5' Lt. Install 10.0 L.F. SDR 21 4" PVC Pipe # Sleeves. See Sheet No. 3 for Details.

@ Sta. 43+80, 2.00' Lt. to 38.75' Rt. Install 40.75 L.F. SDR 21 4" PVC Pipe # Sleeves. See Sheet No. 3 for Details.

- * Match Existing
- Construct Std. Wheelchair Ramp, See Sheet No. 9.
- Sleeves to be 42" below top of curb. Each end of 4" PVC pipe sleeves shall be capped and marked with steel "T" posts or 2" dia. steel pipe a maximum of 12" above finished grade. Pipe, caps, markers, and installation thereof shall be paid for at the unit price bid per linear foot "irrigation Sleeves".

NOTE: PORTION OF THE ROUNDABOUT TO BE CONSTRUCTED WITH TYPE 2 (ROLL-TYPE CURB). TOP OF CURB ELEVATIONS GIVEN ARE FOR FULL HEIGHT CURB.

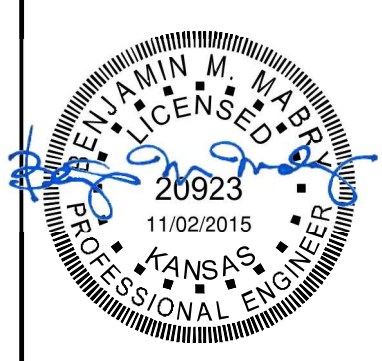

Revision		By		Date	
NEWMARKET OFFICE 2ND-PHASE 2 PAVING AND INCIDENTAL DRAINAGE IMPROVEMENTS					
PAVING PLAN-PARKDALE CIRCLE					
GARY JANZEN, P.E. - CITY ENGINEER CITY OF WICHITA PROJECT NO. 472-84991					
PROFESSIONAL ENGINEERING CONSULTANTS, P.A. 303 SOUTH TOPEKA WICHITA, KS 67202 316-262-2691 www.pec1.com					
Designed by	BMM, TBK	Job No.	35-15120-001	Sht. 04 of 36	
Drawn by	BJS	Date	November 2015		

Sowed 10-29-2015 12:46:24 PM by RET
 Plot Scale 1:1 11-02-2015 9:55:19 AM by RET
 U:\Wichita-Civil\2015\15120\001\Drawings\15120-001-04C-PAVING PLAN-PARKDALE CIRCLE