

GENERAL NOTES

1. CONTRACTOR SHALL INSTALL AND MAINTAIN EROSION PROTECTION THROUGHOUT THE ENTIRE PROJECT. THE FOLLOWING QUANTITIES ARE FOR INFORMATION ONLY, AND SHALL BE INCLUDED IN THE EROSION CONTROL LUMP SUM BID ITEMS FOR EACH RESPECTIVE PART. EROSION PROTECTION SHALL BE INCLUDED IN THE BID AS FOLLOWS:

SANITARY SEWER (468-84752)	
SILT FENCE BARRIER	535 L.F.
WATER LINE (448-90524)	
STABILIZED CONSTRUCTION ENTRANCE	1 EACH
PAVING AND DRAINAGE (472-84991)	
CURB INLET PROTECTION	5 EACH
BACK OF CURB PROTECTION	1,010 L.F.
ACCESS DRIVE (472-85225)	
BACK OF CURB PROTECTION	333 L.F.

- THE EROSION CONTROL DEVICES SHOWN ON THIS SHEET ARE CONSIDERED MINIMUM STANDARDS. WHENEVER SEDIMENT ENTERS THE STREETS, STORM SEWERS, DITCHES, OR PONDS, CONTRACTOR WILL INSTALL ADDITIONAL DEVICES, AS NEEDED, TO CORRECT THE PROBLEM.
- THE EROSION CONTROL DEVICES SHOWN HEREON MUST BE IN PLACE AT ALL TIMES DURING CONSTRUCTION UNTIL SUCH TIME AS THE SITE IS REESTABLISHED WITH PAVING OR GRASS. TEMPORARY OR PERMANENT SEEDING AND MULCH WILL BE INSTALLED WHEN EARTHWORK ACTIVITIES CEASE IN AN AREA FOR 14 DAYS OR MORE.
- ANY MUD INADVERTENTLY TRACKED ONTO ANY STREET SHALL BE CLEANED UP BY THE CONTRACTOR, AT THE END OF EACH DAY'S WORK, OR AS DIRECTED BY THE FIELD ENGINEER.
- CONTRACTOR TO FURNISH A TRUCK WASH-OUT PIT TO BE PLACED AT A CONVENIENT LOCATION THAT DOES NOT CONFLICT WITH CONSTRUCTION. CONTRACTOR SHALL CLEAN OUT AND BACKFILL PIT PRIOR TO FINAL INSPECTION. LOCATION SHALL BE APPROVED BY THE FIELD ENGINEER.

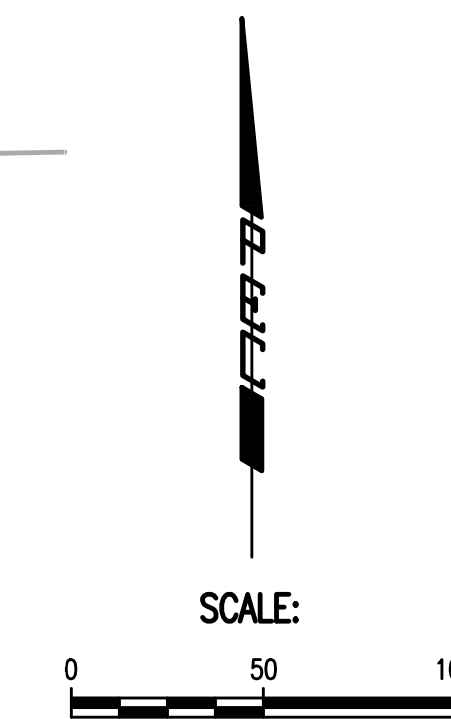

LEGEND

	SILT FENCE (TO BE BID WITH SANITARY SEWER PROJECT)
	STABILIZED CONSTRUCTION ENTRANCE (TO BID WITH WATER LINE PROJECT)
	BACK OF CURB PROTECTION-PARKDALE CIRCLE
	BACK OF CURB PROTECTION-ACCESS DRIVE
	PROPOSED CURB INLET PROTECTION
	PROPOSED WATER MAIN
	PROPOSED SANITARY SEWER w/MANHOLE
	PROPOSED STORM WATER SEWER

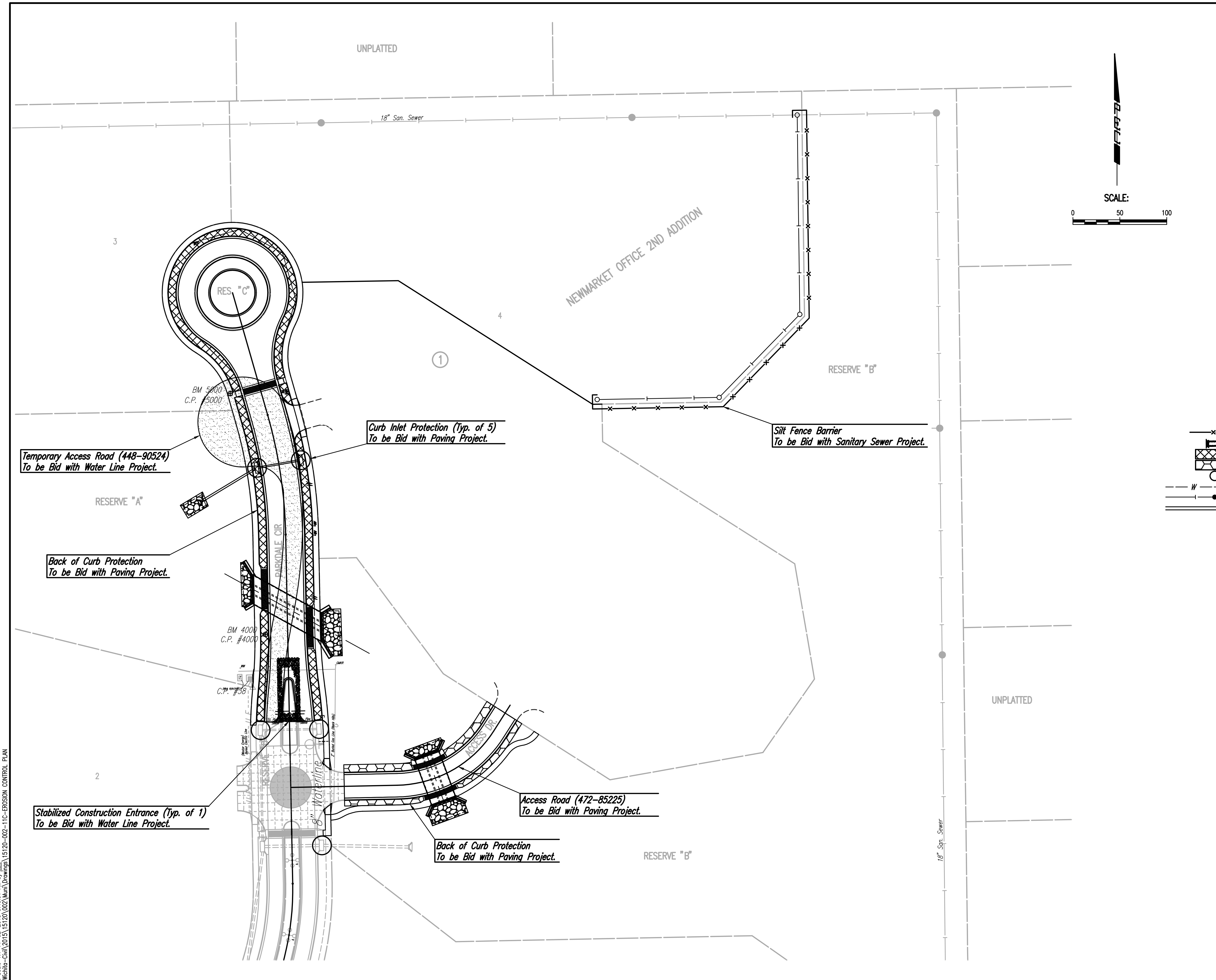

Served 10-05-2015 12:46:09 PM by BJS
 Plot Scale 1:1 11-02-2015 9:40:01 AM by RET
 U:\Wichita-Civil\2015\15120\002\Drawings\15120-002-11C-EROSION CONTROL PLAN

No.	Revision	By	Date
NEWMARKET OFFICE 2ND-ACCESS DRIVE PAVING AND INCIDENTAL DRAINAGE IMPROVEMENTS EROSION CONTROL PLAN GARY JANZEN, P.E. - CITY ENGINEER CITY OF WICHITA PROJECT NO. 472-85225			
Designed by	BMM, TBK	Job No.	35-15120-002
Drawn by	BJS	Date	November 2015
			Sht. 11 of 25