

ELM AND ELDER PAVING STREET & SWS IMPROVEMENTS

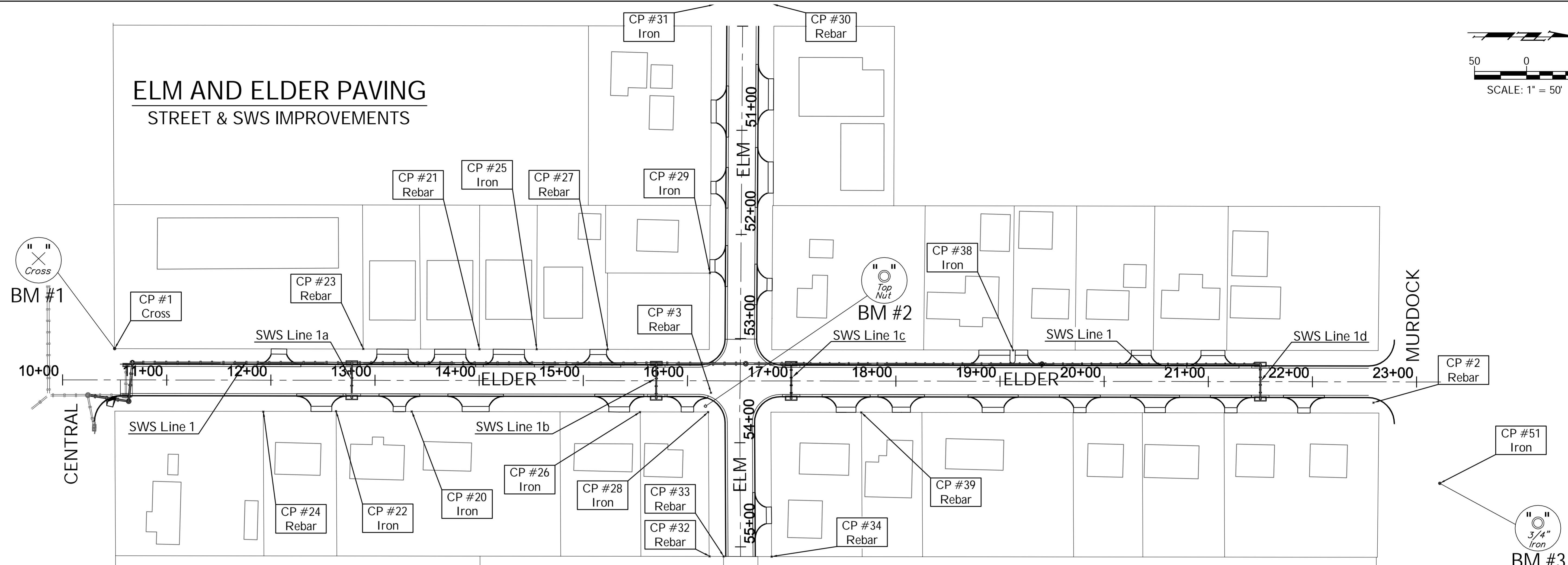
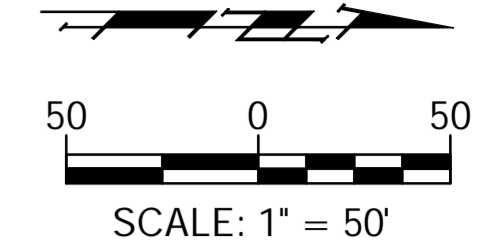

BENCHMARKS:

- BM #1 - Chiseled "X" in the Back of the Sidewalk at the Block Corner at the Northwest Corner of the Central and Elder Intersection
Elev. = 1311.95 (NAVD 88)
- BM #2 - Top Nut on the Fire Hydrant at the Southeast Corner of the Elder and Elm Intersection
Elev. = 1314.60 (NAVD 88)
- BM #3 - Top of the 3/4" Iron Pipe at the Property Corner at the Northeast Corner of the Elder and Murdock Intersection
Elev. = 1312.19 (NAVD 88)

CONTROL POINTS

Point #	Northing	Easting	Description	Roadway	Station	Offset	Elevation
1	1688540.14	1629144.11	Cross	Elder	10+49.82	30.00' Lt.	1311.95
2	1689749.90	1629164.30	Rebar #4	Elder	22+58.70	19.99' Rt.	1312.01
3	1689113.68	1629171.44	Rebar #4	Elder	16+22.51	11.45' Rt.	1312.08
20	1688826.97	1629196.97	1/2" Iron (Pinch)	Elder	13+35.26	29.91' Rt.	1311.98
21	1688890.43	1629135.49	Rebar #4	Elder	14+00.21	29.99' Lt.	1312.18
22	1688754.35	1629198.61	1/2" Iron (Pinch)	Elder	12+62.62	29.76' Rt.	1311.81
23	1688778.92	1629138.15	Rebar #5	Elder	12+88.67	30.07' Lt.	1312.03
24	1688684.49	1629200.91	Rebar #4	Elder	11+92.72	30.34' Rt.	1312.00
25	1688945.41	1629134.09	3/4" Iron	Elder	14+55.20	30.03' Lt.	1311.46
26	1689046.04	1629191.84	1/2" Iron	Elder	15+54.38	30.18' Rt.	1312.20
27	1689013.50	1629132.43	Rebar #5	Elder	15+23.32	30.02' Lt.	1312.21
28	1689111.56	1629190.06	1/2" Iron	Elder	16+19.93	30.01' Rt.	1311.61
29	1689109.73	1629056.54	1/2" Iron	Elm	52+36.74	29.16' Rt.	1311.43
30	1689164.01	1628758.03	Rebar #5	Elm	---	---	1311.89
31	1689103.43	1628759.37	1/2" Iron	Elm	---	---	1312.36
32	1689116.50	1629328.54	Rebar #4	Elm	55+08.83	29.70' Rt.	1312.09
33	1689129.95	1629328.20	Rebar #5	Elm	55+08.92	16.24' Rt.	1312.42
34	1689176.10	1629327.24	Rebar #4	Elm	55+09.41	29.92' Lt.	1312.24
38	1689402.67	1629123.08	1/2" Iron	Elder	19+12.60	29.77' Lt.	1311.60
39	1689258.44	1629186.61	Rebar #4	Elder	17+66.85	30.18' Rt.	1311.60
51	1689815.50	1629240.08	3/4" Iron	Elder	---	---	1312.19

Drawing File: E:\Projects\Elm & Elder\Civil 3d\Base Map
 Design: TPV
 Drawn: LP
 Approved: TPV
 Scale: Noted

Project No. 15-07-E267 CAPITAL IMPROVEMENT PROJECT

KEYSHEET

ELM AND ELDER PAVING PROJECT

Baughman Company, P.A.
 315 Ellis St. Wichita, KS 67211 P 316-262-7271 F 316-262-0149
 ENGINEERING | SURVEYING | PLANNING | LANDSCAPE ARCHITECTURE