

BENCHMARKS:
 BM #1 Square cut in top of curb adjacent to the SE corner of Lot 2, Block B, The Woods Addition
 Elev. = 1381.25 NGVD29

BM #2 Square cut in top of curb NW end of median, Reserve "F" The Woods Addition
 Elev. = 1385.54 NGVD29

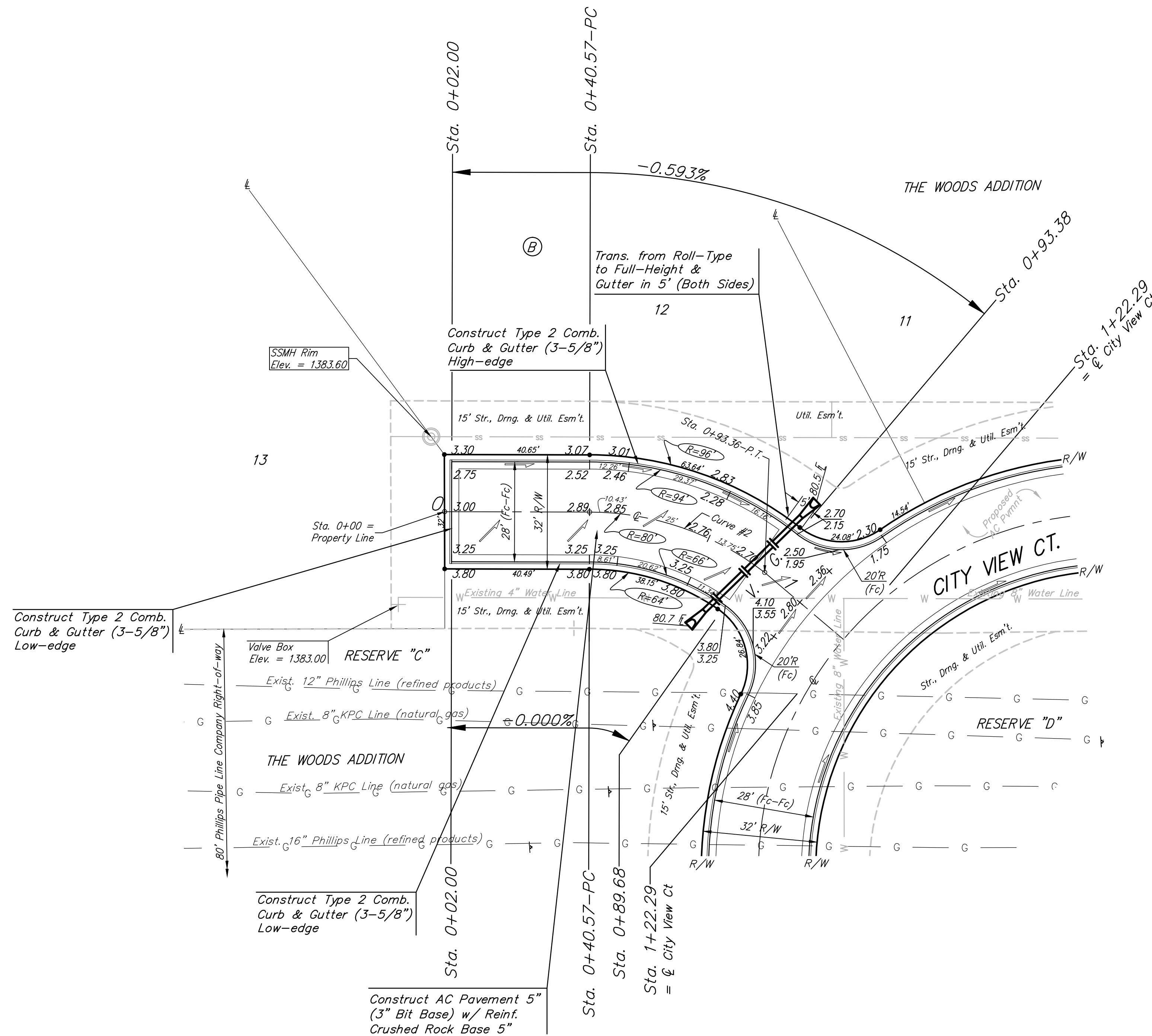
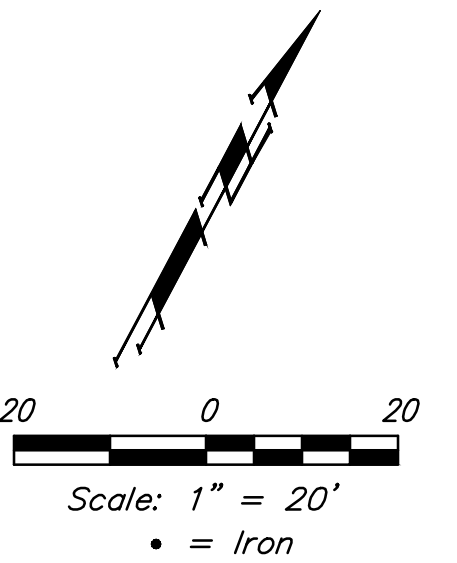

Curve #2

Curve Data Based on Centerline
 Rad. = 80' Delta = 37°45'19" Tangent = 27.39'
 Arc = 52.79' L.C. = 51.83' Def./Ft. = 21.48434 Min.

Station	Arc	Face Chord Lengths		Defl.	Total Defl.
		8' Left	8' Right		
0+40.57	-	-	-	0'00"00"	0'00"00"
0+50.00	9.43'	12.02'	6.83'	3'22"36"	3'22"36"
0+75.00	25.00'	31.74'	18.05'	8'57"06"	12'19"42"
0+89.68	14.68'	18.69'	10.63'	5'15"24"	17'35"06"
0+93.36	3.68'	4.69'	2.67'	1'19"03"	18'54"09"

Roll type curb & gutter to be constructed on the pavement on this sheet.
 Top of curb elevation are given for full height curb.



	The Woods Addition - Phase III	
	CITY VIEW CT	
Sta. 0+02.00 to Sta. 1+21.29		
Baughman Company, P.A. 315 Ellis St. Wichita, KS 67211 P 316-262-7271 F 316-262-0149 ENGINEERING SURVEYING PLANNING LANDSCAPE ARCHITECTURE		
PROJECT NUMBER 472-84361	DESIGN AEG	DRAWN JAK
REVISIONS:	APPROVED	DATE 2/18/16
	SCALE Noted	SHEET
		8 OF 21