

CONSULTANTS:

SILVER FOX STREET & MAIZE ROAD  
 TRAFFIC SIGNALIZATION



REVISIONS:	MARK	DATE	DESCRIPTION

PROJ NO: P125100009  
 SCALE: 1" = 20'  
 DATE: 2/17/2016  
 DESIGNED BY: CCB  
 DRAWN BY: CCB  
 CHECKED BY: SGE

SHEET TITLE:  
**TRAFFIC SIGNAL**

SHEET NO.  
**3**  
 SHEET 3 OF 30

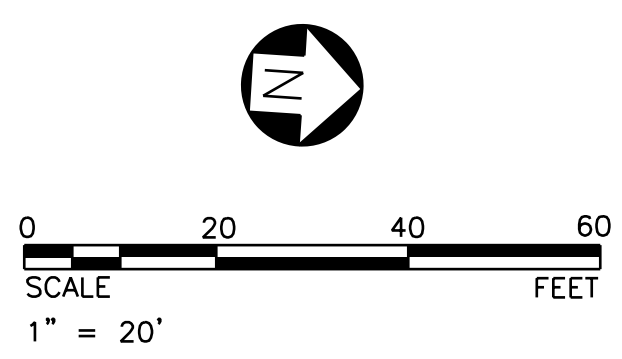

SERVICE BOX LOCATIONS		
BOX NO.	STATION	OFFSET
1	105+14.00	13.00' LT
2	106+35.00	21.00' LT
3	106+25.00	79.00' RT
4	105+25.00	84.00' RT

SIGN LOCATIONS		
SIGN TYPE	POLE NO.	SPACING ON ARM
RI0-12	1	37.5'
STREET NAME	1	11.0'
STREET NAME	2	12.0'
STREET NAME	3	22.5'

POLE & CONTROLLER LOCATIONS			
POLE NO.	STATION	OFFSET	FOOTING TYPE
1	105+19.50	16.50' LT	A
2	106+30.00	23.50' LT	A
3	106+40.00	77.00' RT	A
4	105+31.00	86.20' RT	B
5	106+20.00	84.50' RT	A
*CONT.	105+00.00	102.00' RT	-

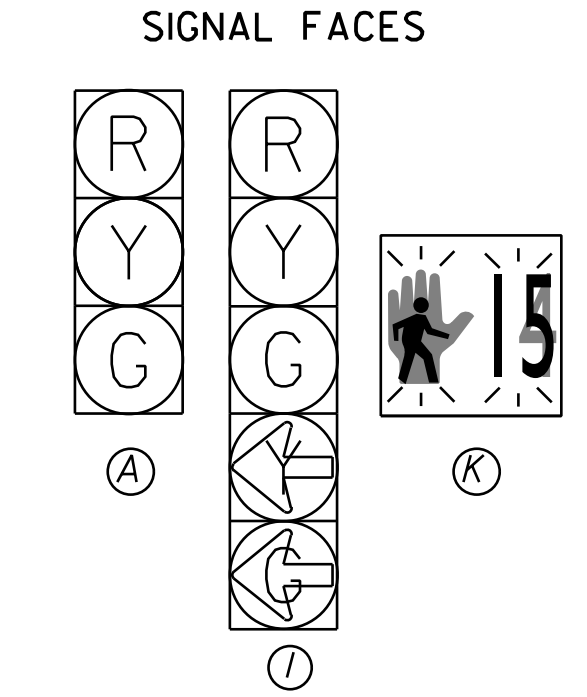
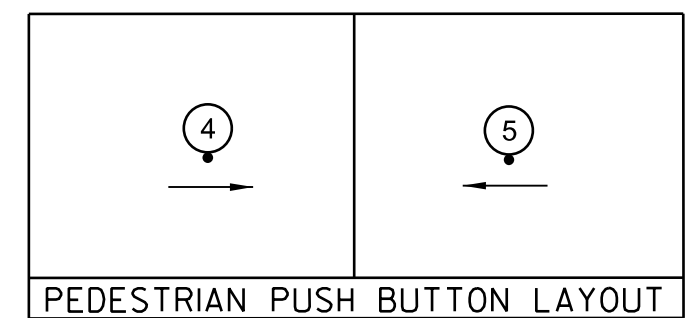

NOTE: ALL TRAFFIC LENSES SHALL BE 12". PEDESTRIAN LENSES SHALL BE 16" AND BE COUNTDOWN SIGNALS.

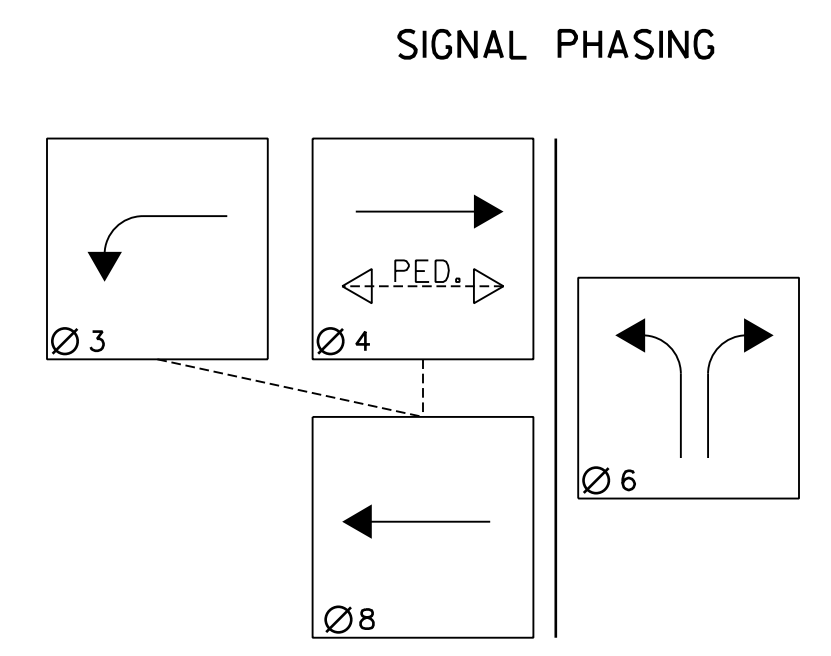

----- INDICATES NON-CONFLICTING PHASES THAT MAY TIME CONCURRENTLY. PEDESTRIAN INTERVALS TO ONLY OCCUR AFTER PUSHBUTTON ACTIVATION.

LEGEND	
	METAL TRAFFIC SIGNAL POLE
	PEDESTRIAN SIGNAL INDICATION
	TRAFFIC SIGNAL INDICATION
	TRAFFIC SIGNAL WITH BACKPLATE
	MAST ARM SUSPENDED TRAFFIC SIGNAL
	SERVICE BOX
	CONDUIT (TRENCHED)
	CONDUIT (BORED)
	CONTROLLER AND CABINET (PAD MOUNTED)
	SECONDARY SERVICE POINT
	DETECTOR NUMBER
	VIDEO DETECTION ZONE
	PROPOSED LUMINAIRE
	P.B. PEDESTRIAN PUSH BUTTON
	POLE NUMBER
	SIGN (LARGE)
	SIGN (SMALL)
	VIDEO DETECTION CAMERA
	SERVICE BOX NUMBER
	FUTURE TRAFFIC SIGNAL INDICATION
	FUTURE TRAFFIC SIGNAL WITH BACKPLATE
	FUTURE MAST ARM SUSPENDED TRAFFIC SIGNAL
	FUTURE SIGN (LARGE)
	FUTURE SIGN (SMALL)
	FUTURE VIDEO DETECTION CAMERA
	EXISTING STREET TO BE REMOVED

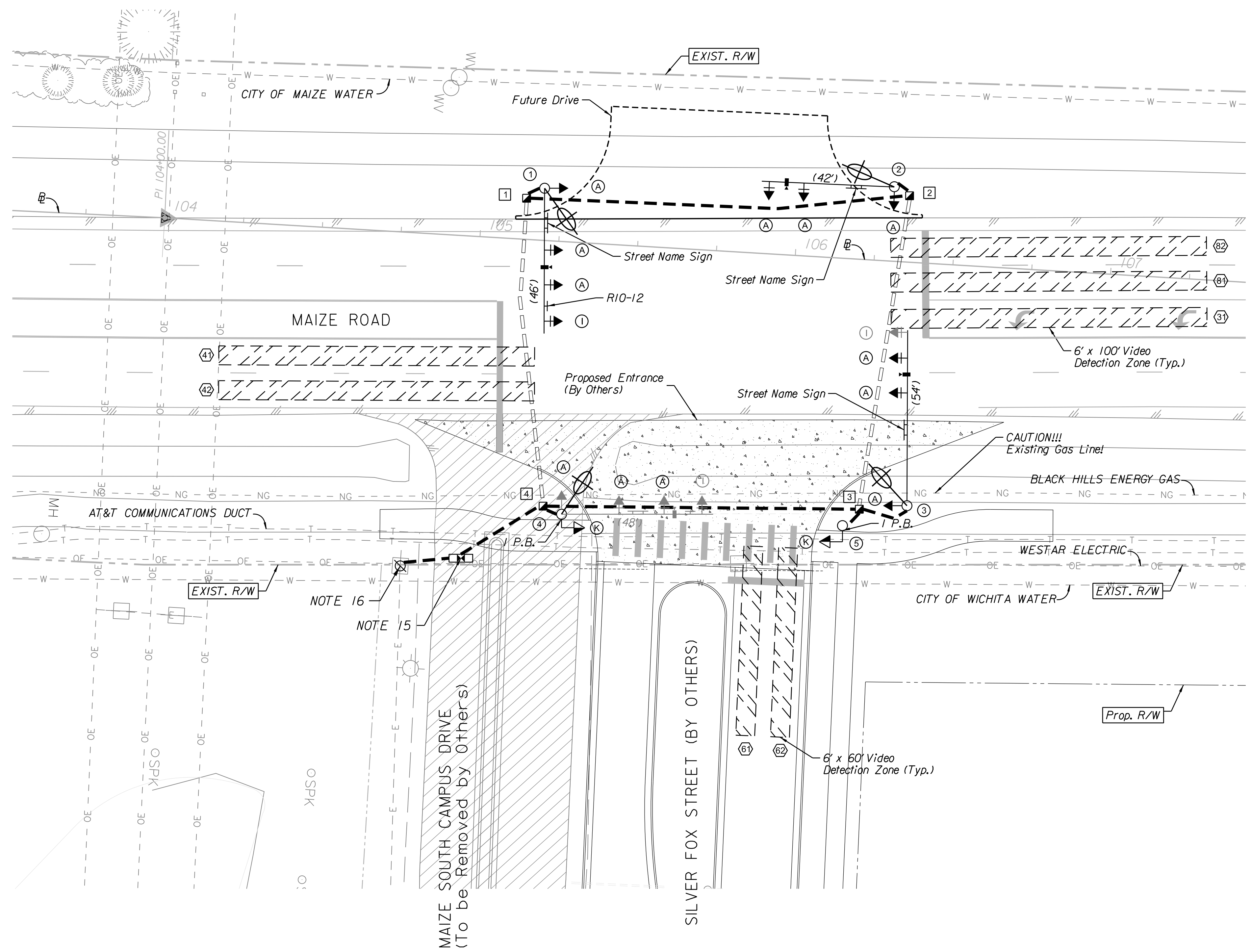

- NOTES
- THE CITY SURVEYORS WILL STAKE LOCATIONS WHERE POLES, BOXES, AND THE CONTROLLER ARE TO BE INSTALLED. APPROVED STAKED LOCATIONS SHALL BE REVIEWED AND APPROVED BY THE ENGINEER PRIOR TO CONTRACTOR ORDERING TRAFFIC SIGNAL POLES AND HARDWARE.
  - SERVICE AND JUNCTION BOXES AND CONDUIT RUNS ARE APPROXIMATE AND MAY BE FIELD ADJUSTED TO CLEAR OBSTRUCTIONS AND FACILITATE WIRING, AS APPROVED BY THE ENGINEER.
  - VIDEO DETECTION ZONES SHALL BE CENTERED IN TRAFFIC LANES, EXCEPT AS INDICATED ON THE PLANS.
  - LUMINAIRE ARMS SHALL BE ORIENTED OVER THE MAST ARM TYPICALLY. OTHERS (WESTAR) WILL MOUNT THE LUMINAIRES AND ARMS ON THE POLES. WIRING FOR POLES WILL BE AERIAL AND RUN FROM POLE TO POLE BY OTHERS (WESTAR).
  - ALL EQUIPMENT SHALL BE NEW UNLESS SHOWN OTHERWISE ON THE PLANS. SIGNAL HEADS OR TRAFFIC SIGNS THAT CONFLICT WITH THE TRAFFIC CONTROL, SHALL BE COVERED OR REMOVED.
  - SILVER FOX STREET SHALL OPERATE UNDER STOP CONTROL, AND MAIZE ROAD SHALL OPERATE AS FREE FLOW DURING CONSTRUCTION.
  - ALL CONDUIT SHALL BE BORED UNDER EXISTING PAVEMENT AND SIDEWALK NOT BEING REPLACED. THIS WORK SHALL BE SUBSIDIARY TO THE BID ITEM "TRAFFIC SIGNAL".
  - ALL COSTS ASSOCIATED WITH GRADING AND EARTHWORK ON THIS PROJECT SHALL BE SUBSIDIARY TO SITE CLEARING AND RESTORATION.
  - EXISTING FEATURES AND UTILITIES ARE SHOWN FROM AVAILABLE INFORMATION AND SHOULD BE CONSIDERED APPROXIMATE ONLY. IT IS THE RESPONSIBILITY OF THE CONTRACTOR TO VERIFY UTILITIES AND THEIR EXACT LOCATION PRIOR TO CONSTRUCTION. EXISTING UTILITIES ARE NOT PLANNED TO BE RELOCATED DURING CONSTRUCTION AND ARE TO REMAIN IN PLACE.
  - ALL CONDUIT RUNS SHALL BE STRAIGHT BETWEEN BOXES AND/OR FOUNDATIONS. CURVED LINES SHOWN ON PLAN FOR CLARITY ONLY.
  - INSTALL METER AND OTHER ELECTRICAL COMPONENTS PER POWER POLE AND SPAN POLE ASSEMBLY SHEETS. ASSUMED PROPOSED POWER HOOKUP SHOWN.
  - POLE 4 FUTURE MAST ARM CONNECTION SHALL BE EQUIPPED WITH REMOVABLE COVER PLATE.
  - SEE SHEETS 11-19 FOR DETAILED PAVEMENT MARKINGS. SOME PAVEMENT MARKINGS NOT SHOWN ON THIS SHEET FOR CLARITY.
  - POLES AND MAST ARMS SHALL BE DESIGNED FOR THE FUTURE EQUIPMENT SHOWN AS WELL AS THE PROPOSED ARRANGEMENT.
  - METER ADDRESS IS 3404 N. MAIZE ROAD 67205