

BENCHMARKS:
 Chiseled square cut on top of headwall of R.C.B.C., 31.1' southeast of the most southerly corner of Lot 1, Block A & 36.6' northeast of the northeast corner of Reserve "C".
 Elev. = 1349.83 NAVD88

Chiseled square cut on top of curb at west end of median, 89.6' south-southwest of the southwest corner of Lot 17, Block A & 86.2' south-southeast of the southeast corner of Lot 31, Block A.
 Elev. = 1348.62 NAVD88

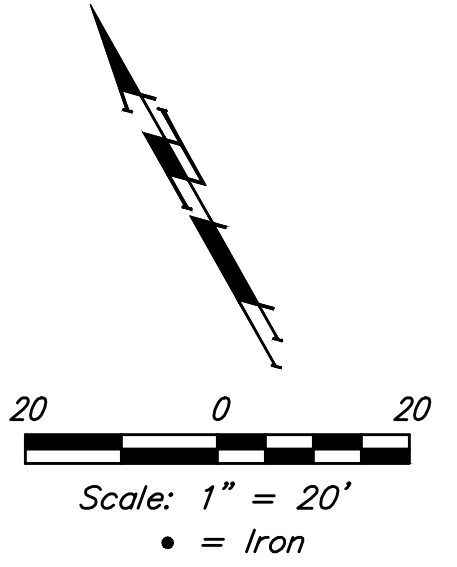

FALCON FALLS 6TH ADDITION

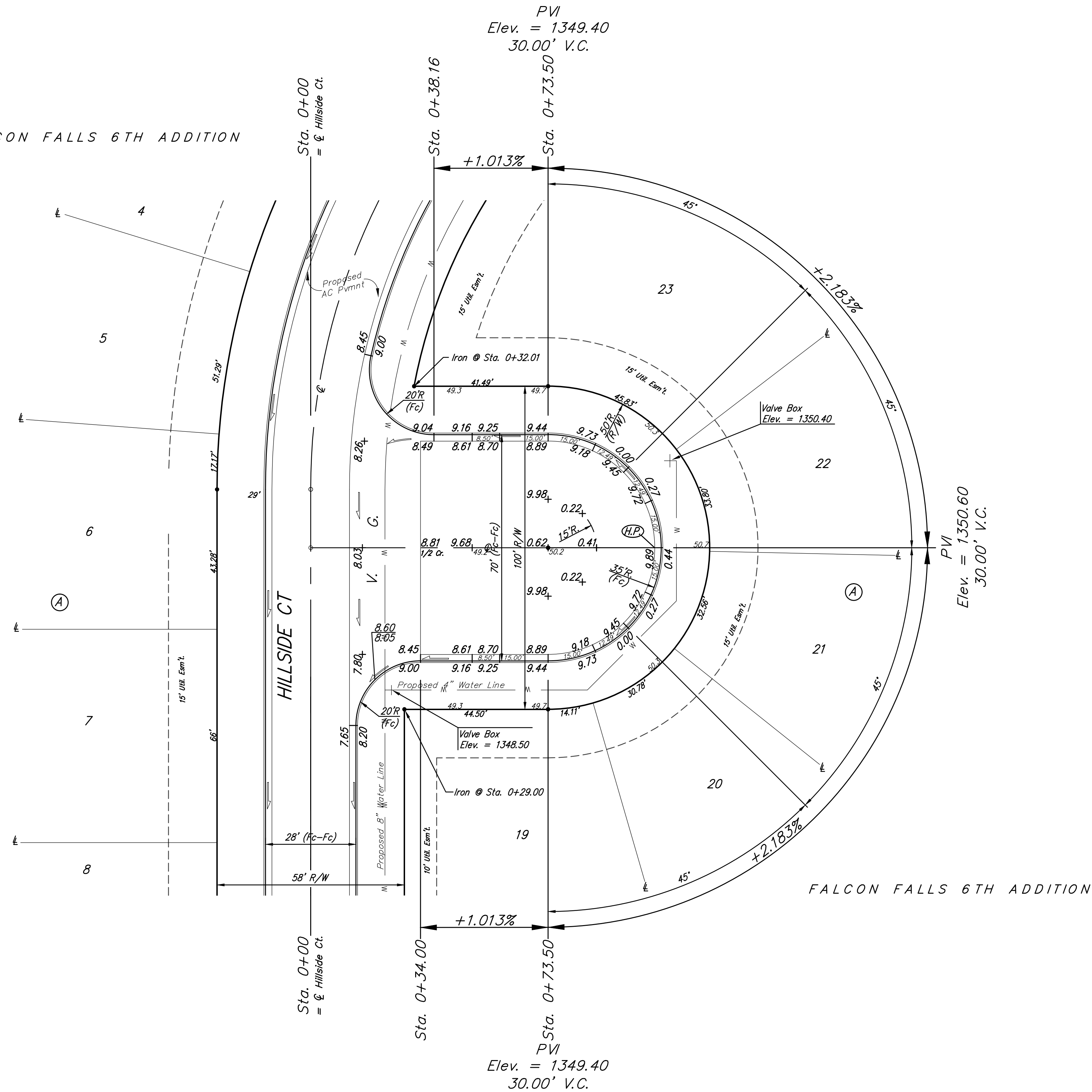

VALVE LOCATION TABLE

VALVE NUMBER	BASELINE STATION	OFFSET DISTANCE	OFFSET DIRECTION
1	3+43.25	25'	Rt.
2	7+31.31	65.3'	Rt.

Subdivision Bench Marks

Street & Station	Location Description	Elevation
Hillside Ct 1+51.98, 14.25' Rt.	Adjacent to Fire Hydrant in front of Lot 18, Block A.	
Hillside Ct 6+00.00, 14.25' Rt.	Adjacent to Fire Hydrant at NE Corner of Lot 23, Block A.	

Roll type curb & gutter to be constructed on the pavement on this sheet.
 Top of curb elevation are given for full height curb.



Baughman		Falcon Falls 6th Addition - Phase II	
HILLSIDE CT		Lots 14-16, Block A	
Baughman Company, P.A. 315 Ellis St. Wichita, KS 67211 P 316-262-7271 F 316-262-0149 ENGINEERING SURVEYING PLANNING LANDSCAPE ARCHITECTURE			
PROJECT NUMBER	DESIGN AEG	DRAWN JAK	
REVISIONS:	APPROVED	DATE 11/24/15	
	SCALE Noted	SHEET	
			9 OF 24