

CONCRETE REPAIR DETAILS

PROJECT NO.	472-84922	
DATE	04/05/2016	
SCALE	NONE	
DESIGNED	DRAWN	CHECKED
HWL	DPG	KJS
NO.	REVISION	DATE

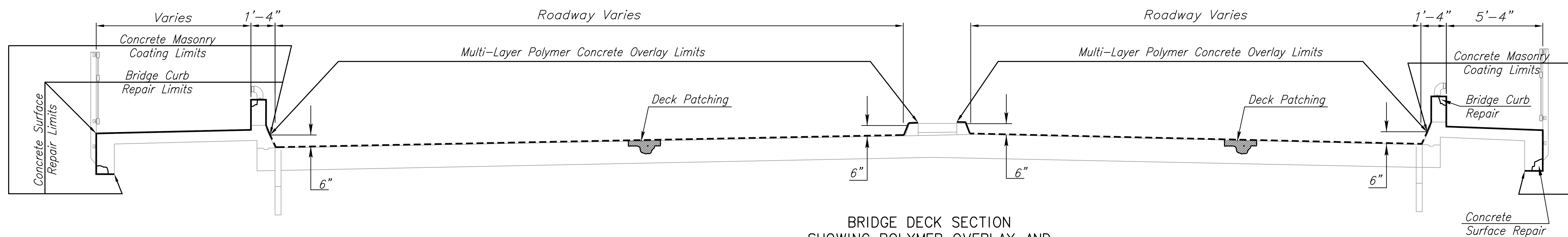

**BRIDGE DECK SECTION
SHOWING POLYMER OVERLAY AND
CONCRETE MASONRY COATING LIMITS**
(Looking Forward Station)

BRIDGE CURB REPAIR:

This item shall consist of removing unsound concrete from the traffic rail and bridge sidewalks, cleaning reinforcing bars, filling the removed patched areas with Concrete (Grade 4.0) (AE) and preparing the entire area for Concrete Masonry Coating. Quantity shown is estimated from field observations. The exact area shall be determined by tapping, before, during and after chipping operation to ensure that all unsound concrete has been removed. Areas to be patched will be determined by the Engineer.

The Contractor shall perform the work in accordance with KDOT Standard Specifications Section 728. The removal of deteriorated or damaged concrete, placement of new concrete, and all labor, materials, equipment, and incidentals necessary to complete the repairs shall be paid for as "Bridge Curb Repair" (Sq. Ft.).

CONCRETE SURFACE REPAIR:

This item shall consist of removing unsound concrete from the outside sidewalk beam, cleaning reinforcing bars, filling the removed patched areas with Concrete (Grade 4.0) (AE) and preparing the entire area for Concrete Masonry Coating. Quantity shown is estimated from field observations. The exact area shall be determined by tapping, before, during and after chipping operation to ensure that all unsound concrete has been removed. Areas to be patched will be determined by the Engineer.

The Contractor shall perform the work in accordance with KDOT Standard Specifications Section 826. The removal of deteriorated or damaged concrete, placement of new concrete, and all labor, materials, equipment, and incidentals necessary to complete the repairs shall be paid for as "Concrete Surface Repair" (Sq. Ft.).

CONCRETE MASONRY COATING:

The Contractor shall submit a color chart to the County for approval prior to Construction.

These areas are to be sandblasted to remove loose disintegrated concrete, dirt, oil, and any foreign material along the entire length of the curb. Apply an approved Concrete Masonry Coating to the top and to the traffic face of the curb along the entire length of the bridge. This work shall conform to KDOT specifications. This shall be paid for as "Concrete Masonry Coating".

MULTI-LAYER POLYMER CONCRETE OVERLAY:

Prepare and overlay the bridge roadway surface using a Polymer Concrete Overlay (Two-Coat Broom and Seed). On bridges with corral rail, apply epoxy to the traffic face on interior post(s) to the bottom of the top rail and the two adjacent surfaces. On bridges with continuous concrete barrier rails, apply the epoxy to the first break in the geometry of the barrier to a minimum height of 6 inches above the deck. Apply epoxy to the curb, barrier or post(s) as each of the overlay applications are performed.

All work related to applying epoxy to areas beyond the bridge roadway surface width shall be subsidiary to the bid item "Multi-Layer Polymer Concrete Overlay".

Install per Manufacturer's specifications and KDOT specifications, Section 729.

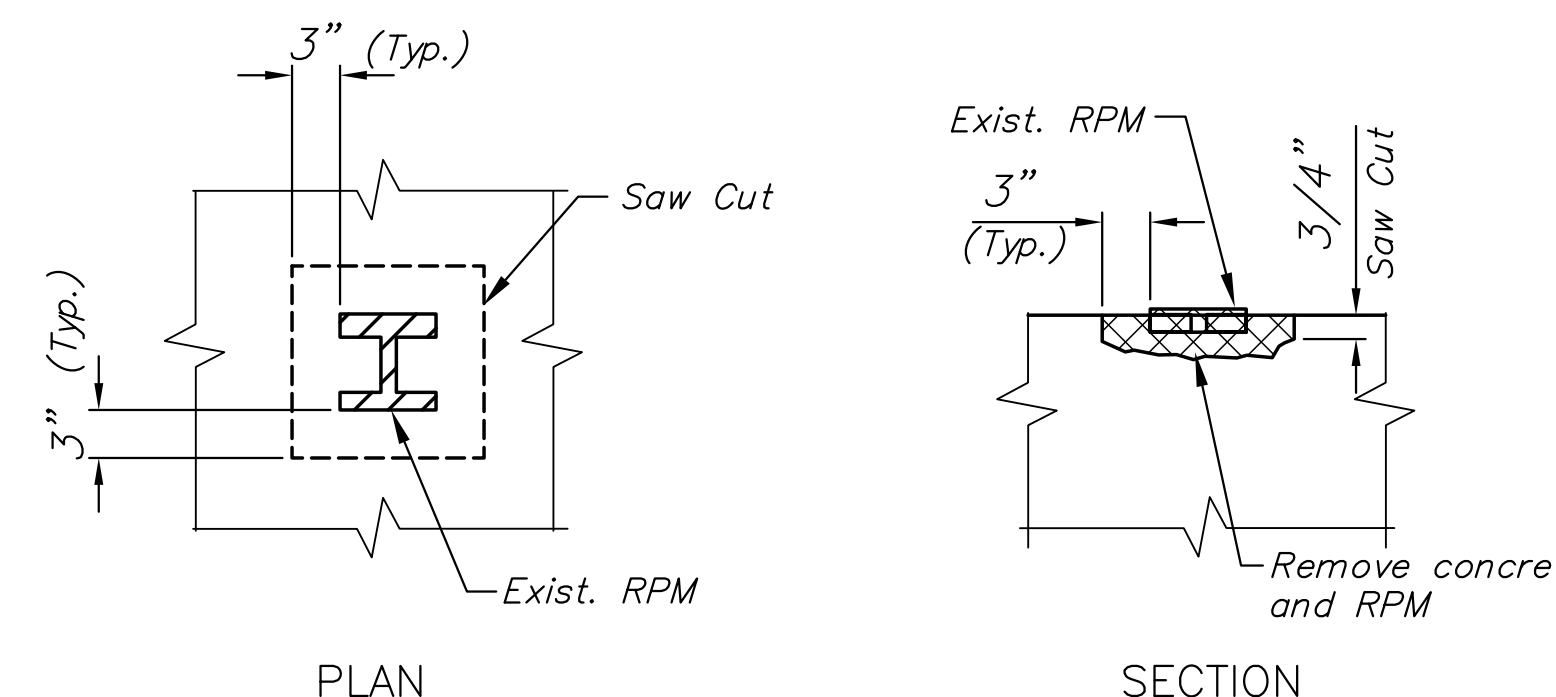

NOTE:
All raised pavement markers (RPMs) shall be removed from the bridge deck as part of the preparation for the deck overlay. Removal of the RPMs shall be accomplished by first preparing the repair boundaries by sawing a 3/4" kerf around the RPM as shown on this sheet. Concrete shall be removed along with the RPM in a manner that does not extend beyond the kerf or create a feathered concrete edge. After removal of the RPM, the repair area shall be prepared for patching as specified. This work is paid for as "Area Prepared for Patching". See Sh. 26.

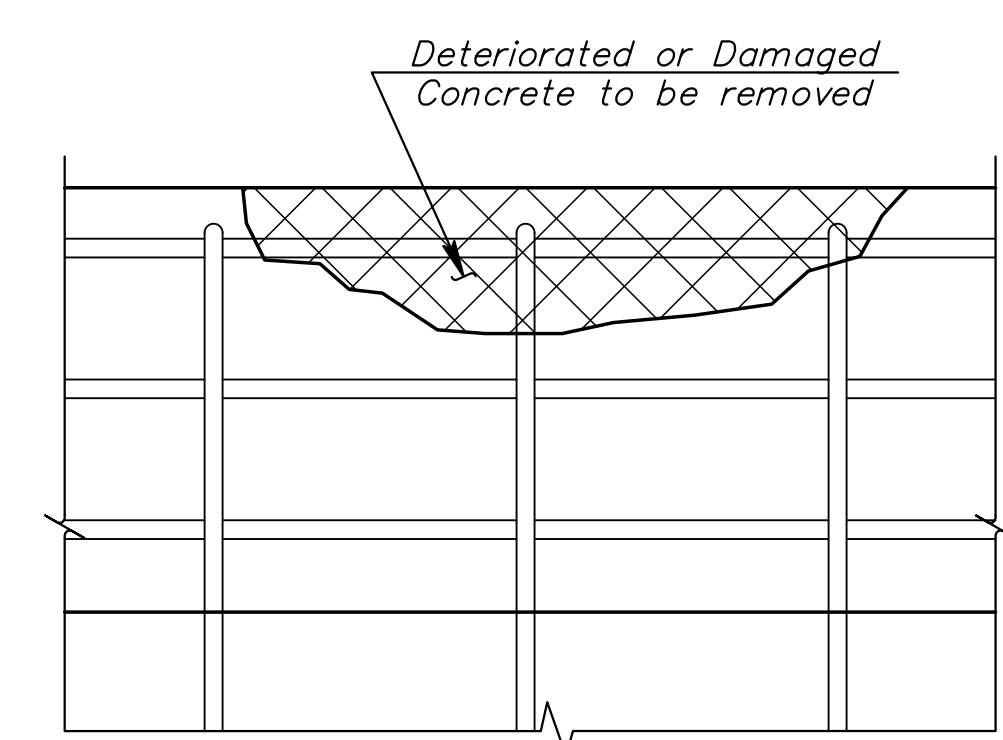

ELEVATION

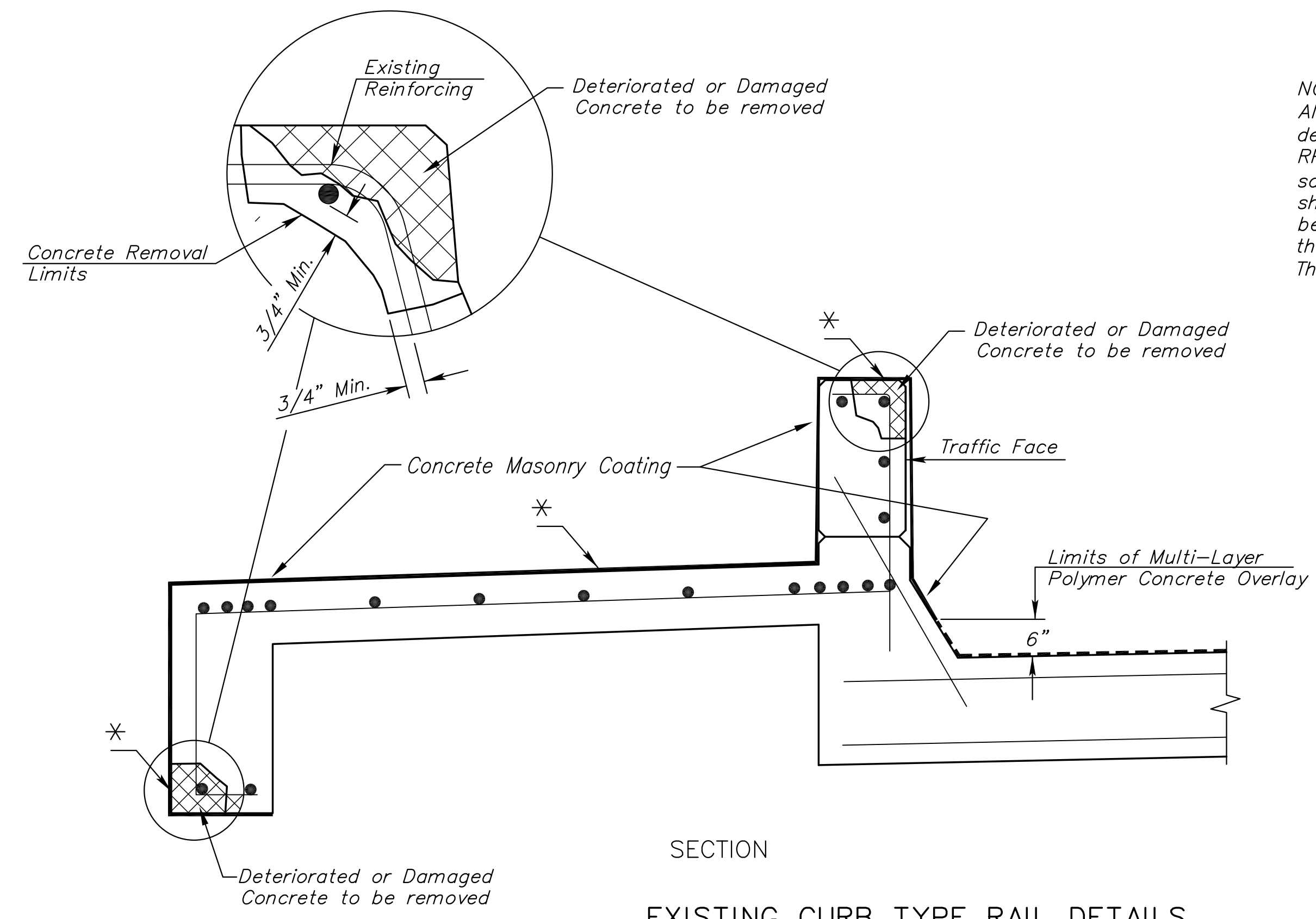

**SECTION
EXISTING CURB TYPE RAIL DETAILS**
*Refer to notes for "Concrete Masonry Coating"

SUMMARY OF QUANTITIES		
ITEM	UNITS	QUANTITY
Concrete Masonry Coating	L.S.	1
Bridge Curb Repair	S.F.	195
Concrete Surface Repair	S.F.	3,004
Multi-Layer Polymer Concrete Overlay	S.Y.	2,831

PLOTTED: Tuesday, April 05, 2016 @ 12:10PM
K:\Chin\Bachung\DETAILS\10264-Conc Repair Details.dwg