

SCALE:
HORIZONTAL: 1" = 20'
VERTICAL: 1" = 5'

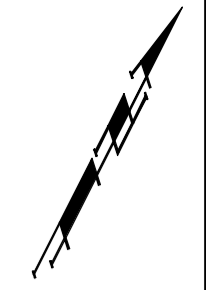

CAUTION!
Existing
Gas & SS
Crossings

Cut and Cap Existing
Water Line.

Sta. 19+21.22, Water Line 21 =
Sta. 18+98.74, Water Line 20 =
B.L. Sta. 20+52.63, 18.5' Lt.
Install 1-8" X 8" CIMJ Tee (NW)
Install 2-8" Anchored Valve Assy. (NW&SW)
Valve Box Elev. = 1342.2

CAUTION!
Existing
OHE
Crossing

Sta. 18+23.38, Water Line 21 =
B.L. Sta. 19+54.78, 18.5' Lt.
P.T. of 207.3' Radius Curve.

Sta. 16+62.43, Water Line 21 =
B.L. Sta. 17+79.47, 18.5' Lt.
P.C. of 207.3' Radius Curve.

Sta. 16+00.00, Water Line 21 =
B.L. Sta. 17+17.04, 18.5' Lt.
(Match Point)

Sta. 20+50.00, Water Line 21 =
B.L. Sta. 21+81.40, 18.5' Lt.
(Match Point)

Install 128.78 L.F.
8" Pipe.

Install 97.84 L.F.
8" Pipe.

Install 160.95 L.F.
8" Pipe.

Install 62.43 L.F.
8" Pipe.



Location of Existing Line is Based on Record Information from the City. The Contractor Shall Excavate the Ex. Water and to Verify Size and Location PRIOR to Beginning Construction. This Work Shall be Considered SUBSIDIARY to the Water Line Installation.

Water Line 21 B.L. Sta. =
Centerline of Bekemeyer

Water Line 21 B.L. Sta. 20+34.63 =
Intersection of Murdock and Bekemeyer

Water Line 21

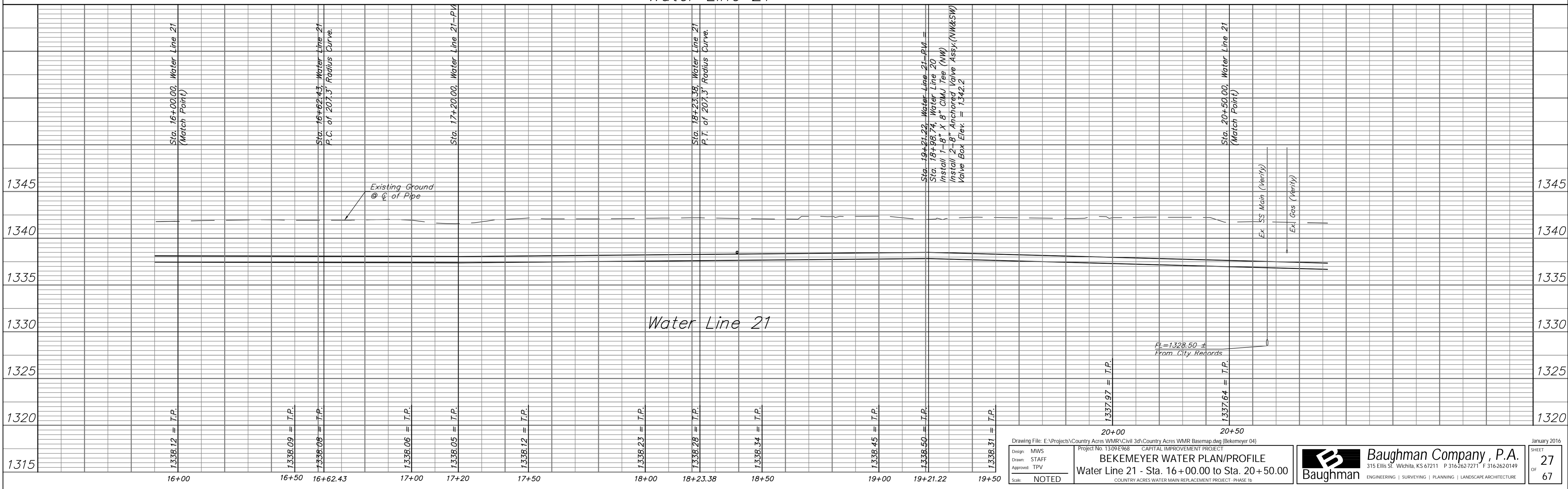

Drawing File: E:\Projects\Country Acres WMR\Civil 3d\Country Acres WMR Basemap.dwg (Bekemeyer 04)
Project No. 1309E968 CAPITAL IMPROVEMENT PROJECT
Design: MWS
Drawn: STAFF
Approved: TPV
Scale: NOTED
BEKEMEYER WATER PLAN/PROFILE
Water Line 21 - Sta. 16+00.00 to Sta. 20+50.00
COUNTRY ACRES WATER MAIN REPLACEMENT PROJECT - PHASE 1b

Baughman Company, P.A.
315 Ellis St., Wichita, KS 67211 P 316.262.7271 F 316.262.0149
ENGINEERING | SURVEYING | PLANNING | LANDSCAPE ARCHITECTURE

January 2016
SHEET 27 OF 67