

PLOTTED: Thursday, June 02, 2016 @ 12:00PM

J:\PROJECTS\2016\1501010623_COW_REUSE_WATER_SUPPLY_SYSTEM\150623_CAD\SYSTEMS\CIVIL\TR15022_CG-01.DWG

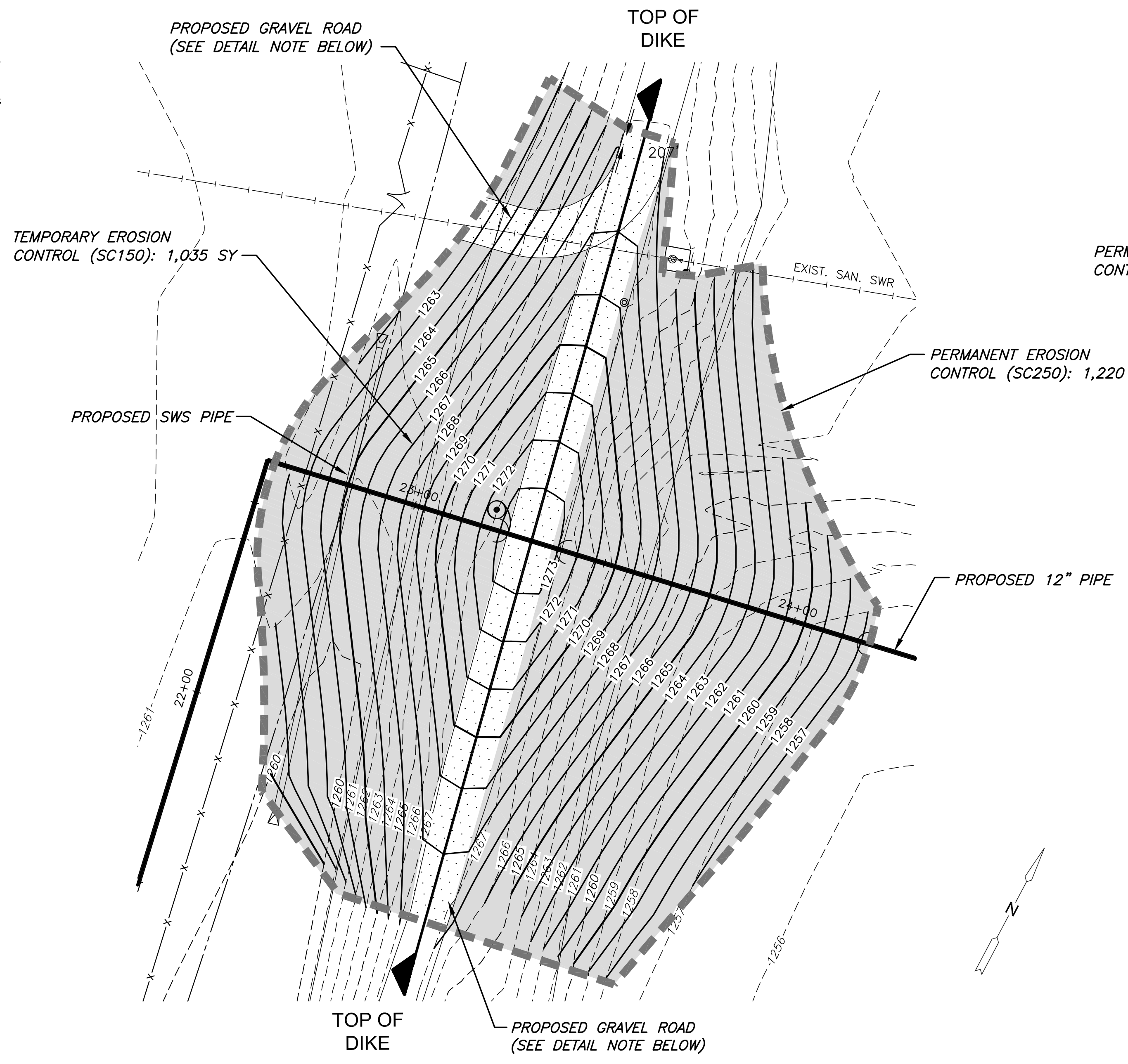

DIKE GRADING: WEST CROSSING

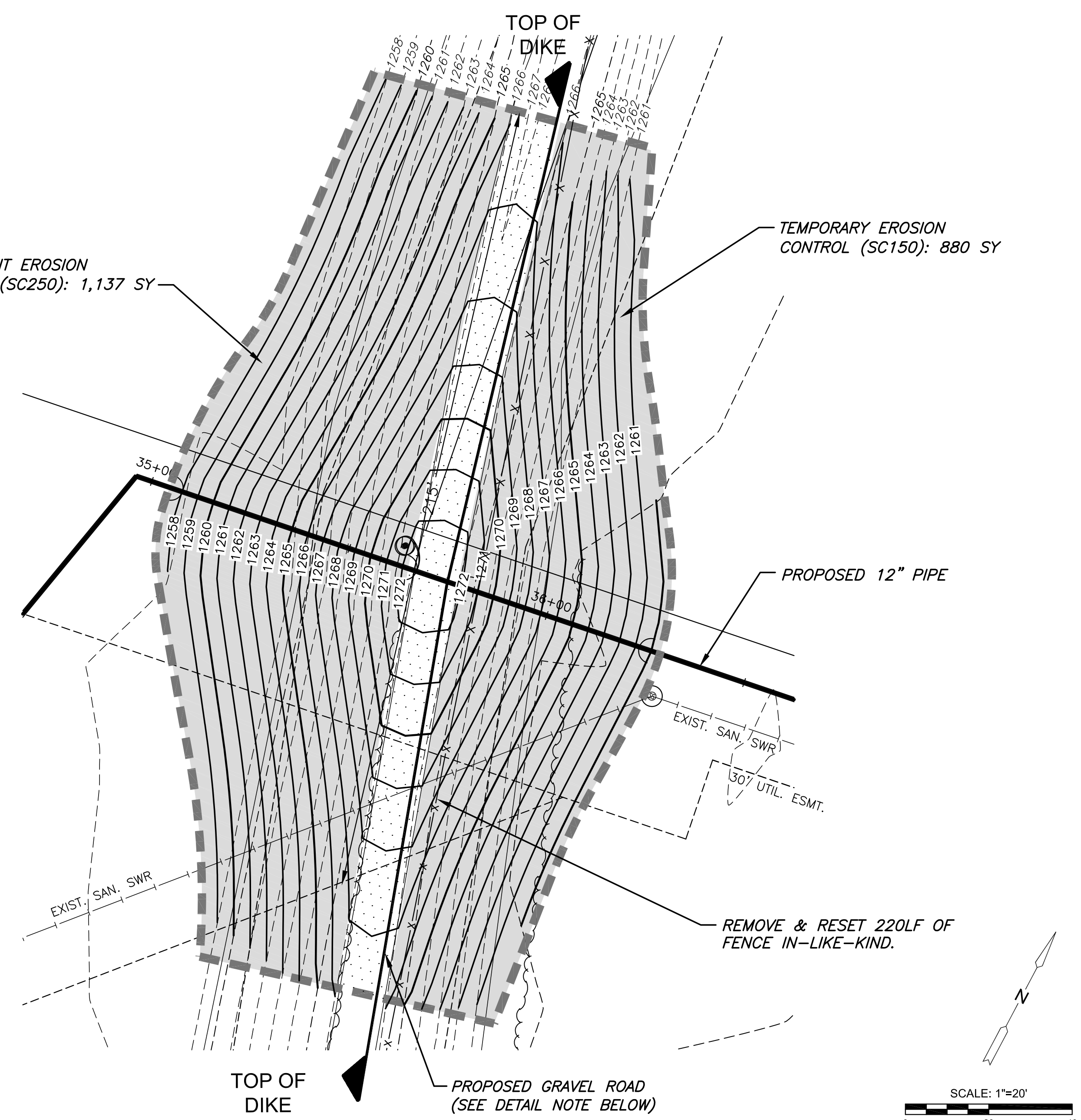

DIKE GRADING: EAST CROSSING

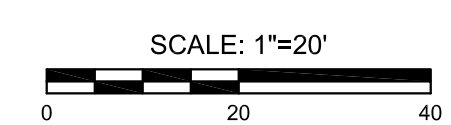

EROSION CONTROL & SEEDING NOTES

1. EROSION CONTROL IS TO MEET ALL FEDERAL, STATE, COUNTY & LOCAL CODE STANDARDS.
2. CONTRACTOR SHALL PROVIDE AND PRESERVE EROSION PROTECTION THROUGHOUT PROJECT CONSTRUCTION. THE PLAN PROVIDED HERE IS FOR FINAL PROTECTION. VARIOUS PHASES OF THIS PLAN SHALL BE IMPLEMENTED OR MODIFIED TO CONTROL EROSION. MODIFICATIONS OF THE PLAN SHALL BE APPROVED BY THE OWNER'S REPRESENTATIVE.
3. CONTRACTOR IS RESPONSIBLE FOR MAINTAINING AND IMPLEMENTING ALL EROSION CONTROL. COST IS SUBSIDIARY TO CHECK DAMS AND STABILIZED CONSTRUCTION ENTRANCE.
4. ALL SEEDED AREAS SHALL IMMEDIATELY RECEIVE EROSION CONTROL MATTING PER PLAN VIEW CALLOUTS.

SITE RESTORATION NOTE

AREAS WITHIN THE GRADING LIMITS DELINEATED ON EACH LEVEE, BORE PIT, STOCKPILE AND OTHER DISTURBED AREAS WITHIN THE LEVEES, AND ALL OTHER AREAS, FROM LEVEE TO LEVEE, THAT HAVE BEEN DISTURBED BY CONSTRUCTION ACTIVITY SHALL BE SEEDED WITH A PRAIRIE GRASS MIXTURE. SEE NOTES ON SHEET 2.

GENERAL GRADING NOTES:

1. ALL GRADES SHALL BE CONTOURED SMOOTHLY WITH GENTLE ROUNDING/SHAPING OF ALL AFFECTED LAND SURFACES. ABRUPT TRANSITIONS AT THE TOP OF SLOPES WHERE PROPOSED GRADES MEET EXISTING ARE NOT ACCEPTABLE.
2. UNLESS SHOWN OR STATED OTHERWISE ON THESE DRAWINGS, MATERIALS AND CONSTRUCTION SHALL BE IN ACCORDANCE WITH CITY OF WICHITA STANDARD SPECIFICATIONS.
3. ALL COMPACTION OF EARTHWORK SHALL BE 95% STANDARD DENSITY.
4. BORROW SHALL BE CONTRACTOR FURNISHED.
5. 25% HAS BEEN ADDED TO EXCAVATION QUANTITIES TO ALLOW FOR COMPACTION AND HANDLING
6. LOOSE THICKNESS OF EACH LAYER OF FILL TO BE PLACED SHALL NOT EXCEED EIGHT INCHES (8").

EARTHWORK TABULATIONS:

EXCAVATION (BORROW -CONTRACTOR FURNISH)	5,400 CY
COMPACTED FILL(95% DENSITY) - WEST	2,365 CY
COMPACTED FILL(95% DENSITY) - EAST	1,955 CY

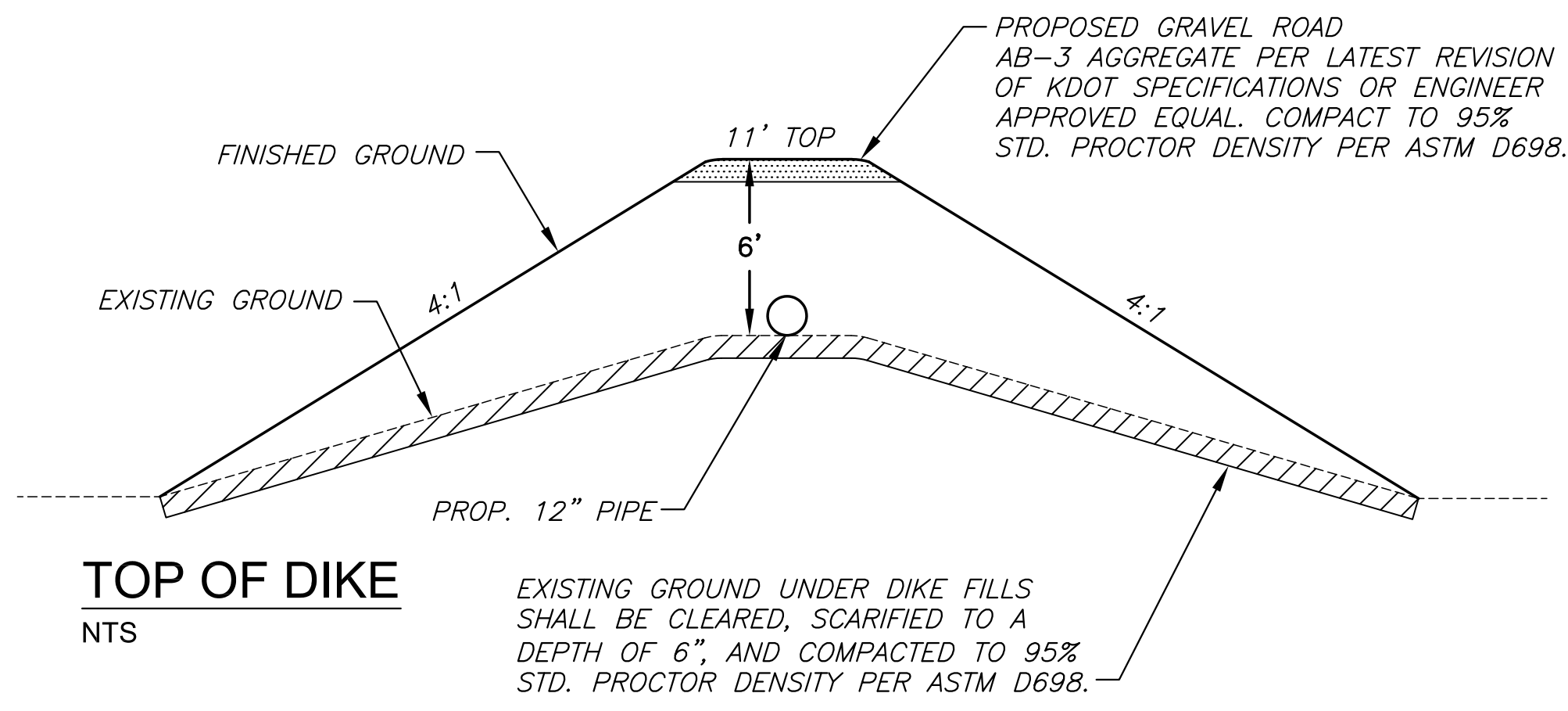

LEGEND

- 1359 --- - EXISTING CONTOURS
- 1360 — - PROPOSED CONTOURS
- --- - LIMITS OF GRADING
- - PERMANENT EROSION CONTROL NORTH AMERICAN GREEN: SC250 (INSIDE OF DIKE)
- - TEMPORARY EROSION CONTROL NORTH AMERICAN GREEN SC150 (OUTSIDE OF DIKE)
- - GRAVEL DRIVE

©2016 MKEC Engineering All Rights Reserved www.mkec.com
These drawings and their contents, including, but not limited to, all concepts, designs, & ideas are the exclusive property of MKEC Engineering (MKEC), and may not be used or reproduced in any way without the express consent of MKEC.

GRADING PLAN

PROJECT NO.	468-85095	
DATE	APRIL 2016	
SCALE	1" = 20'	
DESIGNED	DRAWN	CHECKED
DFL	JWC	MAB
0	ISSUED FOR CONST.	06/01/16
NO.	REVISION	DATE