

BENCHMARKS:
 CITY OF WICHITA BENCHMARK DISK
 34.9' S. & 31.2' W. OF THE SW COR.,
 NW1/4, SEC. 2, TWP. 27-S, R-1-W.
 ELEV. = 1327.57 NAVD88

CITY OF WICHITA BENCHMARK DISK
 26.2' S. & 46.1' W. OF THE NW COR.,
 NW1/4, SEC. 2, TWP. 27-S, R-1-W.
 ELEV. = 1330.50 NAVD88

CITY OF WICHITA BENCHMARK DISK
 0.9' E. & 29' N. OF THE NE COR.,
 NW1/4, SEC. 2, TWP. 27-S, R-1-W.
 ELEV. = 1325.19 NAVD88

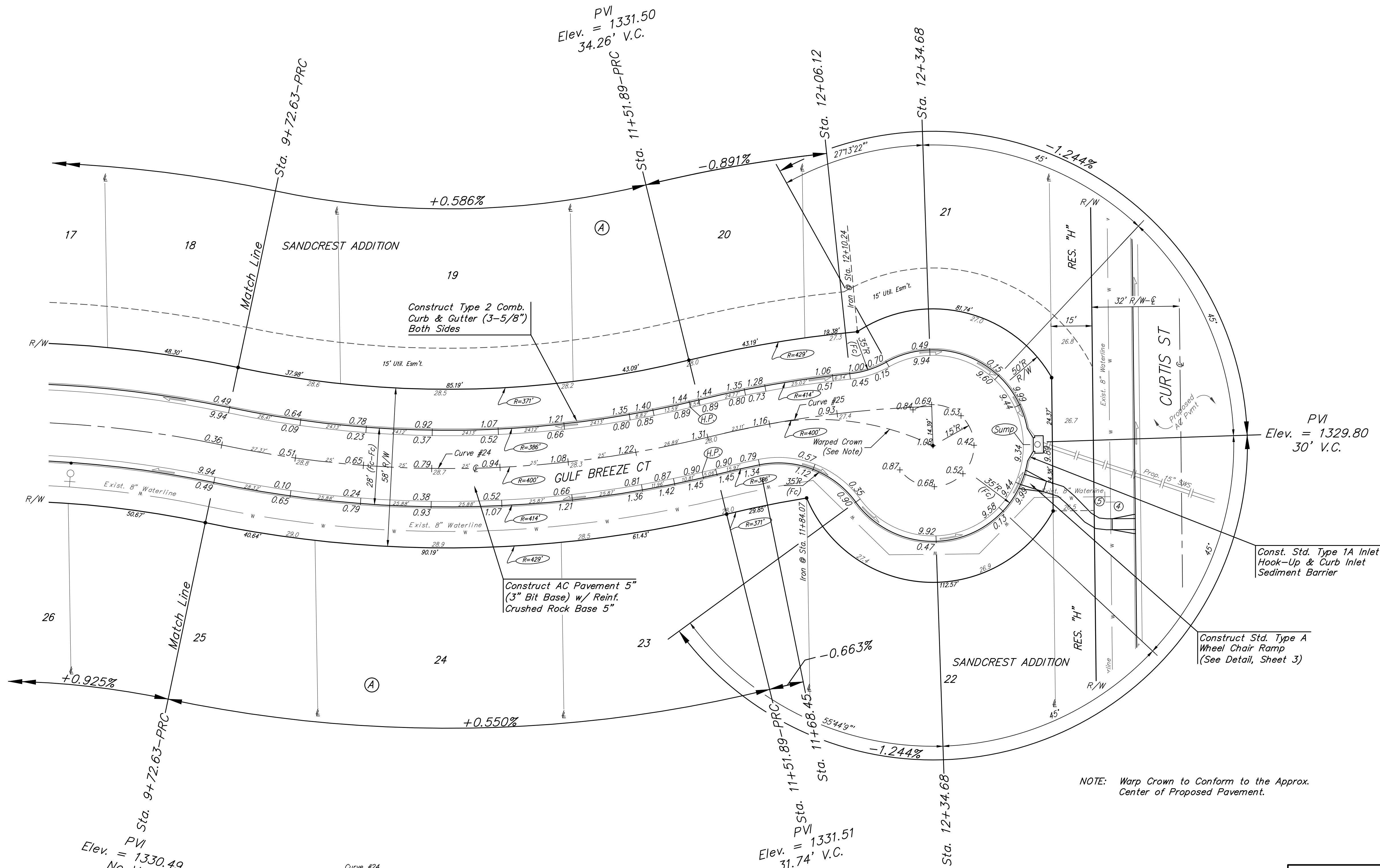
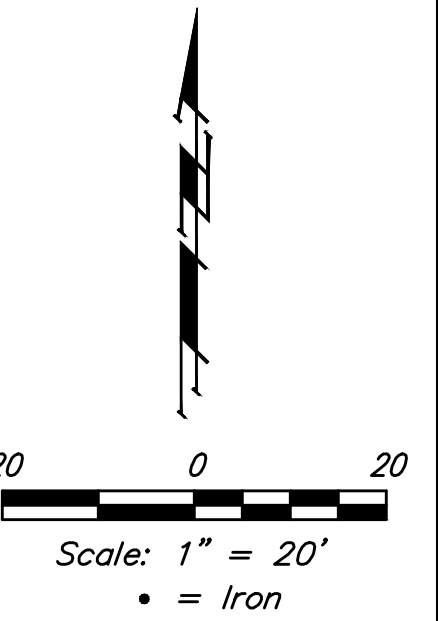

NOTE: Warp Crown to Conform to the Approx. Center of Proposed Pavement.

PVI
 Elev. = 1330.49
 No V.C.

PVI
 Elev. = 1331.51
 31.74' V.C.

Curve #24
 Curve Data Based on Centerline
 Rad. = 400' Delta = 25°40'38" Tangent = 91.16'
 Arc = 179.26' L.C. = 177.76' Def./Ft. = 4.29720 Min.

Station	Arc	Chord		Defl.	Total Defl.
		8' Left	8' Right		
9+72.63	-	-	-	0°00'00"	0°00'00"
9+75.00	2.37'	2.24'	2.50'	0°10'11"	0°10'11"
10+00.00	25.00'	23.62'	26.37'	1°47'26"	1°57'37"
10+25.00	25.00'	23.62'	26.37'	1°47'26"	3°45'03"
10+50.00	25.00'	23.62'	26.37'	1°47'26"	5°32'28"
10+75.00	25.00'	23.62'	26.37'	1°47'26"	7°19'54"
11+00.00	25.00'	23.62'	26.37'	1°47'26"	9°07'20"
11+25.00	25.00'	23.62'	26.37'	1°47'26"	10°54'46"
11+50.00	25.00'	23.62'	26.37'	1°47'26"	12°42'12"
11+51.89	1.89'	1.79'	1.99'	0°08'07"	12°50'19"

Curve #25
 Curve Data Based on Centerline
 Rad. = 400' Delta = 11°51'27" Tangent = 41.54'
 Arc = 82.79' L.C. = 82.63' Def./Ft. = 4.29671 Min.

Station	Arc	Chord		Defl.	Total Defl.
		8' Left	8' Right		
11+51.89	-	-	-	0°00'00"	0°00'00"
11+68.45	16.56'	17.47'	15.65'	1°11'09"	1°11'09"
11+75.00	6.55'	6.91'	6.19'	0°28'09"	1°39'18"
12+00.00	25.00'	26.37'	23.62'	1°47'25"	3°26'43"
12+06.12	6.12'	6.46'	5.78'	0°26'18"	3°53'01"
12+25.00	18.88'	19.91'	17.84'	1°21'07"	5°14'08"
12+34.68	9.68'	10.21'	9.15'	0°41'35"	5°55'43"

Roll type curb & gutter to be constructed on the pavement on this sheet. Top of curb elevation are given for full height curb.



		Sandcrest Addition - Phase I	
		GULF BREEZE CT	
Sta. 9+72.63 to Sta. 12+34.68		Baughman Company, P.A. 315 Ellis St. Wichita, KS 67211 P 316-262-7271 F 316-262-0149	
ENGINEERING SURVEYING PLANNING LANDSCAPE ARCHITECTURE		PROJECT NUMBER: 472-85252	
REVISIONS:		DESIGN: AEG	DRAWN: JAK
		APPROVED:	DATE: 7/19/16
		SCALE: Noted	SHEET: 11 OF 66