

BENCHMARKS:
 CITY OF WICHITA BENCHMARK DISK
 34.9' S. & 31.2' W. OF THE SW COR.,
 NW1/4, SEC. 2, TWP. 27-S, R-1-W.
 ELEV. = 1327.57 NAVD88

CITY OF WICHITA BENCHMARK DISK
 26.2' S. & 46.1' W. OF THE NW COR.,
 NW1/4, SEC. 2, TWP. 27-S, R-1-W.
 ELEV. = 1330.50 NAVD88

CITY OF WICHITA BENCHMARK DISK
 0.9' E. & 29' N. OF THE NE COR.,
 NW1/4, SEC. 2, TWP. 27-S, R-1-W.
 ELEV. = 1325.19 NAVD88

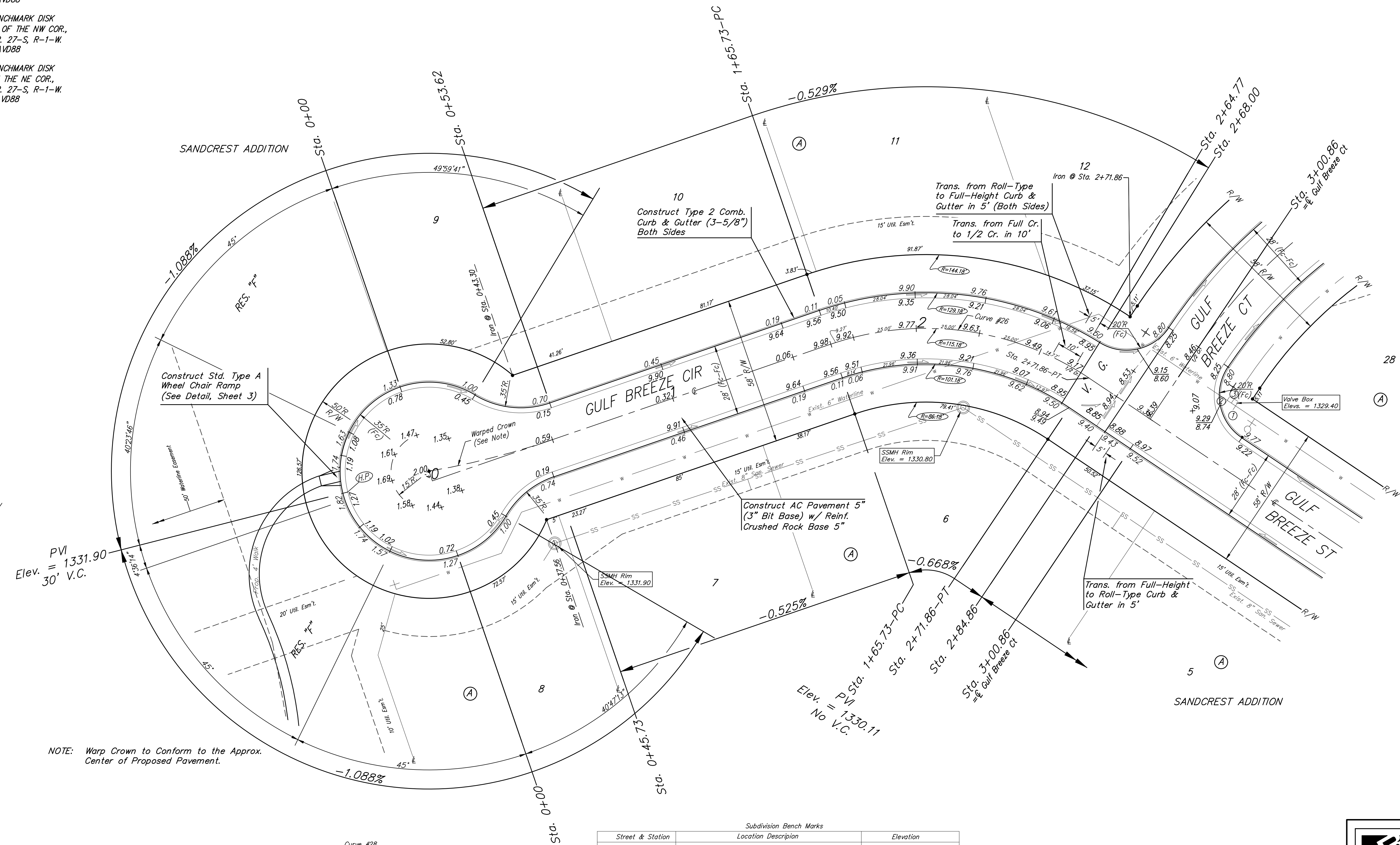
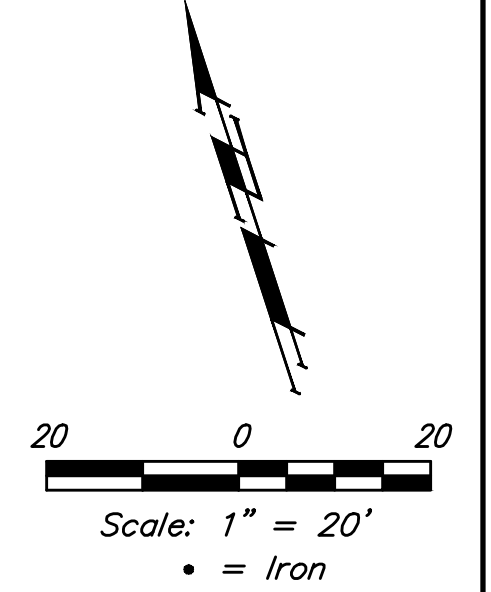

NOTE: Warp Crown to Conform to the Approx. Center of Proposed Pavement.

Curve #28
 Curve Data Based on Centerline
 Rad. = 115.18' Delta = 52°47'49" Tangent = 57.17'
 Arc = 106.13' L.C. = 102.42' Def./Fl. = 14.92423 Min.

| Station | Arc | Chord | | Defl. | Total Defl. |
|---------|--------|---------|----------|----------|-------------|
| | | 8' Left | 8' Right | | |
| 1+65.73 | - | - | - | 0°00'00" | 0°00'00" |
| 1+75.00 | 9.27' | 11.04' | 7.50' | 2°18'21" | 2°18'21" |
| 2+00.00 | 25.00' | 29.72' | 20.19' | 6°13'06" | 8°31'27" |
| 2+25.00 | 25.00' | 29.72' | 20.19' | 6°13'07" | 14°44'34" |
| 2+50.00 | 25.00' | 29.72' | 20.19' | 6°13'06" | 20°57'40" |
| 2+64.77 | 14.77' | 17.58' | 11.94' | 3°40'26" | 24°38'06" |
| 2+68.00 | 3.23' | 3.85' | 2.61' | 0°48'12" | 25°26'18" |
| 2+71.86 | 3.86' | 4.60' | 3.12' | 0°57'36" | 26°23'54" |

Subdivision Bench Marks

| Street & Station | Location Description | Elevation |
|---------------------------------------|--|-----------|
| Gulf Breeze Ct 9+18.01, 14.25' Rt. | Adjacent to Fire Hydrant at SE Corner of Lot 26, Block B | |
| Gulf Breeze St 0+34.00, 14.25' Lt. | Adjacent to Fire Hydrant at S End of SE Return Gulf Breeze St & Gulf Breeze Ct | |
| Curtis St 4+30.62, 17.25' Lt. | Adjacent to Fire Hydrant at East End of East Return Gulf Breeze St & Curtis St | |
| Curtis St 11+04.59, 17.25' Lt. | Adjacent to Fire Hydrant at East Side of Reserve "H" | |
| Wavecrest Cir 2+56.92, 14.25' Lt. | Adjacent to Fire Hydrant at South Side of Reserve "I" Across from Lot 12, Block B | |
| Wavecrest Cir 10+12.35, 14.25' Lt. | Adjacent to Fire Hydrant at South Side of Reserve "I" Across from the NE Corner of Lot 19, Block B | |

VALVE LOCATION TABLE

| VALVE NUMBER | BASILINE STATION | OFFSET DISTANCE | OFFSET DIRECTION |
|--------------|------------------|-----------------|------------------|
| 1 | 4+46.20 | 25' | Rt. |
| 2 | 4+46.20 | 21' | Rt. |
| 3 | 4+48.20 | 23' | Rt. |
| 4 | 4+67.33 | 29' | Lt. |
| 5 | 12+52.59 | 26' | Lt. |
| 6 | 12+54.59 | 28' | Lt. |
| 7 | 15+08.74 | 33' | Lt. |
| 8 | 15+10.74 | 35' | Lt. |
| 9 | 14+08.20 | 23' | Lt. |

Roll type curb & gutter to be constructed on the pavement on this sheet.
 Top of curb elevation are given for full height curb.



Baughman Sandcrest Addition - Phase I
GULF BREEZE CIR
 Lots 6-12, Block A

Baughman Company, P.A. 315 Ellis St. Wichita, KS 67211 P 316-262-7271 F 316-262-0149
 ENGINEERING | SURVEYING | PLANNING | LANDSCAPE ARCHITECTURE

PROJECT NUMBER: 472-85252
 DESIGN: AEG
 DRAWN: JAK
 APPROVED: [Signature]
 DATE: 7/19/16

REVISIONS:

SCALE: Noted
 SHEET: **12 OF 66**

E:\Projects\Pearl Beach_1202\F860\Engineering\Phase I\Str_1510-E318\STR PLANS.dwg