

**BENCHMARKS:**  
 CITY OF WICHITA BENCHMARK DISK  
 34.9' S. & 31.2' W. OF THE SW COR.,  
 NW1/4, SEC. 2, TWP. 27-S, R-1-W.  
 ELEV. = 1327.57 NAVD88

CITY OF WICHITA BENCHMARK DISK  
 26.2' S. & 46.1' W. OF THE NW COR.,  
 NW1/4, SEC. 2, TWP. 27-S, R-1-W.  
 ELEV. = 1330.50 NAVD88

CITY OF WICHITA BENCHMARK DISK  
 0.9' E. & 29' N. OF THE NE COR.,  
 NW1/4, SEC. 2, TWP. 27-S, R-1-W.  
 ELEV. = 1325.19 NAVD88

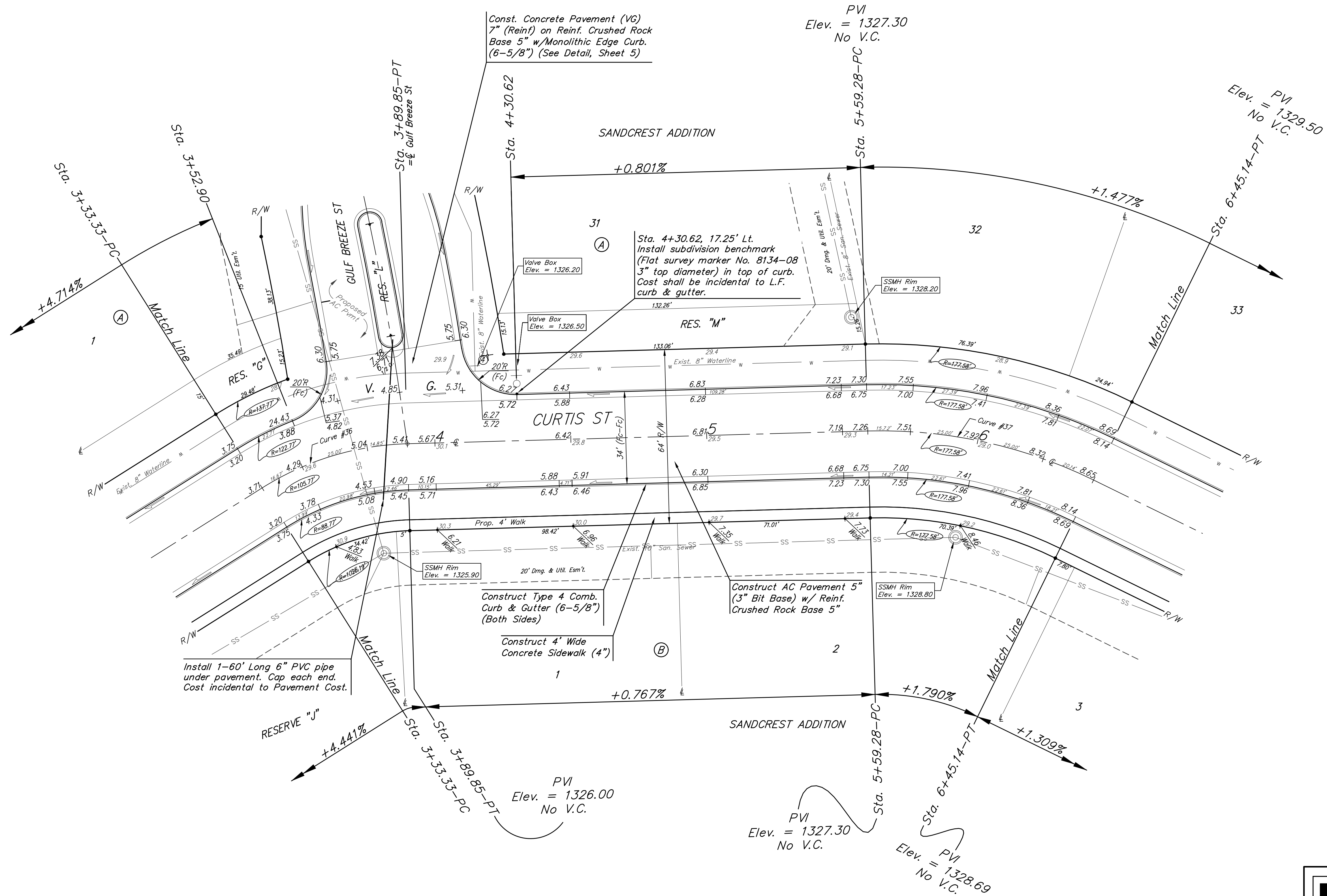
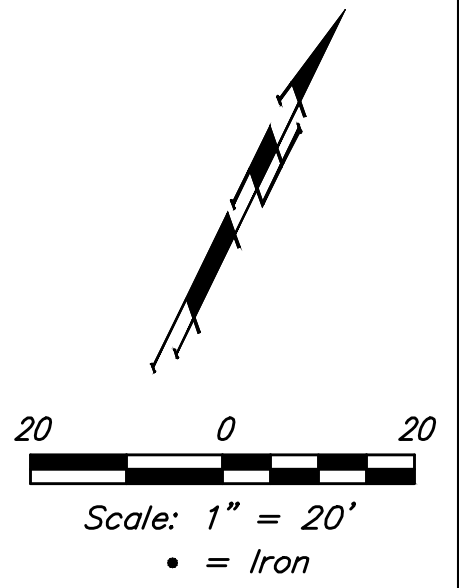

Curve #36  
 Curve Data Based on Centerline  
 Rad. = 105.77' Delta = 30°36'49" Tangent = 28.95'  
 Arc = 56.52' L.C. = 55.84' Def./Ft. = 16.24926 Min.

Station	Chord		Defl.	Total Defl.
	8' Left	8' Right		
3+33.33	-	-	0°00'00"	0°00'00"
3+50.00	16.67'	20.59'	4°30'53"	4°30'53"
3+75.00	25.00'	30.83'	6°46'13"	11°17'06"
3+89.85	14.85'	18.34'	4°01'19"	15°18'25"

Curve #37  
 Curve Data Based on Centerline  
 Rad. = 177.58' Delta = 27°42'04" Tangent = 43.78'  
 Arc = 85.86' L.C. = 85.02' Def./Ft. = 9.67893 Min.

Station	Arc	Chord		Defl.	Total Defl.
		8' Left	8' Right		
5+59.28	-	-	-	0°00'00"	0°00'00"
5+75.00	15.72'	17.93'	13.50'	2°32'09"	2°32'09"
6+00.00	25.00'	28.49'	21.46'	4°01'59"	6°34'08"
6+25.00	25.00'	28.49'	21.46'	4°01'58"	10°36'06"
6+45.14	20.14'	22.96'	17.29'	3°14'56"	13°51'02"

		Sandcrest Addition - Phase I	
		<b>CURTIS ST</b>	
Sta. 3+33.33 to Sta. 6+45.14			
PROJECT NUMBER 472-85252	DESIGN AEG	DRAWN JAK	DATE 7/19/16
REVISIONS:	APPROVED	NOTED	SHEET
			<b>15 OF 66</b>