

**BENCHMARKS:**  
 CITY OF WICHITA BENCHMARK DISK  
 34.9' S. & 31.2' W. OF THE SW COR.,  
 NW1/4, SEC. 2, TWP. 27-S, R-1-W.  
 ELEV. = 1327.57 NAVD88

CITY OF WICHITA BENCHMARK DISK  
 26.2' S. & 46.1' W. OF THE NW COR.,  
 NW1/4, SEC. 2, TWP. 27-S, R-1-W.  
 ELEV. = 1330.50 NAVD88

CITY OF WICHITA BENCHMARK DISK  
 0.9' E. & 29' N. OF THE NE COR.,  
 NW1/4, SEC. 2, TWP. 27-S, R-1-W.  
 ELEV. = 1325.19 NAVD88

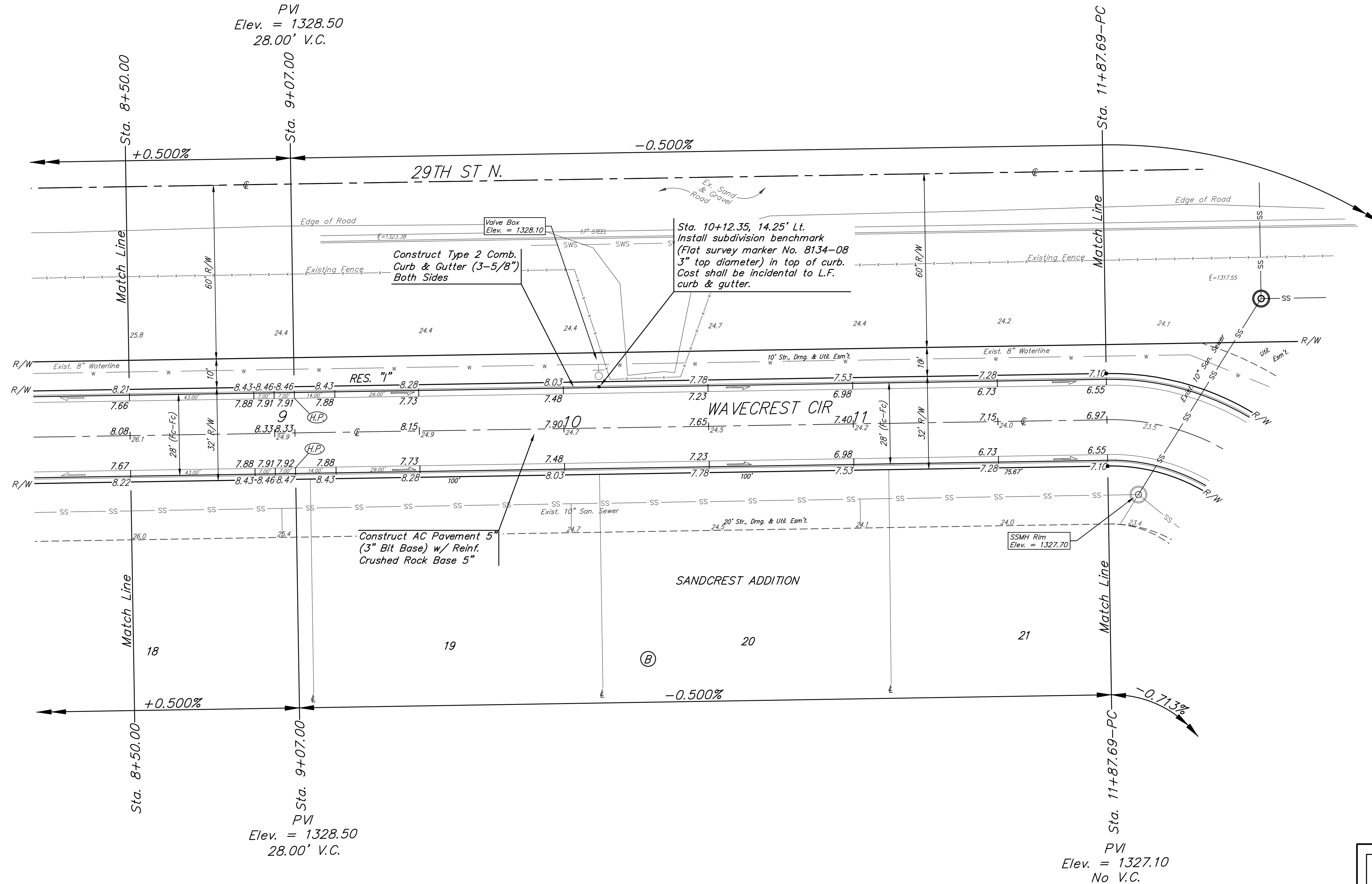
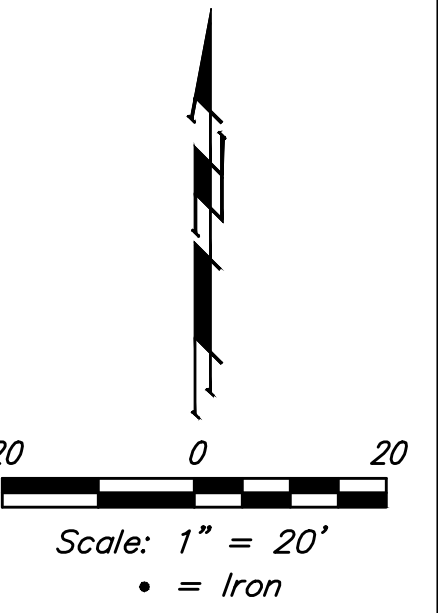

Roll type curb & gutter to be constructed on the pavement on this sheet. Top of curb elevation are given for full height curb.



	Sandcrest Addition - Phase I	
	<b>WAVECREST CIR</b>	
Sta. 8+50 to Sta. 11+87.69		
<small>Baughman Company, P.A. 315 Ellis St. Wichita, KS 67211 P 316-262-7271 F 316-262-0149        ENGINEERING   SURVEYING   PLANNING   LANDSCAPE ARCHITECTURE</small>		
PROJECT NUMBER 472-85252	DESIGN AEG	DRAWN JAK
REVISIONS:	APPROVED	DATE 7/19/16
	SCALE Noted	SHEET
		<b>21 OF 66</b>