

BENCHMARKS:
 CITY OF WICHITA BENCHMARK DISK
 34.9' S. & 31.2' W. OF THE SW COR.,
 NW1/4, SEC. 2, TWP. 27-S, R-1-W.
 ELEV. = 1327.57 NAVD88

CITY OF WICHITA BENCHMARK DISK
 26.2' S. & 46.1' W. OF THE NW COR.,
 NW1/4, SEC. 2, TWP. 27-S, R-1-W.
 ELEV. = 1330.50 NAVD88

CITY OF WICHITA BENCHMARK DISK
 0.9' E. & 29' N. OF THE NE COR.,
 NW1/4, SEC. 2, TWP. 27-S, R-1-W.
 ELEV. = 1325.19 NAVD88

Curve #12
 Curve Data Based on Face of Curb
 Rad. = 200' Delta = 24°56'36" Tangent = 44.24'
 Arc = 87.0 Chord 8' Lt. L.C. = 86.3 Chord 8' Def./Ft. = 8.59325 Min.

Station	Arc	Chord 8' Lt.	Def.	Total Def.
A	-	-	0'00"00"	0'00"00"
B	21.77'	20.89'	3'07"04"	3'07"04"
C	21.77'	20.89'	3'07"05"	6'14'09"
D	21.77'	20.89'	3'07"04"	9'21'13"
E	21.77'	20.89'	3'07"05"	12'28'18"

Curve #13
 Curve Data Based on Face of Curb
 Rad. = 294.82' Delta = 9°58'52" Tangent = 25.74'
 Arc = 51.36' L.C. = 51.29' Def./Ft. = 5.83009 Min.

Station	Arc	Chord 8' Lt.	Def.	Total Def.
E	-	-	0'00"00"	0'00"00"
F	25.68'	24.97'	2'29"43"	2'29"43"
G	25.68'	24.97'	2'29"43"	4'59'26"

Curve #14
 Curve Data Based on Face of Curb
 Rad. = 253.57' Delta = 20°15'02" Tangent = 45.28'
 Arc = 89.51' L.C. = 89.16' Def./Ft. = 6.78714 Min.

Station	Arc	Chord 8' Rt.	Def.	Total Def.
H	-	-	0'00"00"	0'00"00"
I	9.90'	10.22'	1'07"12"	1'07"12"
J	23.63'	24.40'	2'40"22"	3'47'34"
K	27.82'	28.72'	3'08'49"	6'56'23"
L	28.16'	29.07'	3'11'08"	10'07'31"

Curve #15
 Curve Data Based on Face of Curb
 Rad. = 220' Delta = 5°53'06" Tangent = 11.31'
 Arc = 22.60' L.C. = 22.59' Def./Ft. = 7.81195 Min.

Station	Arc	Chord 8' Lt.	Def.	Total Def.
M	-	-	0'00"00"	0'00"00"
N	22.60'	23.41'	2'56'33"	2'56'33"

Curve #16
 Curve Data Based on Face of Curb
 Rad. = 270.5' Delta = 11°43'01" Tangent = 27.76'
 Arc = 55.32' L.C. = 55.22' Def./Ft. = 6.35409 Min.

Station	Arc	Chord 8' Lt.	Def.	Total Def.
N	-	-	0'00"00"	0'00"00"
O	27.66'	26.83'	2'55'45"	2'55'45"
P	27.66'	26.83'	2'55'45"	5'51'30"

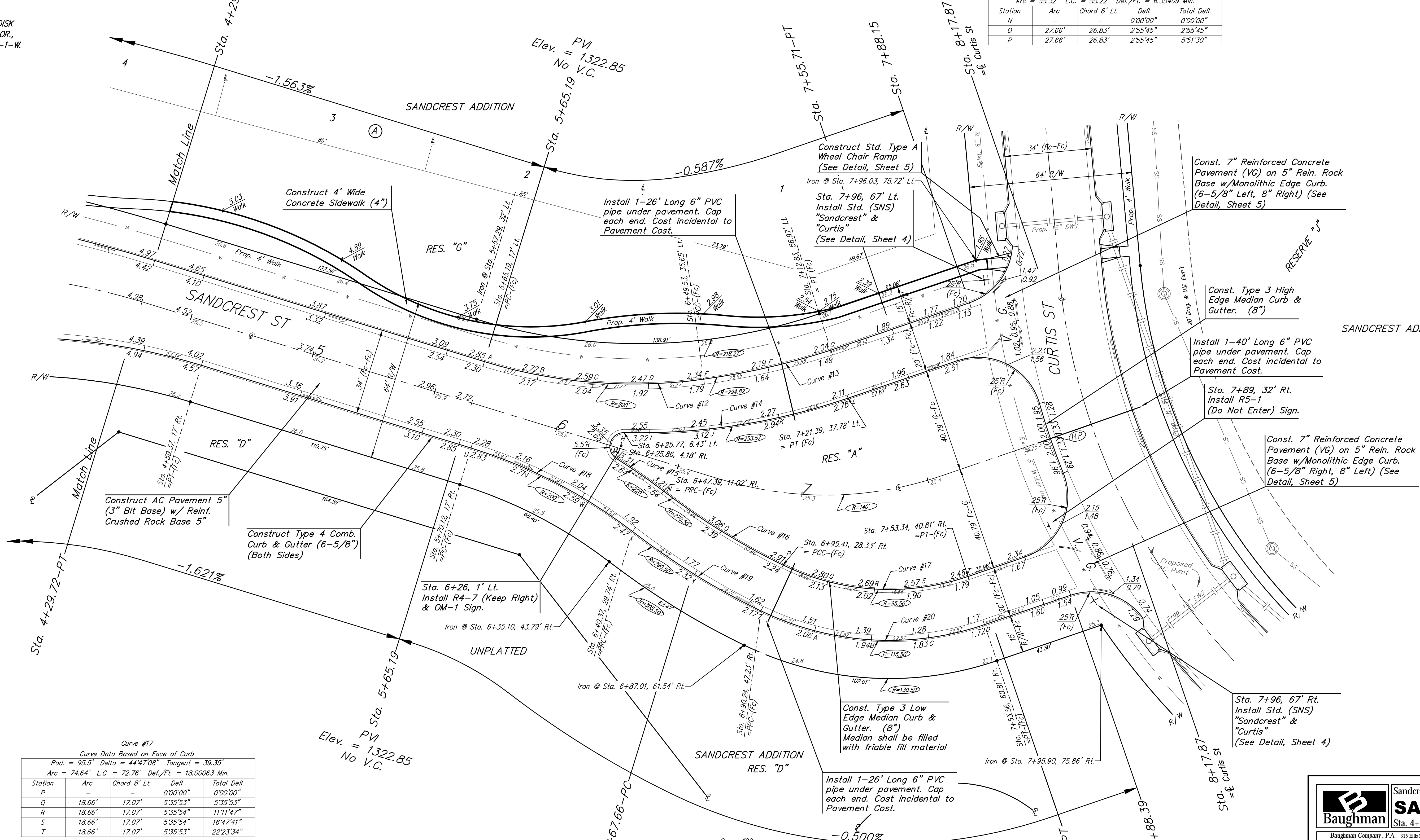
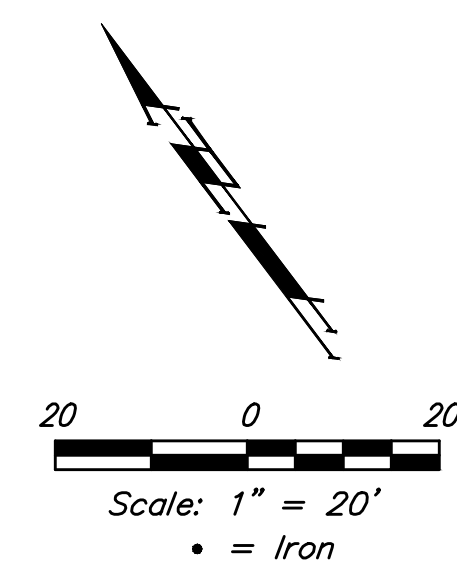

Curve #17
 Curve Data Based on Face of Curb
 Rad. = 95.5' Delta = 44°47'08" Tangent = 39.35'
 Arc = 74.64' L.C. = 72.76' Def./Ft. = 18.00063 Min.

Station	Arc	Chord 8' Lt.	Def.	Total Def.
P	-	-	0'00"00"	0'00"00"
Q	18.66'	17.07'	5'35"53"	5'35"53"
R	18.66'	17.07'	5'35"54"	11'11'47"
S	18.66'	17.07'	5'35"54"	16'47'41"
T	18.66'	17.07'	5'35"53"	22'23'34"

Curve #18
 Curve Data Based on Face of Curb
 Rad. = 200' Delta = 20°33'50" Tangent = 36.28'
 Arc = 71.79' L.C. = 71.40' Def./Ft. = 8.59335 Min.

Station	Arc	Chord 8' Rt.	Def.	Total Def.
U	-	-	0'00"00"	0'00"00"
V	23.93'	22.96'	3'25"38"	3'25"38"
W	23.93'	22.96'	3'25"39"	6'51'17"
X	23.93'	22.96'	3'25"38"	10'16'55"

Curve #19
 Curve Data Based on Face of Curb
 Rad. = 290.5' Delta = 11°43'01" Tangent = 29.81'
 Arc = 59.40' L.C. = 59.30' Def./Ft. = 5.91765 Min.

Station	Arc	Chord 8' Rt.	Def.	Total Def.
X	-	-	0'00"00"	0'00"00"
Y	29.70'	30.51'	2'55'45"	2'55'45"
Z	29.70'	30.51'	2'55'45"	5'51'30"

Curve #20
 Curve Data Based on Face of Curb
 Rad. = 115.5' Delta = 44°47'08" Tangent = 47.59'
 Arc = 90.2 Chord 8' L.C. = 88.00' Def./Ft. = 14.88222 Min.

Station	Arc	Chord 8' Rt.	Def.	Total Def.
Z	-	-	0'00"00"	0'00"00"
A	22.57'	24.10'	5'35"53"	5'35"53"
B	22.57'	24.10'	5'35"54"	11'11'47"
C	22.57'	24.10'	5'35"54"	16'47'41"
D	22.57'	24.10'	5'35"53"	22'23'34"

Baughman Sandcrest Addition - Phase I
SANDCREST
 Sta. 4+29.72 to Sta. 8+17.87

Baughman Company, P.A. 315 Ellis St. Wichita, KS 67211 P 316-262-7271 F 316-262-0149
 ENGINEERING | SURVEYING | PLANNING | LANDSCAPE ARCHITECTURE

PROJECT NUMBER 472-85252	DESIGN AEG	DRAWN JAK
REVISIONS:	APPROVED	DATE 7/19/16
	SCALE Noted	SHEET 8 OF 66

E:\Projects\Pearl Beach, LLC\F860\Engineering\Phase I\Sta 1510E318\STR Plans.dwg

