

**BENCHMARKS:**  
 Chiseled square on top of catch basin, 43.5' N. & 20.4' W. of the northwest corner of Lot 24, Block B, Vassar Addition.  
 Elev. = 1259.55 NGVD29

Chiseled cross on top of catch basin, 48.2' N. & 41.2' W. of the northeast corner of Lot 37, Block B, Vassar Addition.  
 Elev. = 1258.46 NGVD29

Chiseled cross on walk, most easterly corner, (block corner), Lot 4, Block D, Clifton Cove Addition, 35.2' W. & 8.5' S. of the northwest corner, Lot 20, Block B, Vassar Addition.  
 Elev. = 1258.62 NGVD29

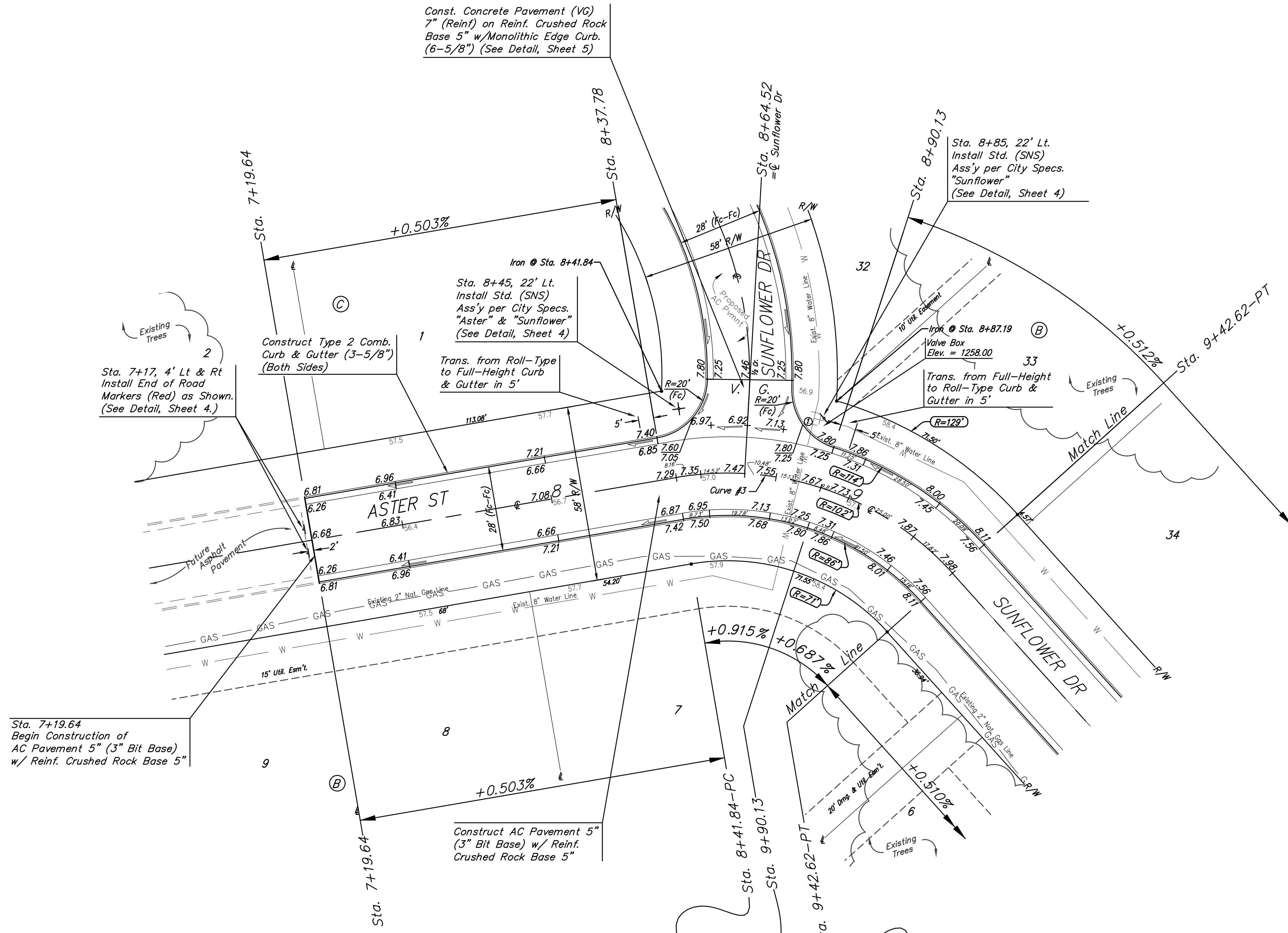
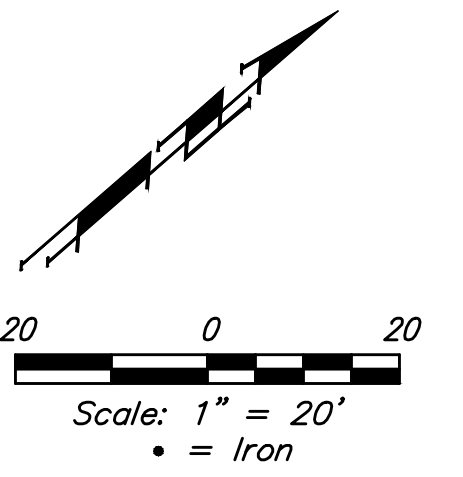

Sta. 7+19.64  
 Begin Construction of  
 AC Pavement 5" (3" Bit Base)  
 w/ Reinf. Crushed Rock Base 5"

Const. Concrete Pavement (VG)  
 7" (Reinf) on Reinf. Crushed Rock  
 Base 5" w/Monolithic Edge Curb.  
 (6-5/8") (See Detail, Sheet 5)

Sta. 7+17, 4' Lt & Rt  
 Install End of Road  
 Markers (Red) as Shown.  
 (See Detail, Sheet 4.)

Iron @ Sta. 8+41.84  
 Sta. 8+45, 22' Lt.  
 Install Std. (SNS)  
 Ass'y per City Specs.  
 "Aster" & "Sunflower"  
 (See Detail, Sheet 4)

Trans. from Roll-Type  
 to Full-Height Curb  
 & Gutter in 5'

Sta. 8+85, 22' Lt.  
 Install Std. (SNS)  
 Ass'y per City Specs.  
 "Sunflower"  
 (See Detail, Sheet 4)

Iron @ Sta. 8+87.19  
 Valve Box  
 Elev. = 1258.00  
 Trans. from Full-Height  
 to Roll-Type Curb &  
 Gutter in 5'

Curve #3  
 Curve Data Based on Centerline  
 Rad. = 100' Delta = 57°44'32" Tangent = 55.14'  
 Arc = 100.78' L.C. = 96.57' Def./Ft. = 17.18860 Min.

| Station | Arc    | Chord   |          | Defl.    | Total Defl. |
|---------|--------|---------|----------|----------|-------------|
|         |        | 8' Left | 8' Right |          |             |
| 8+41.84 | -      | -       | -        | 0'00'00" | 0'00'00"    |
| 8+50.00 | 8.16'  | 9.95'   | 6.36'    | 2'20'16" | 2'20'16"    |
| 8+75.00 | 25.00' | 30.42'  | 19.45'   | 7'09'42" | 9'29'58"    |
| 8+90.13 | 15.13' | 18.44'  | 11.79'   | 4'20'04" | 13'50'02"   |
| 9+00.00 | 9.87'  | 12.04'  | 7.70'    | 2'49'39" | 16'39'41"   |
| 9+25.00 | 25.00' | 30.42'  | 19.45'   | 7'09'43" | 23'49'24"   |
| 9+42.62 | 17.62' | 21.47'  | 13.73'   | 5'02'52" | 28'52'16"   |

PVI  
 Elev. = 1257.42  
 No V.C.

PVI  
 Elev. = 1257.80  
 No V.C.

PVI  
 Elev. = 1258.11  
 No V.C.

Type 2 Comb. Curb & Gutter (3-5/8")  
 to be constructed on the pavement  
 on this sheet. Top of curb elevation  
 are given for full height curb (6-5/8").



|   |                         |                              |                 |
|---|-------------------------|------------------------------|-----------------|
| <b>Baughman</b>   |                         | Vassar Addition - Phase I    |                 |
|   |                         | <b>ASTER ST</b>              |                 |
|   |                         | Sta. 7+19.64 to Sta. 9+42.62 |                 |
| Baughman Company, P.A. 315 Ellis St. Wichita, KS 67211 P 316-262-7271 F 316-262-0149<br>ENGINEERING   SURVEYING   PLANNING   LANDSCAPE ARCHITECTURE |                         |                              |                 |
| PROJECT NUMBER<br>472-83256   | DESIGN<br>AEG           | DRAWN<br>JAK                 | DATE<br>7/05/16 |
| REVISIONS:  | SCALE<br>Noted<br>SHEET |                              |                 |
|   |                         |                              | <b>9 OF 25</b>  |