

50.00'  
EXC = 40.1  
LF = 1.2  
CF = 1.9

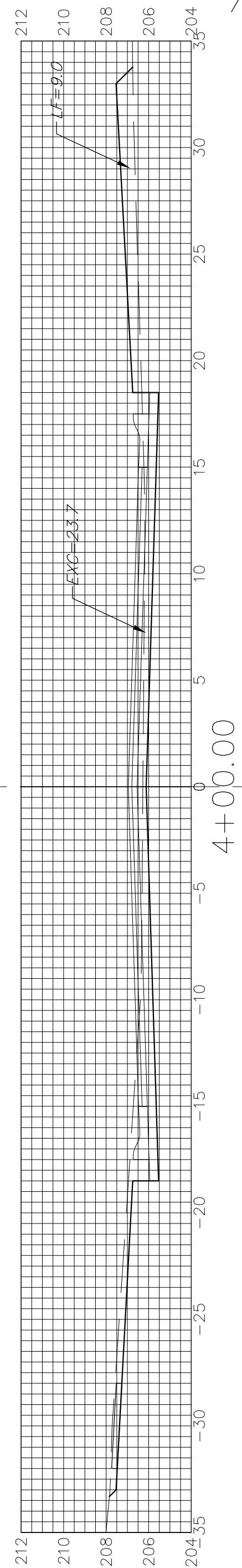

4+00.00

50.00'  
EXC = 45.4  
LF = 10.6  
CF = 0.0

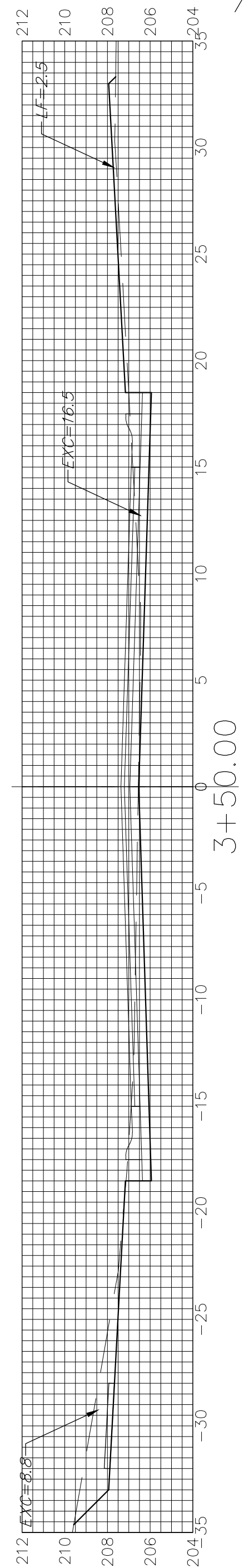

3+50.00

50.00'  
EXC = 148.0  
LF = 2.3  
CF = 0.0

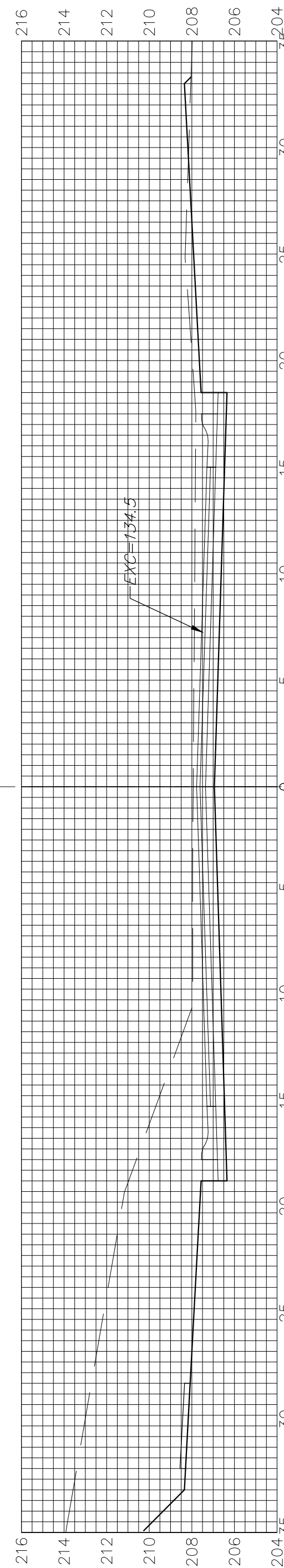

3+00.00

50.00'  
EXC = 338.1  
LF = 0.0  
CF = 0.0

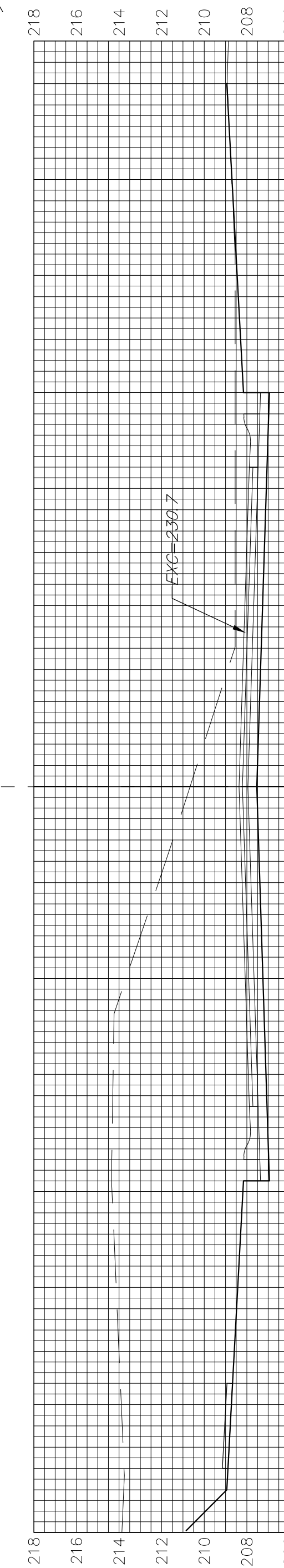

2+50.00

50.00'  
EXC = 462.1  
LF = 2.8  
CF = 0.0

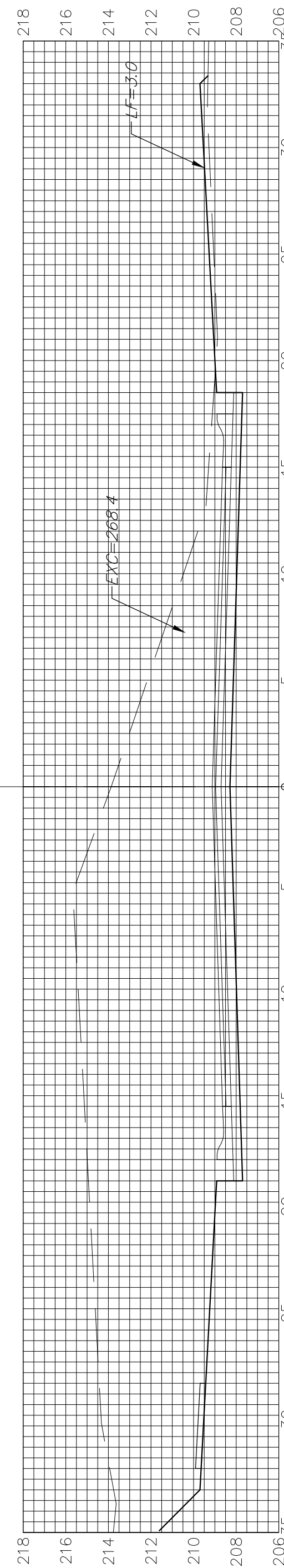

2+00.00

50.00'  
EXC = 398.4  
LF = 6.7  
CF = 0.0

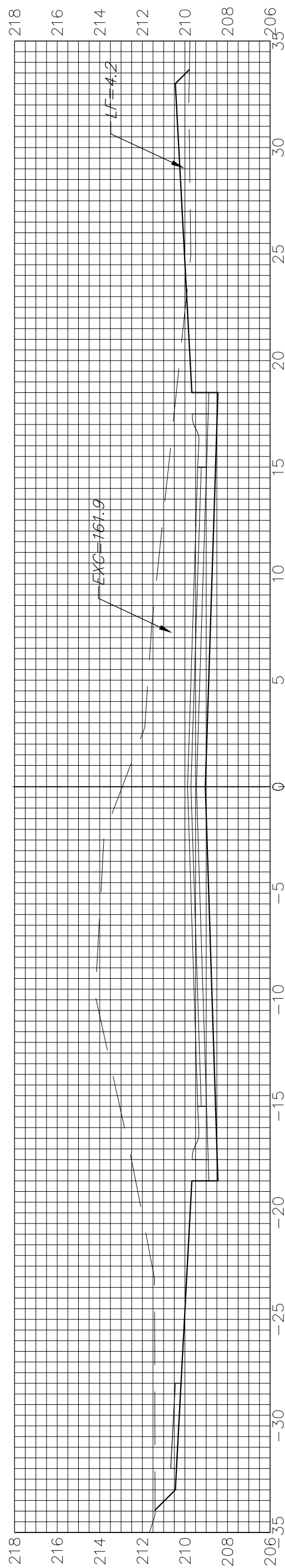

1+50.00

50.00'  
EXC = 229.9  
LF = 4.3  
CF = 0.0

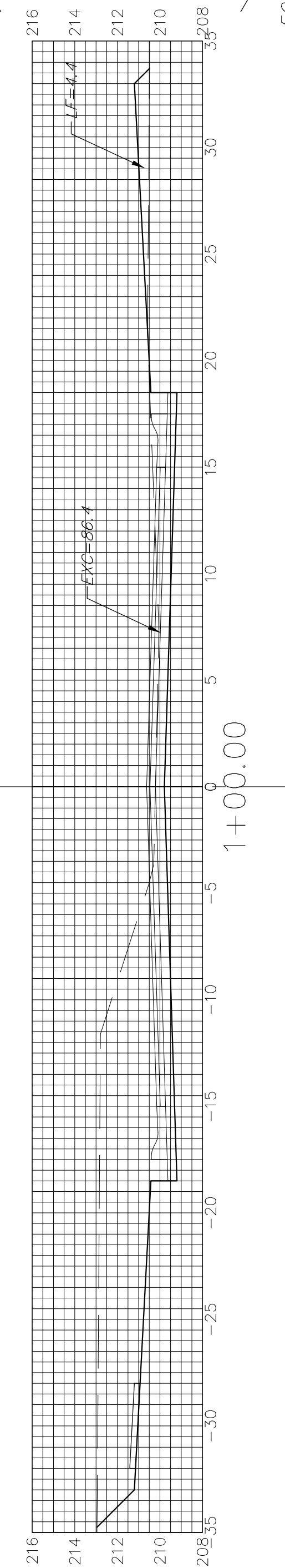

1+00.00

50.00'  
EXC = 133.1  
LF = 13.3  
CF = 0.0

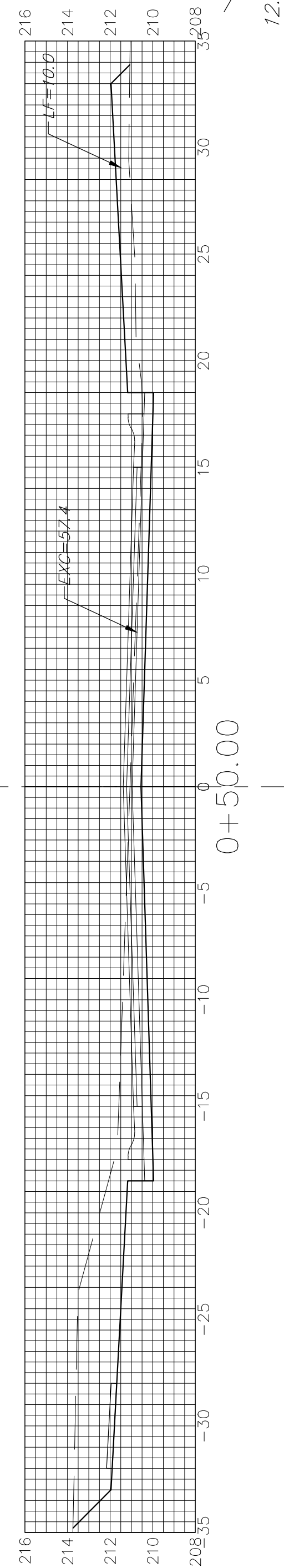

0+50.00

12.75'  
EXC = 23.4  
LF = 3.7  
CF = 0.0

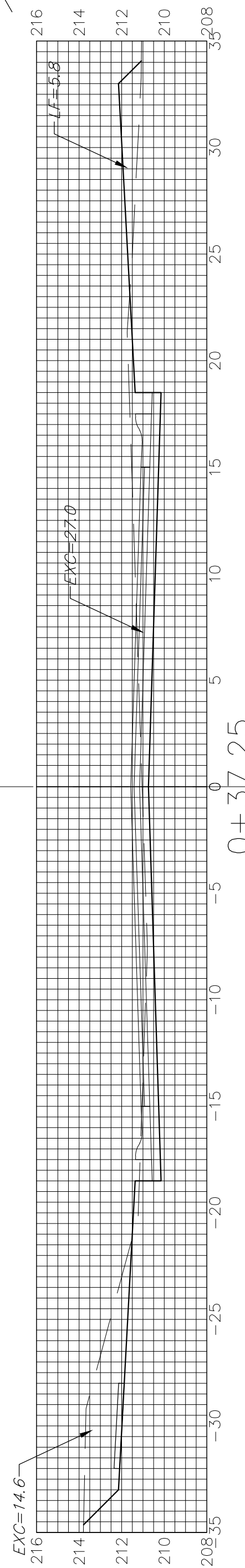

0+37.25

ONE WOOD  
Q

Sheet Totals  
Excavation = 1,818.5 C.Y.  
Loose Fill = 44.9 C.Y.  
Compacted Fill = 1.9 C.Y.

