

STATE	PROJECT NO.	YEAR	SHEET NO.	TOTAL SHEETS
KANSAS	87 N-0597-01	2016	112	191

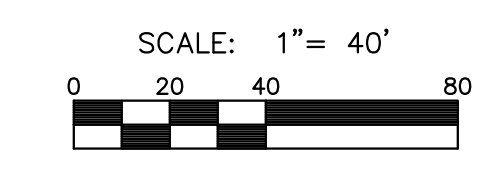

STREET IMPROVEMENTS FOR:
PAWNEE AVENUE
 FROM HYDRAULIC TO POPLAR
 WICHITA, KANSAS

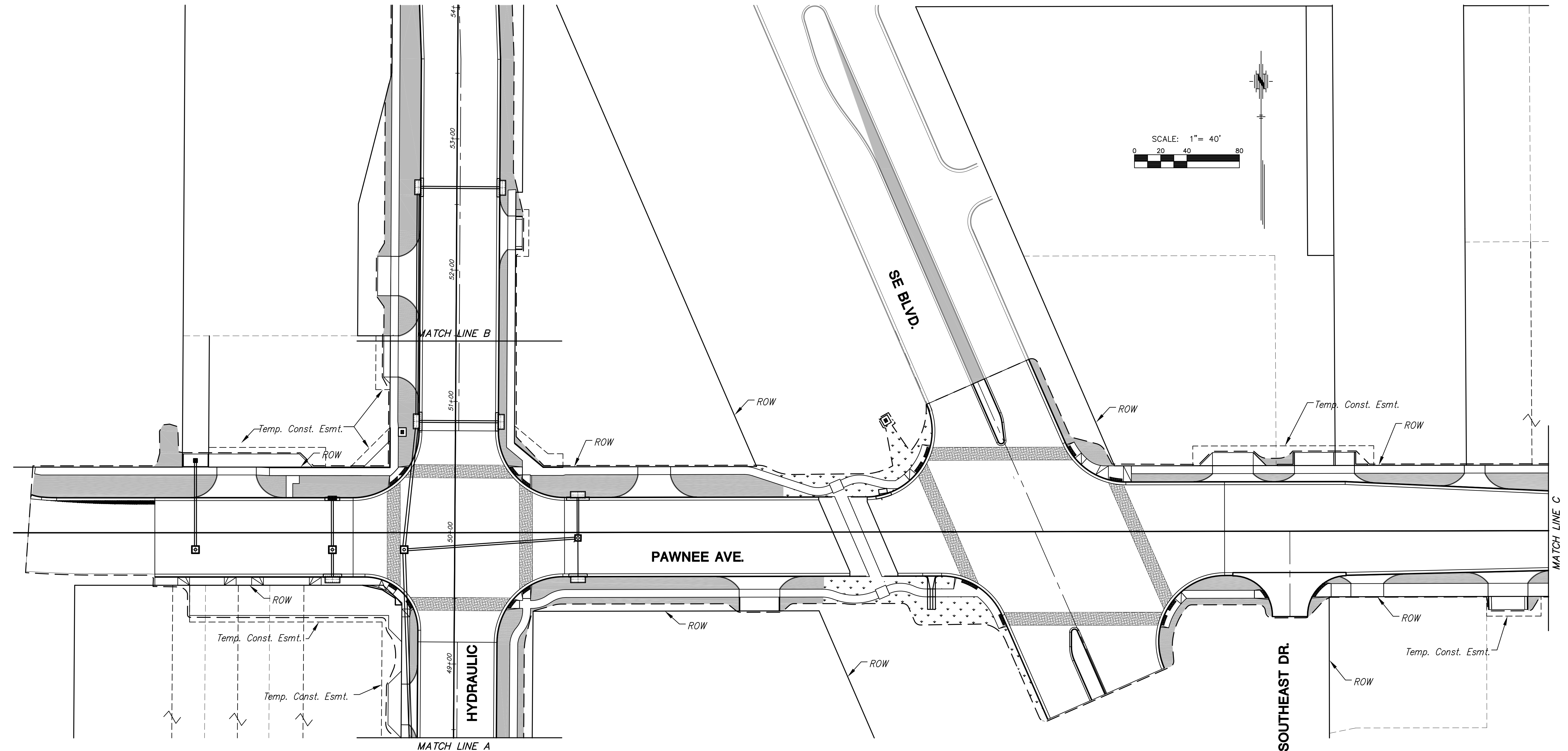

LEGEND

- STANDARD SEED AREAS
- SOD, MATCH EXISTING TYPE
- RIP RAP, LIGHT STONE
- BRICK PAVERS or PAVED MEDIAN
- STAMPED, CONCRETE
- CONSTRUCTION LIMITS (LIMITS OF SITE RESTORATION)
- TEMPORARY CONST. EASEMENT
- RIGHT OF WAY/PROPERTY LINE

SUMMARY OF LIGHT-STONE RIPRAP QUANTITIES	
STATION	QUANTITY (S.Y.)
SWS LINE 18, STA. 39+03.81	36.00
PROJECT TOTAL	36.00

ROADSIDE IMPROVEMENTS SUMMARY (FOR INFORMATION ONLY)	
PROJECT PORTION	AREA (AC)
PROJECT TOTAL SEED	0.32
PROJECT TOTAL SOD	1.50

©2013 MKEC Engineering All Rights Reserved www.mkec.com These drawings and their contents, including, but not limited to, all concepts, designs, & ideas are the exclusive property of MKEC Engineering (MKEC), and may not be used or reproduced in any way without the express consent of MKEC.

ROADSIDE IMPROVEMENT PLANS

PROJECT NO.	87 N-0597-01	
DATE	DATE	
SCALE	1"=40'	
DESIGNED	DRAWN	CHECKED
JRA	JSB	JRA
NO.	REVISION	DATE

PLOTTED: Monday, May 09, 2016 @ 8:07PM
 J:\CIVIL\05745\ROAD\IMP\05745_RH-1.DWG