

GENERAL NOTES

- Conduit shall be jacked or bored under existing pavement and under new pavement that has been placed prior to conduit installation.
- Placement of Service/Junction Boxes, Conduit Runs and Controller are typical and may be adjusted as directed by the Engineer to facilitate installation.
- The Contractor shall contact utility companies which may be affected by the installation of Traffic Signalization prior to any construction.
- Westar Power Pole Baseline Sta. 22+62.83, 42.5' Lt. Install Meter and Power Disconnect.
- Contractor shall install a 1" rigid galvanized conduit from the pole located at Sta. 22+62.83, 42.5' Lt., to the traffic signal controller located at Sta. 23+76.99, 38.5' Rt., to carry the metered conductor from the meter to the traffic signal controller.
- The Contractor shall install and operate a Temporary Pedestrian Traffic Signal at this location. The Contractor shall prepare plans for Temporary Traffic Signals in consultation with the Traffic Engineer and in conformance with the Contractor's Traffic Control Plan. Notify City of Wichita Traffic Maintenance 7-days prior to signal turn-on.
- See Signal Pole Details for additional Traffic Signal Structures requirement.
- See Pavement Marking Plan for pavement marking lay-out.
- New signal shall utilize existing signal timings. Contractor shall coordinate with Lee Carmichael, Wichita Assistant Traffic Engineer at 268-4501.

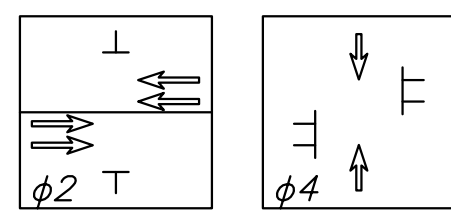

PAWNEE SIGNAL PHASING

TRAFFIC SIGNAL POLE SUMMARY (CHART B)								
POLE NO.	STATION	TYPE	ARM LENGTH	SIGNALS ON ARM	X1	X2	X3	SIGNALS/EQUIPMENT ON POLE
18	23+63.55, 38.5' Lt.	A	28'	2-D	11'			2-D, 1-E
19	23+76.99, 38.5' Rt.	A	28'	2-D	11'			1-C, 2-D, 1-E

- A - Standard Steel Pole with Mast Arm
- B - Pedestal Pole (15' Aluminum)
- C - Controller with Cabinet
- D - Traffic Signal
- E - Pedestrian Signal with Push Button

BILL OF MATERIALS (For Information Only)		
ITEM	UNIT	QUANT.
PEDESTAL MOUNTED CONTROLLER & CABINET	EACH	1
TRAFFIC SIGNAL HEAD (SEE CHART A) W/MOUNTING HARDWARE	EACH	10
TRAFFIC SIGNAL POLE (SEE CHART B) STEEL	EACH	2
CONCRETE FOOTING - POLE	EACH	2
CONDUIT ELBOW 90	EACH	AS NEEDED
CONDUIT ELBOW 90 3"	EACH	AS NEEDED
SERVICE BOX	EACH	2
GROUND ROD & CLAMP	EACH	3
TRAFFIC SIGNAL LAMP RED LED KIT	EACH	6
TRAFFIC SIGNAL LAMP YELLOW LED KIT	EACH	6
TRAFFIC SIGNAL LAMP GREEN LED KIT	EACH	6
TRAFFIC SIGNAL LAMP LED (12" COMBINATION)	EACH	2
TRAFFIC SIGNAL LAMP LED (30" NO RIGHT TURN)	EACH	2
ENTRANCE HEAD	EACH	1
CIRCUIT BREAKER & BOX 70 AMP	EACH	1
PEDESTRIAN PUSHBUTTON W/SIGN	EACH	2
LEAD-IN-WIRE NO 6 A.W.G. 1/C	L.F.	420
STRANDED NO. 8 A.W.G. 1/C (TYPE THHN)(GROUND)	L.F.	410
MULTI-CONDUCTOR CABLE NO. 14 A.W.G. 2/C	L.F.	30
MULTI-CONDUCTOR CABLE NO. 14 A.W.G. 5/C	L.F.	225
MULTI-CONDUCTOR CABLE NO. 14 A.W.G. 7/C	L.F.	230
CONDUIT 3" (RG)	L.F.	90
CONDUIT 2" (RG)	L.F.	25
CONDUIT 1" (RG)	L.F.	110
REMOVAL OF EXISTING TRAFFIC CONTROL EQUIPMENT**	EACH	1

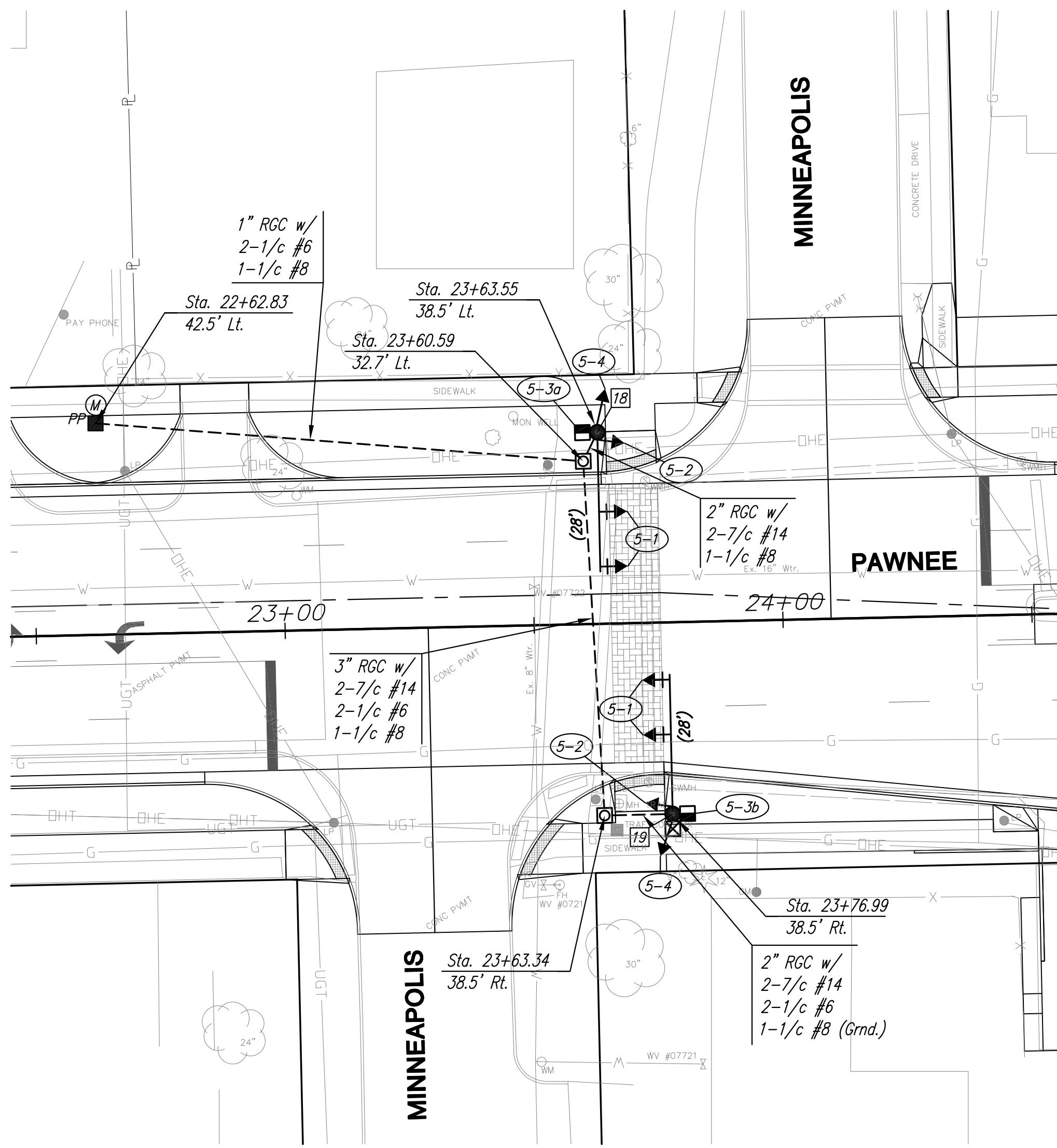

PAWNEE PEDESTRIAN CROSSING

EQUIPMENT SPECIFICATIONS 2070 CONTROLLER

- A. Controller Units: The 2070L controllers supplied shall meet the requirements:
 - The 2070L controllers shall have a 19" EIA rack mountable chassis(mated to the 170 cabinet). Controllers shall be EAGLE or ECONOLITE.
 - 2070-1B CPU module with RJ-45 Ethernet port.
 - 2070-2A C1 field I/O module for compatibility with CalTrans style C1 connector.
 - 2070-3B 8x40 front panel with LCD display.
 - 2070-4A 10 amp power supply.
 - 2070-7A asynchronous serial communications module (RS-232)
 - Any unused slot position shall have a cover plate.
- B. Conflict Monitors:
 - The Conflict Monitors supplied shall be 2010 ECL conflict Monitors.
- C. 1-Loop-back cable for 2070-2A Field I/O (Type 170, 104 pin and 37 pin connector).
- D. 1-Loop-back cable for 2070-7a port

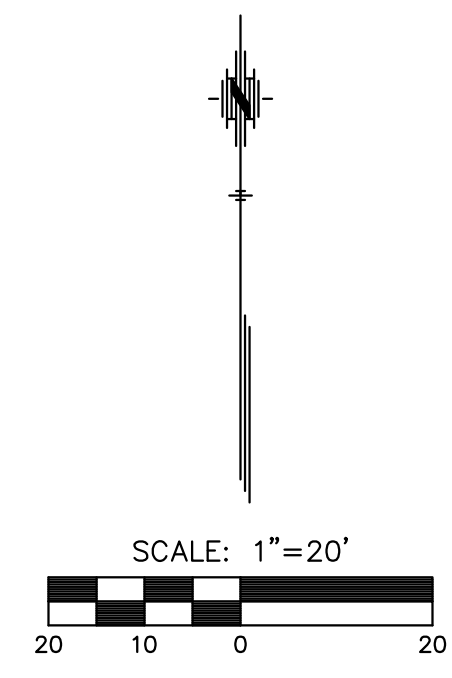

STATE	PROJECT NO.	YEAR	SHEET NO.	TOTAL SHEETS
KANSAS	87 N-0597-01	2016	123	191

LEGEND

- Steel Traffic Signal Pole (Std. Pole)
- ➔ Traffic Signal Indication (Type A) w/Backplate
- ⬇ Mast Arm Suspended Traffic Signal
- Service Box
- ▣ Pedestrian Indication
- Rigid Galvanized Conduit (RGC)
- Power Pole
- ⊗ Meter Box and Power Disconnect
- ⊠ Controller

NOTE: The contractor shall supply and install all necessary materials and equipment for the complete installation and operation of the traffic signal system whether specifically mentioned or not.

- * Subscript "P" indicates programmed signals.
- * Subscript "D" indicates dual-mode green/yellow arrow section.
- ** Removal of existing traffic signal equipment shall include removal of foundations, service boxes, and junction boxes. See construction traffic control regarding removal of existing signals.

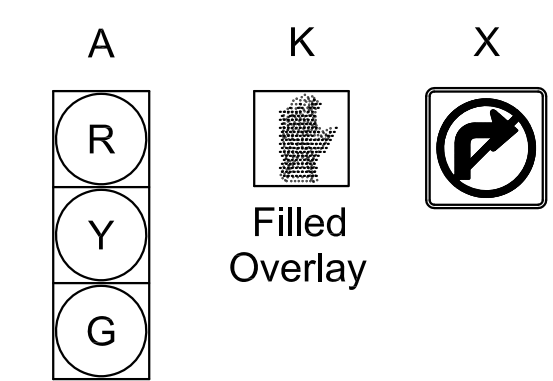
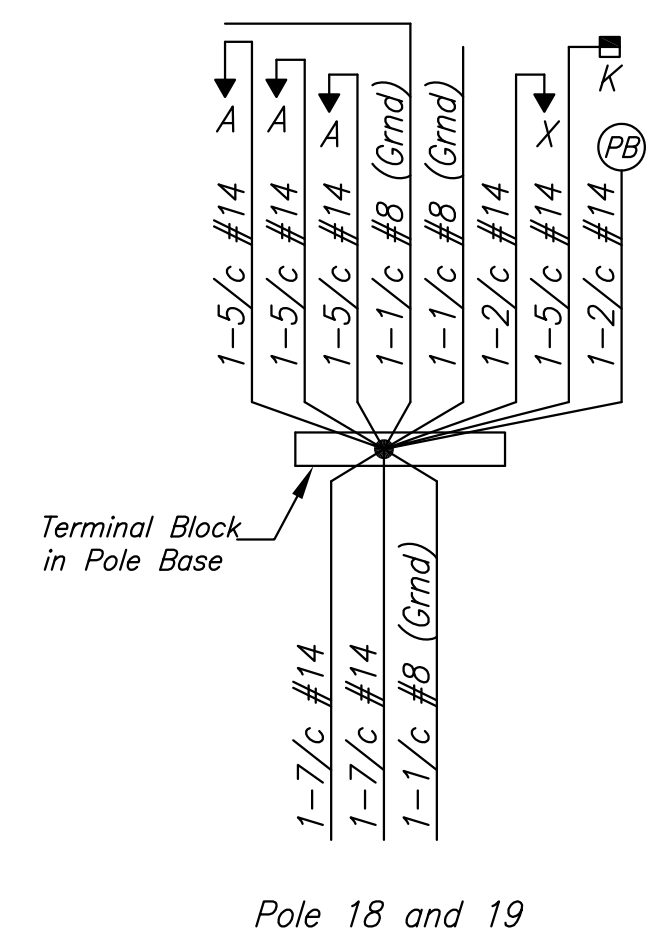

12" LED lenses - vehicular and pedestrian

TRAFFIC SIGNAL HEAD SUMMARY (CHART A)

SIGNAL NO.	TYPE	SIZE	MOUNTING BRACKET	QUANTITY
5-1	A	3-12"	TYPE I	4
5-2	A	3-12"	TYPE III	2
5-3	K	1-12"	TYPE III	2
5-4	X	1-30"	TYPE III	2

One Type IV Bracket will support 1 Type A and 1 Type K Signal Head.
All Signal Heads to be L.E.D.



STREET IMPROVEMENTS FOR:
PAWNEE AVENUE
FROM HYDRAULIC TO POPLAR
WICHITA, KANSAS

©2013 MKEC Engineering All Rights Reserved
 www.mkec.com
 These drawings and their contents, including, but not limited to, all concepts, designs, & ideas are the exclusive property of MKEC Engineering (MKEC), and may not be used or reproduced in any way without the express consent of MKEC.

PAWNEE AVE. PEDESTRIAN SIGNAL PLANS

PROJECT NO.	87 N-0597-01	
DATE	DATE	
SCALE	1"=20'	
DESIGNED	DRAWN	CHECKED
JRA	JSB	JRA
NO.	REVISION	DATE