

**INDEX OF SHEETS**

SHEET NO	DESCRIPTION
1	TITLE SHEET
2	GENERAL NOTES
3-4	RIGHT-OF-WAY & EASEMENT PLAN
5-10	TYPICAL SECTIONS
11-22	PAVING PLANS
23-25	PAVING BUBBLE MAPS
26	UTILITY KEY MAP
27	STORM SEWER SUMMARY SHEET
28-36	STORM SEWER PLAN AND PROFILES
37-39	STORM SEWER BUBBLE MAPS
40-67	PAVING DETAILS & INTERSECTION PLANS
68-82	STORM SEWER DETAILS
83	MISCELLANEOUS DETAILS
84-90	SANITARY SEWER PLAN/PROFILE & DETAILS
91-101	WATER SYSTEM DETAILS
102-104	SUMMARY & RECAPITULATION QUANTITIES
105-111	EROSION CONTROL PLANS & DETAILS
112-114	ROADSIDE IMPROVEMENT PLANS
115-126	TRAFFIC SIGNAL PLANS & DETAILS
127-135	PAVEMENT MARKING/SIGNING PLANS & DETAILS
136	CONSTRUCTION SEQUENCE SUMMARY
137-168	TRAFFIC CONTROL PLANS & DETAILS
169-191	CROSS SECTIONS

**STATE OF KANSAS**  
**DEPARTMENT OF TRANSPORTATION**  
**PLAN AND PROFILE OF PROPOSED**  
**PAWNEE AVENUE**  
**FROM HYDRAULIC TO POPLAR**

**FEDERAL AID PROJECT**  
**C.O.W. PROJECT NO. 472-85101**  
**PAVING O.C.A. NO. 707048**  
**WATER PROJECT NO. 448-90679**  
**SANITARY SEWER PROJECT NO. 468-85101**  
**WICHITA, SEDGWICK COUNTY, KANSAS**  
**POPULATION = 361,420**

STATE	PROJECT NO.	YEAR	SHEET NO.	TOTAL SHEETS
KANSAS	87 N-0597-01	2016	1	191

KDOT PROJ. NO. 87 N-0597-01  
 F.A. NO. STP N059(701)

GRADING  
 SURFACING  
 STORM SEWER  
 PAVEMENT MARKING  
 SEEDING

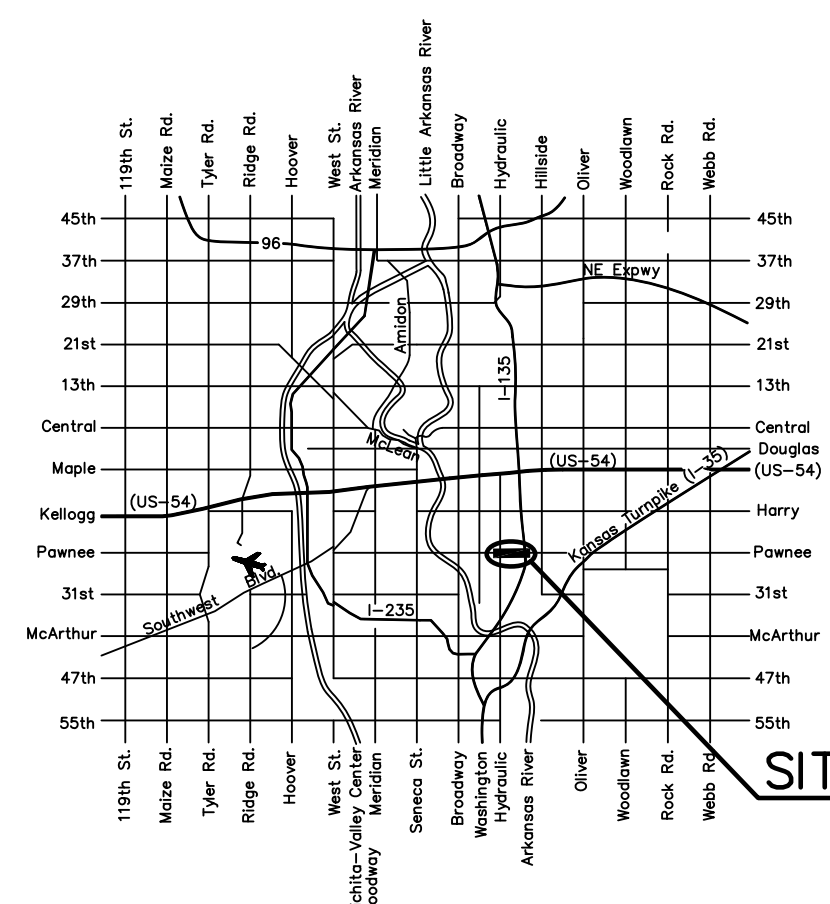

**LOCATION MAP**

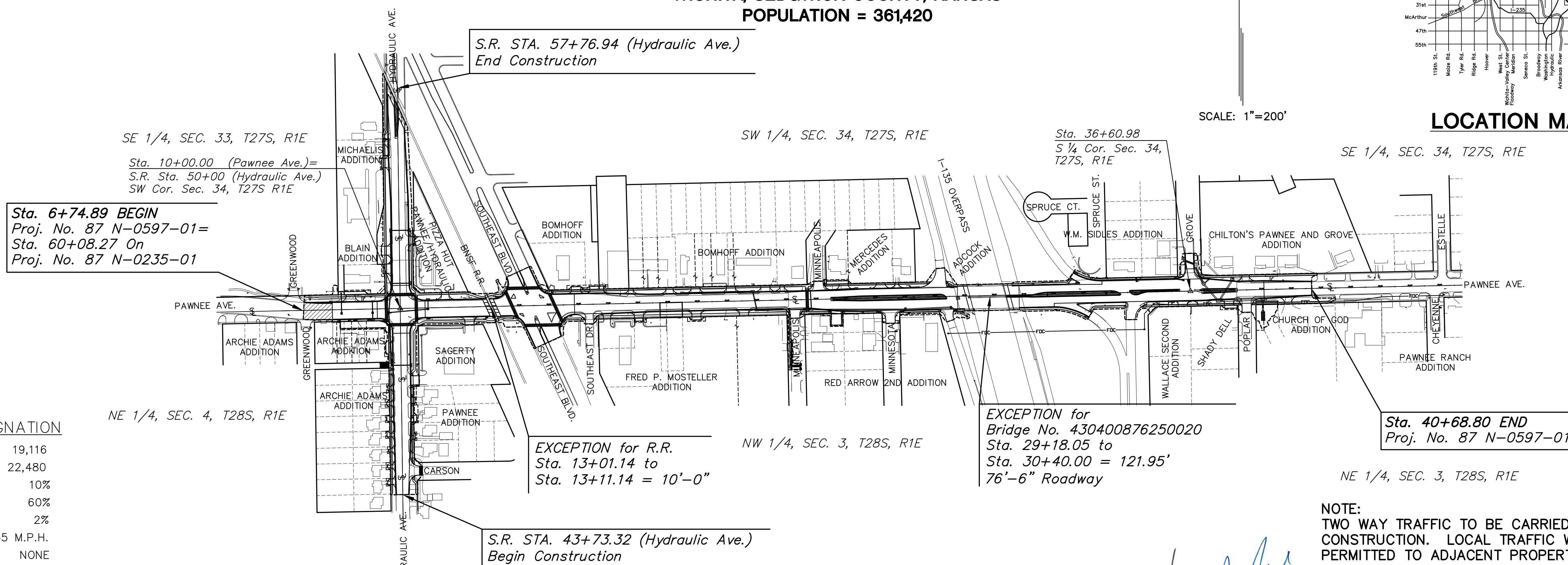

**DESIGN DESIGNATION**

AADT (2012)	19,116
AADT (2020)	22,480
DHV	10%
D	60%
T	2%
V	35 M.P.H.
C of A	NONE
Clear Zone	6'

COUNTY LINE	---	CENTER LINE OF PROJECT	—+—
CITY LIMITS	----	TERRACE	
STATE OR NATIONAL LINE	-----	CULVERTS	—X—
TOWNSHIP, SECTION or GRANT LINE	-----	DROP INLET & STORM SEWER	—X—
PROPERTY LINE	-----	ACCESS CONTROL	—X—
HIGHWAY FENCE	-----	POWER POLE	—X—
EXISTING FENCE	-----	TELEPHONE POLE	—X—
GUARD FENCE	-----	MARSH	—X—
CONSTRUCTION LIMITS	-----	HEDGE	—X—
RIGHT OF WAY LINE	-----	TREES	—X—
TRAVELED WAY	-----	PROFILE ELEVATION	—X—
RAILROADS	-----	STREAM OR CREEK	—X—

GROSS LENGTH OF PROJECT	3,393.91 FT.	
EXCEPTIONS	131.95 FT.	
ADDITIONS	0.00 FT.	
NET LENGTH OF PROJECT	3,261.96 FT.	0.618 MILES
NET LENGTH OF BRIDGES	0.00 FT.	0.000 MILES
NET LENGTH OF ROAD	3,261.96 FT.	0.618 MILES

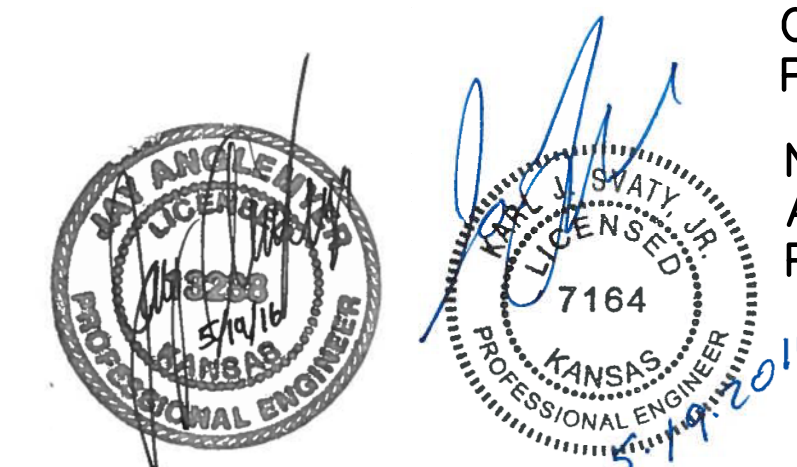

**NOTE:**  
 TWO WAY TRAFFIC TO BE CARRIED THROUGH CONSTRUCTION. LOCAL TRAFFIC WILL BE PERMITTED TO ADJACENT PROPERTIES.

**NOTE:** THE PIPES ON THIS PROJECT ARE IN ACCORDANCE WITH THE CURRENT KDOT PIPE POLICY.

PREPARED & SUBMITTED BY  
 MKEC ENGINEERING, INC.  
 WICHITA, KANSAS

APPROVED - DATE  
  
 GARY JANZEN, P.E.  
 CITY ENGINEER

STREET IMPROVEMENTS FOR:  
**PAWNEE AVENUE**  
**FROM HYDRAULIC TO POPLAR**  
 WICHITA, KANSAS

©2013 MKEC Engineering All Rights Reserved  
 These drawings and their contents, including, but not limited to, all concepts, designs, & ideas are the exclusive property of MKEC Engineering (MKEC), and may not be used or reproduced in any way without the express consent of MKEC.

TITLE SHEET	
PROJECT NO.	87 N-0597-01
DATE	5/10/2016
SCALE	AS SHOWN
DESIGNED	DRAWN
JRA	JSB
CHECKED	JRA
NO.	REVISION
	DATE
SHEET NO.	
1 OF 191	