

STATE	PROJECT NO.	YEAR	SHEET NO.	TOTAL SHEETS
KANSAS	87 N-0597-01	2016	3	191

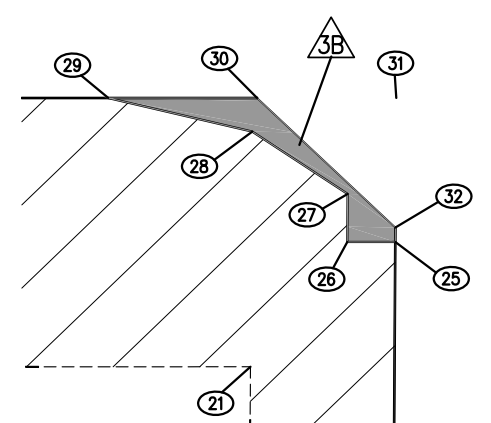
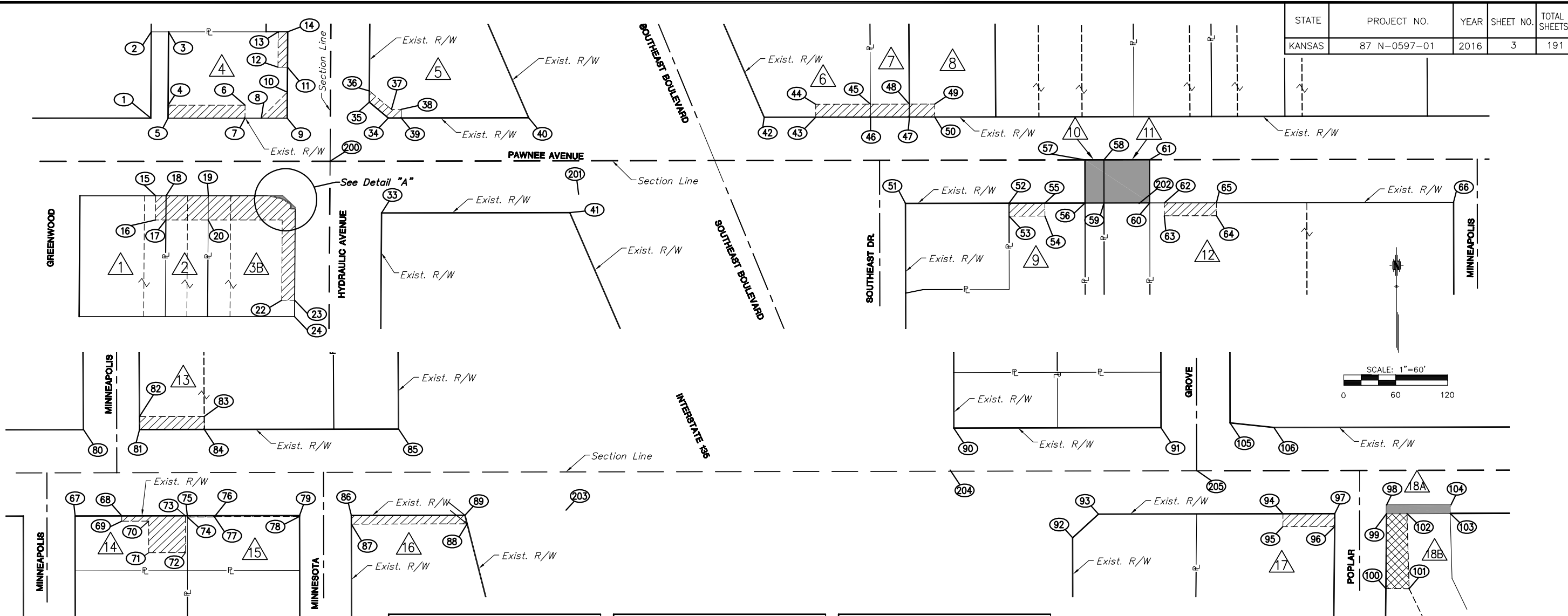

DETAIL "A"

PT. NO.	NORTHING	EASTING	REMARKS
1	1672760.2734	1654773.3850	TCE/ROW
2	1672860.2654	1654771.9777	ROW
3	1672860.6704	1654791.9740	ROW/TCE
4	1672775.6772	1654793.1702	TCE
5	1672760.6784	1654793.3813	TCE
6	1672777.4828	1654882.3032	TCE
7	1672762.4840	1654882.5143	ROW/TCE
8	1672762.8658	1654901.3618	ROW/TCE
9	1672763.4733	1654931.3556	ROW
10	1672793.4704	1654930.9334	ROW/TCE
11	1672822.4686	1654930.5253	ROW/TCE
12	1672822.2458	1654919.5273	TCE
13	1672863.2426	1654918.9503	ROW/TCE
14	1672863.4654	1654929.9483	ROW
15	1672670.4068	1654780.8832	ROW/TCE
16	1672642.4088	1654781.2651	TCE
17	1672642.6518	1654793.2629	TCE
18	1672670.6498	1654792.8810	ROW/TCE
19	1672671.1561	1654817.8758	ROW/TCE
20	1672643.1581	1654818.2578	TCE
21	1672645.3809	1654927.9877	TCE
22	1672552.3875	1654929.2587	TCE
23	1672552.6913	1654944.2536	TCE
24	1672533.6927	1654944.5128	ROW
25	1672658.6838	1654942.8076	ROW
26	1672658.5825	1654937.8085	ROW
27	1672663.5822	1654937.7403	ROW
28	1672669.8796	1654927.6770	ROW
29	1672673.0751	1654912.6091	ROW
30	1672673.3891	1654928.1060	ROW
31	1672673.6827	1654942.6030	ROW
32	1672660.1840	1654942.7871	ROW
33	1672655.8101	1655042.8561	ROW
34	1672765.9598	1655048.4658	ROW
35	1672783.8977	1655026.0776	ROW
36	1672796.8577	1655025.8952	ROW/TCE
37	1672776.0371	1655051.8812	TCE
38	1672776.2865	1655063.2427	TCE
39	1672766.2889	1655063.4622	ROW/TCE
40	1672769.5275	1655211.0166	ROW

PT. NO.	NORTHING	EASTING	REMARKS
41	1672660.5945	1655260.8409	ROW
42	1672775.5140	1655483.7711	ROW
43	1672776.8240	1655543.4557	ROW/TCE
44	1672791.8194	1655543.0851	TCE
45	1672793.2123	1655606.5465	TCE
46	1672778.2174	1655606.9410	ROW/TCE
47	1672779.2048	1655651.9306	ROW/TCE
48	1672794.1998	1655651.5361	TCE
49	1672794.8468	1655681.0168	TCE
50	1672779.8494	1655681.2981	ROW
51	1672679.1244	1655649.3637	ROW
52	1672681.7575	1655769.3348	ROW/TCE
53	1672666.7612	1655769.6639	TCE
54	1672667.6718	1655811.1539	TCE
55	1672682.6682	1655810.8248	ROW/TCE
56	1672683.6893	1655857.3136	ROW
57	1672733.6765	1655856.2164	ROW
58	1672734.1592	1655878.2111	ROW
59	1672684.1758	1655879.3082	ROW
60	1672685.3343	1655932.2955	ROW
61	1672735.3222	1655931.1984	ROW
62	1672685.7031	1655949.0985	ROW/TCE
63	1672670.7067	1655949.4276	TCE
64	1672672.0321	1656009.8129	TCE
65	1672682.0284	1656009.4838	ROW/TCE
66	1672693.0562	1656284.1208	ROW
67	1672694.3728	1656344.1063	ROW
68	1672695.5588	1656398.1434	ROW/TCE
69	1672689.4575	1656398.2773	TCE
70	1672690.1417	1656429.4499	TCE
71	1672653.5709	1656430.2525	TCE
72	1672654.5034	1656472.7366	TCE
73	1672697.1755	1656471.8001	ROW/TCE
74	1672695.7258	1656474.1080	ROW/TCE
75	1672697.2254	1656474.0750	ROW/TCE
76	1672696.9170	1656505.5942	TCE
77	1672696.4171	1656505.6052	TCE
78	1672699.0782	1656604.0657	ROW/TCE
79	1672700.0780	1656604.0437	ROW
80	1672794.5651	1656351.7687	ROW

PT. NO.	NORTHING	EASTING	REMARKS
81	1672795.9914	1656416.7537	ROW
82	1672810.9863	1656416.3591	ROW/TCE
83	1672812.6321	1656491.3418	TCE
84	1672797.6371	1656491.7363	ROW/TCE
85	1672802.5744	1656716.6843	ROW
86	1672701.3946	1656664.0293	ROW
87	1672691.3970	1656664.2487	ROW/TCE
88	1672694.3401	1656798.3393	ROW/TCE
89	1672704.2823	1656795.5976	ROW
90	1672816.6866	1657359.6596	ROW
91	1672821.9529	1657599.6018	ROW
92	1672692.3352	1657499.8264	ROW
93	1672720.3840	1657529.2180	ROW
94	1672725.0954	1657742.9003	ROW/TCE
95	1672710.0953	1657743.0619	TCE
96	1672711.4180	1657803.0512	ROW/TCE
97	1672726.4181	1657802.8896	ROW
98	1672737.7444	1657862.7672	ROW
99	1672727.7455	1657862.8749	ROW
100	1672640.8534	1657863.8110	ROW/TCE
101	1672641.1437	1657890.7580	TCE
102	1672728.2679	1657886.4961	ROW/TCE
103	1672729.3740	1657936.5017	ROW
104	1672739.3937	1657937.3256	ROW
105	1672829.1636	1657679.4628	ROW
106	1672824.8392	1657730.4101	ROW

PT. NO.	NORTHING	EASTING	REMARKS
1	1672760.2734	1654773.3850	TCE/ROW
2	1672860.2654	1654771.9777	ROW
3	1672860.6704	1654791.9740	ROW/TCE
4	1672775.6772	1654793.1702	TCE
5	1672760.6784	1654793.3813	TCE
6	1672777.4828	1654882.3032	TCE
7	1672762.4840	1654882.5143	ROW/TCE

LEGEND

- Tract Map Number
- Point Number
- Proposed Right-of-Way
- Proposed Temporary Construction Easement
- Proposed Permanent Drainage Dedication

STREET IMPROVEMENTS FOR:
PAWNEE AVENUE
FROM HYDRAULIC TO POPLAR
WICHITA, KANSAS

©2013 MKEC Engineering
All Rights Reserved
www.mkec.com
These drawings and their contents, including, but not limited to, all concepts, designs, & ideas are the exclusive property of MKEC Engineering (MKEC), and may not be used or reproduced in any way without the express consent of MKEC.

RIGHT-OF-WAY PLAN

PROJECT NO.	87 N-0597-01	
DATE	5/10/2016	
SCALE	1"=60'	
DESIGNED	JRA	
DRAWN	JSB	
CHECKED	JRA	
NO.	REVISION	DATE
1	REVISED POINT TABLES	7/21/16
SHEET NO.		
3 OF 191		