

NOTES:

1. REFER TO KDOT STANDARDS FOR IDENTIFICATION OF SIGNS FOR HANDLING TRAFFIC THROUGH CONSTRUCTION
REFER TO KDOT STANDARDS FOR DIMENSIONS

FHWA REG NO.	STATE	PROJECT NO.	YEAR	SHEET NO.	TOTAL SHEETS
7	KANSAS	87 N-0198-01	2001	57	82

FED. AID NO. - CMQ-N019(801)

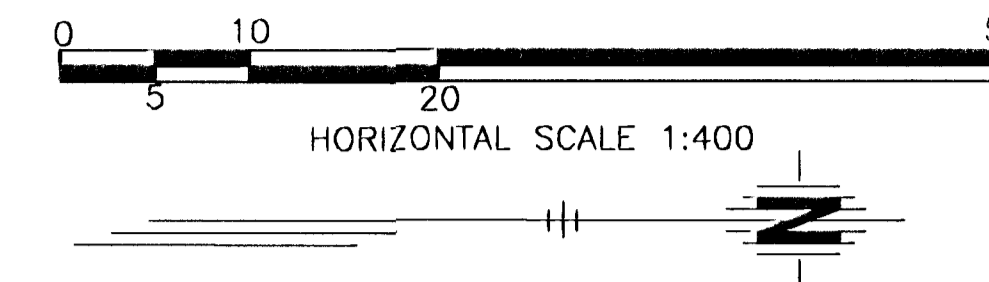

ROCK ROAD TRAFFIC_CTRL.DWG

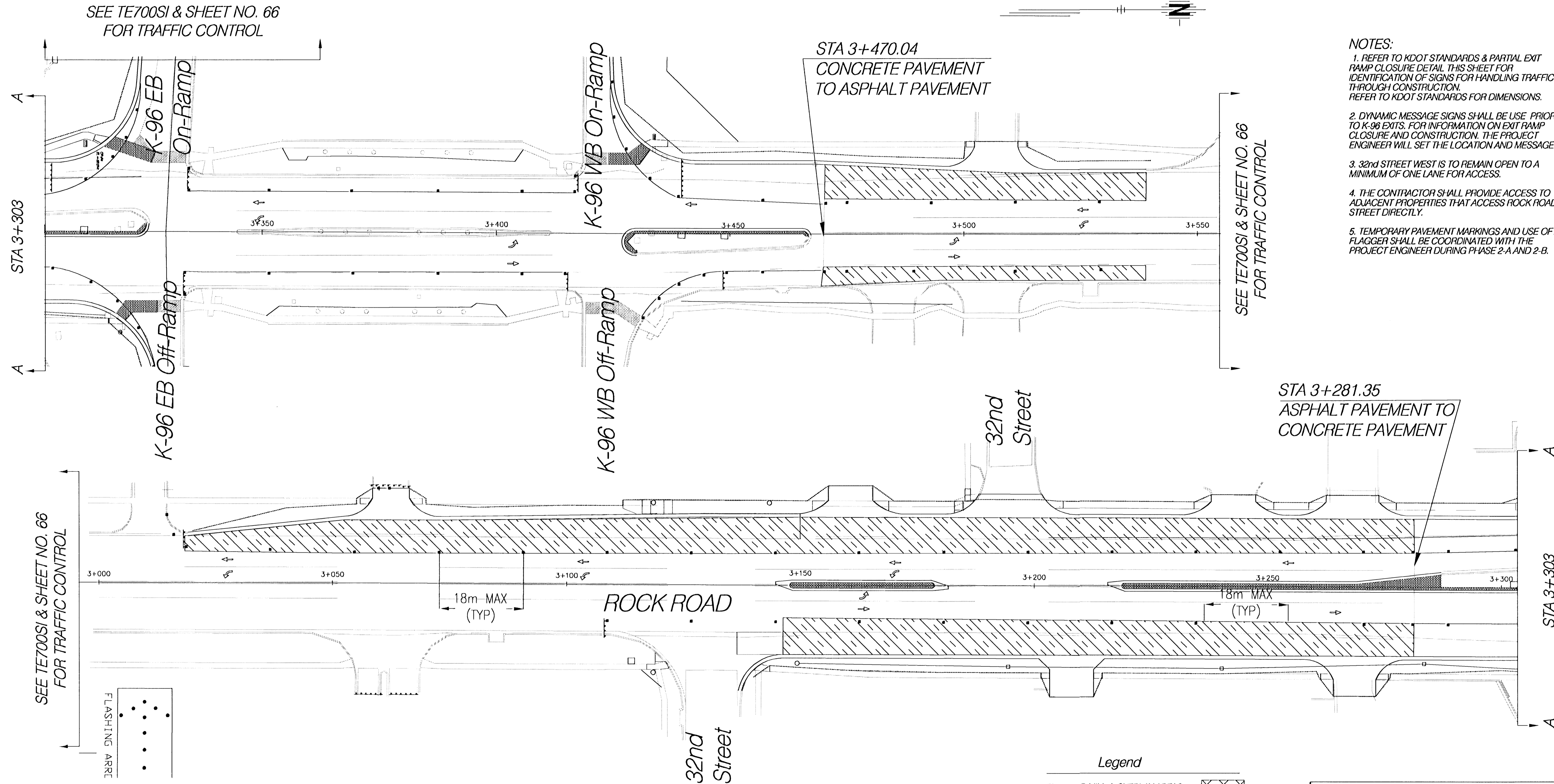

NOTES:

1. REFER TO KDOT STANDARDS & PARTIAL EXIT RAMP CLOSURE DETAIL THIS SHEET FOR IDENTIFICATION OF SIGNS FOR HANDLING TRAFFIC THROUGH CONSTRUCTION.
REFER TO KDOT STANDARDS FOR DIMENSIONS.
2. DYNAMIC MESSAGE SIGNS SHALL BE USE PRIOR TO K-96 EXITS. FOR INFORMATION ON EXIT RAMP CLOSURE AND CONSTRUCTION. THE PROJECT ENGINEER WILL SET THE LOCATION AND MESSAGE.
3. 32nd STREET WEST IS TO REMAIN OPEN TO A MINIMUM OF ONE LANE FOR ACCESS.
4. THE CONTRACTOR SHALL PROVIDE ACCESS TO ADJACENT PROPERTIES THAT ACCESS ROCK ROAD STREET DIRECTLY.
5. TEMPORARY PAVEMENT MARKINGS AND USE OF A FLAGGER SHALL BE COORDINATED WITH THE PROJECT ENGINEER DURING PHASE 2-A AND 2-B.

SEE TE700SI & SHEET NO. 66 FOR TRAFFIC CONTROL

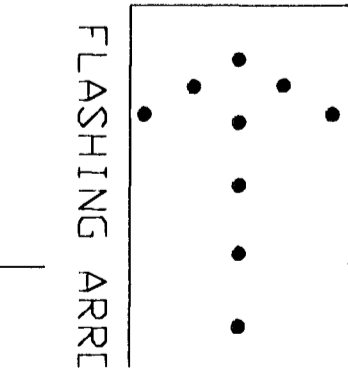

Legend

Phase 2-B MILL & OVERLAY AREAS	
TYPE III BARRICADE	
CHANNELIZING DEVICE (DRUM)	
TRAFFIC FLOW ARROWS (NOT PAVEMENT MARKING)	

ROCK ROAD TRAFFIC CONTROL PLAN PHASE 2-B

Manhattan Office
3209 Kimball Avenue
Manhattan, KS 66503
Phone: (785) 539-2202
Fax: (785) 539-2393

HWS
Consulting Group Inc.

Designed By: JJJ	Checked By: JDM
Drawn By: BJD	Date: 11/14/01 Job No. 55-70-2003