

BENCHMARKS

Benchmark #1 - "X" on the Back of Curb on the West Side of the Commerce St. Valley Gutter
Elev. = 1296.76' NAVD 88

Benchmark #2 - 1" Thimble at the South Section Line of Commerce St. at the R/W Jog
Elev. = 1295.60' NAVD 88

Existing Contours Proposed Contours



Existing Spot Elevations Proposed Spot Elevations

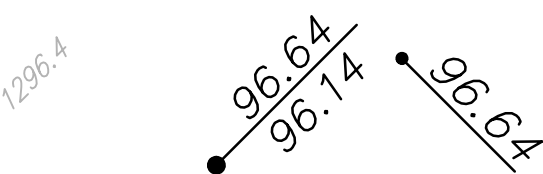

LAYOUT LEGEND

- 6" Reinforced Concrete Pavement on 6" Crushed Rock Base, Reinf.
- Existing Concrete Dock
- Edge of Building
- Project Limits

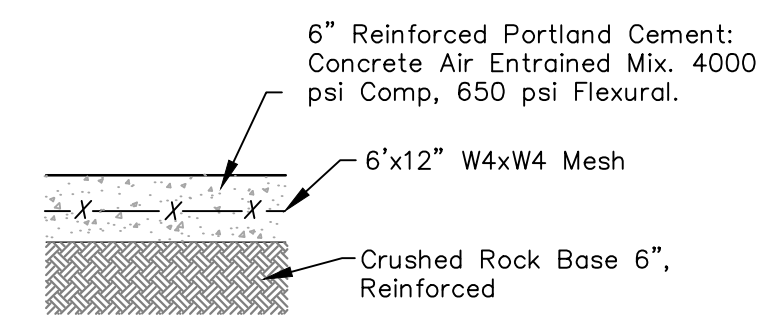

1 6" CONCRETE PAVEMENT
NOT TO SCALE

NOTE:
EXCESS EXCAVATION SHALL BE KEPT ON SITE
AND SPREAD IN RAILROAD R/W AS THE
INSPECTOR SEES FIT

GRADING & SITE PLAN
Scale 1" = 20'-0"

Drawing File: E:\Commerce Parking Lot\Details\Detail02.dwg

Design: P. Baer
Drawn: L. Peter
Approved: P. Baer
Scale: 1"=20'

Project No. 14-10-E149 CAPITAL IMPROVEMENT PROJECT

COMMERCE PARKING LOT
DRIVE EXTENSION - GRADING & SITE PLAN
COMMERCE ART DISTRICT

Baughman Company, P.A.
315 Ellis St. Wichita, KS 67211 P 316-262-7271 F 316-262-0149
ENGINEERING | SURVEYING | PLANNING | LANDSCAPE ARCHITECTURE



AUGUST, 2016

SHEET 5 OF 27