

BY	DATE
REFERENCES NOTED	REFERENCES CHECKED

Point	Station	Elevation		
		P.G. Line	Rt. Hub.	Lt. Hub.
PG 1	0+328.267	411.493	411.323*	411.323*
PG 2	0+338.267	411.461	411.291	411.291
PG 3	0+343.360	411.444	411.274	411.274
PG 4	0+346.000	411.436	411.266	411.266
PG 5	0+348.540	411.428	411.258	411.258
PG 6	0+353.733	411.411	411.241	411.241
PG 7	0+363.733	411.379	411.209*	411.209*

\* Back of Walk Elevation

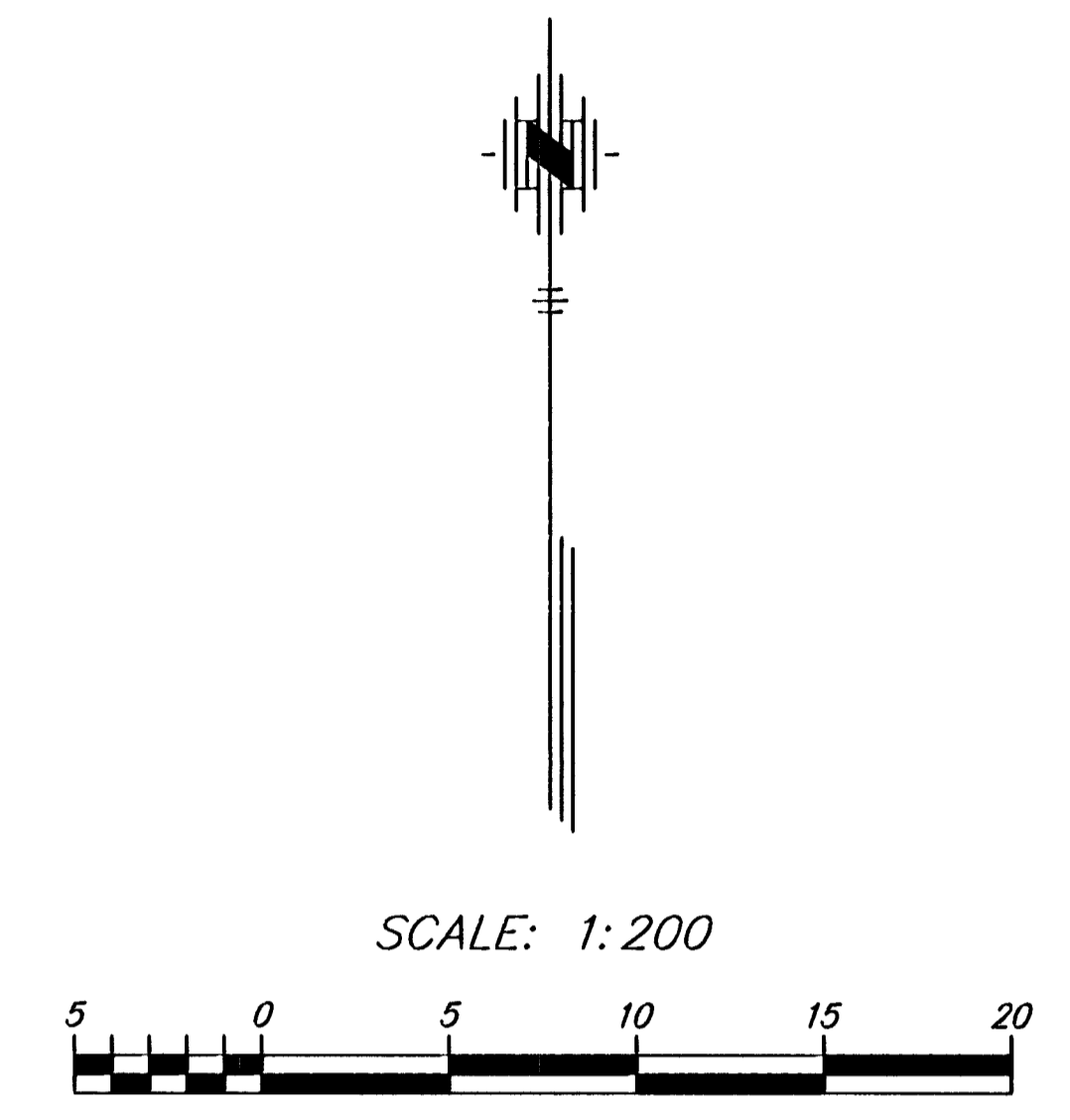
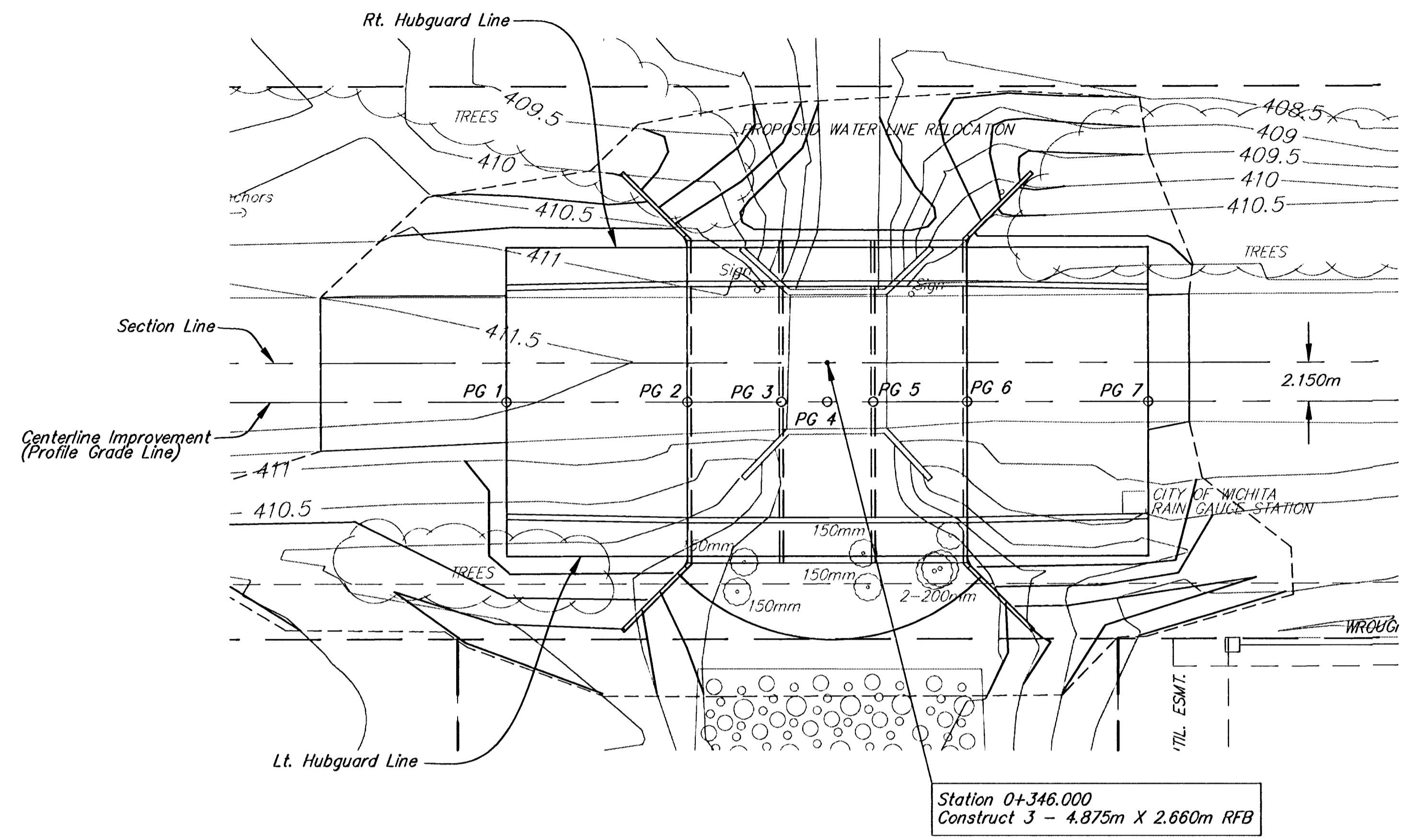

BENCH MARKS:  
 CITY DISK LOCATED AT N.E. CORNER OF INTERSECTION 29TH STREET NORTH & OLIVER; ELEV. = 410.5839 (METERS CONVERTED FROM N.V.G.D.)  
 RAILROAD SPIKE IN POWER POLE LOCATED AT STATION 0+300.0, 7.8m LEFT; ELEV. = 411.0686 (METERS)

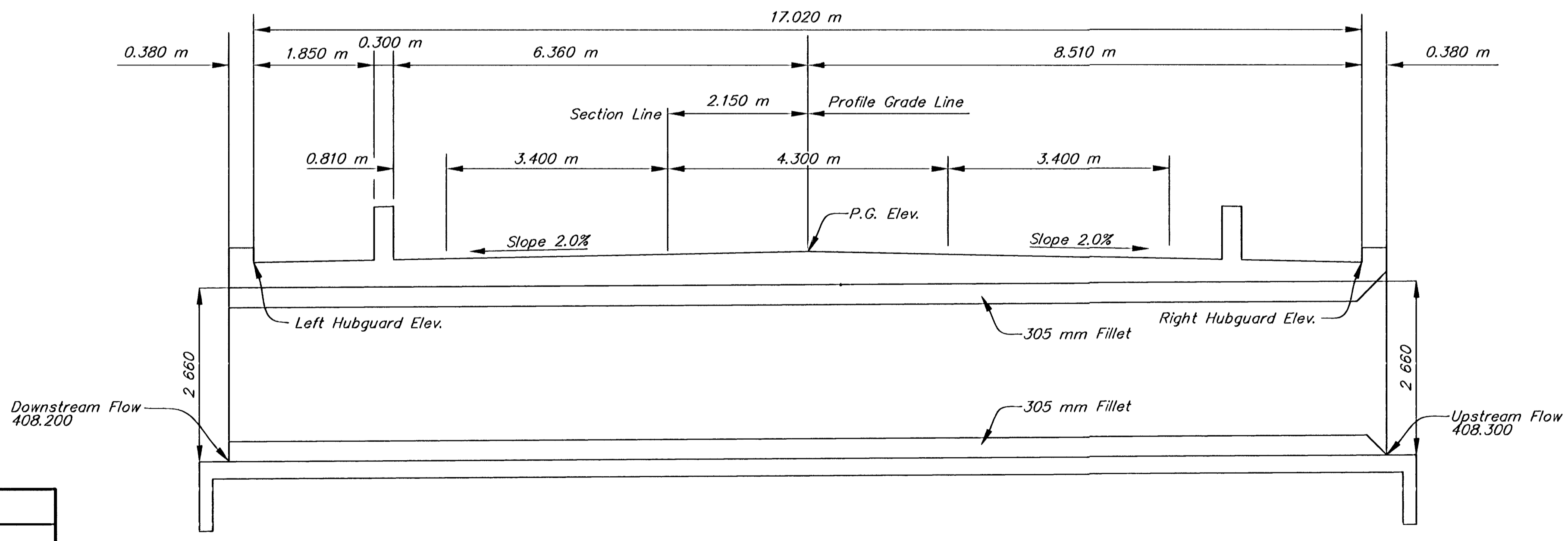
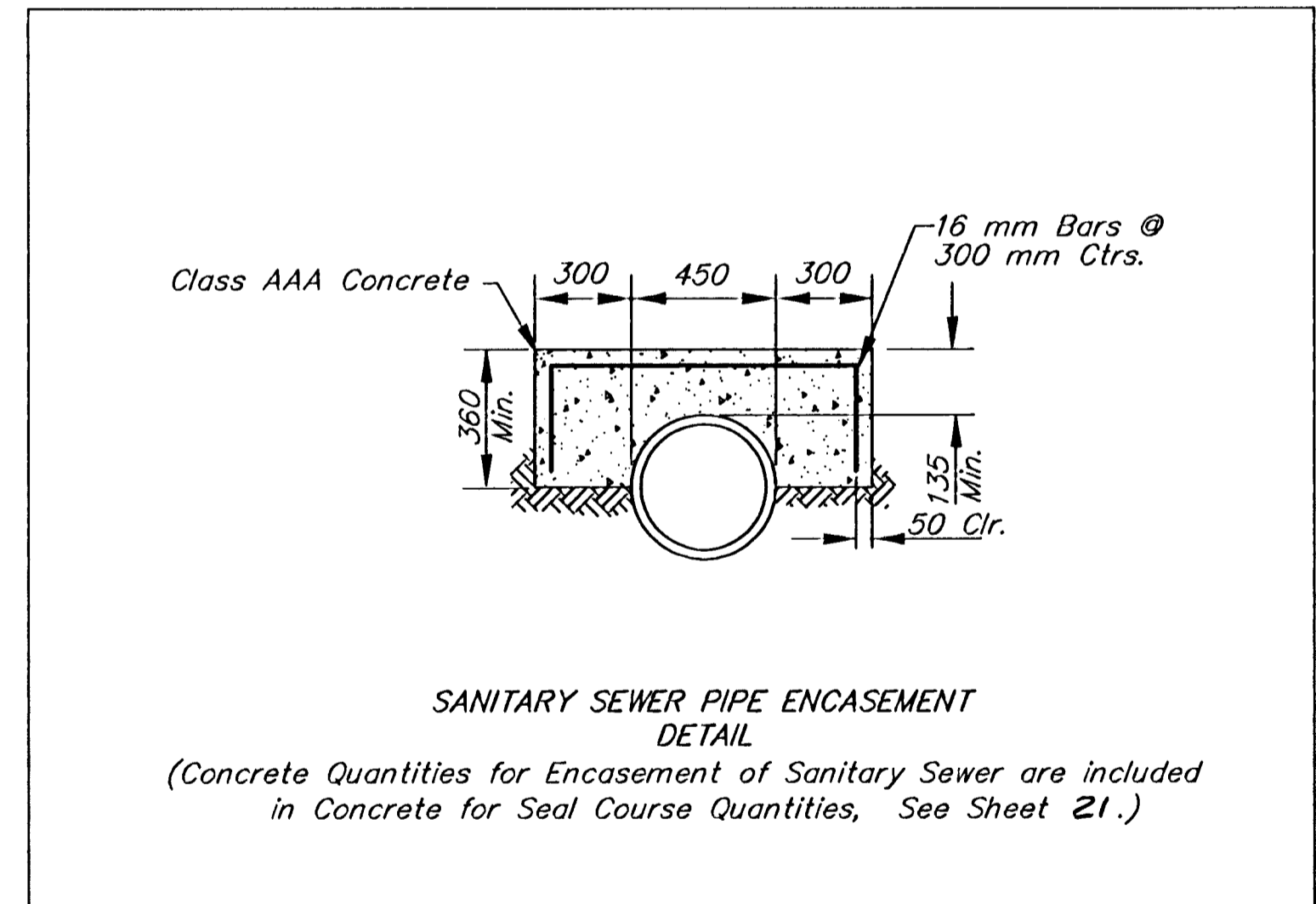

SUMMARY OF REINFORCING STEEL (GRADE 400) *				
STA. TO STA.	ROADWAY	LOCATION	Reinf. Steel (Gr. 400) (kg)	REMARKS
0+335.3	0+356.4	29th Street	Lt.	Sanitary Sewer Encasement
TOTALS			157.6	

\* For Information Only - Reinforcing Steel and Excavation for Sanitary Sewer Encasement is Subsidiary to Concrete for Seal Course.

**BRIDGE CONSTRUCTION LAYOUT**  
**29TH STREET BRIDGE**

**SRB** 324 NORTH MAIN WICHITA KANSAS 67203 316-264-8008 FAX 264-4421  
**SAVOY, RUGGLES & BOHM, P.A.**  
 ENGINEERING & SURVEYING

PROJECT NUMBER  
**472-82414**

DRAWN: KWL DESIGN: CMB/KWL REVIEW: DATE: Jan. 16, 1997 UTILITY: SRB JOB: 95E