

# LANDSCAPING PLANS FOR PAWNEE AVENUE FROM EAST OF ROCK ROAD TO WEBB ROAD

MAY 2002

## PROJECT NO. 472-83087

WICHITA, SEDGWICK COUNTY, KANSAS  
MICHAEL E. LINDEBAK, CITY ENGINEER

## O.C.A. NO. 706782

### INDEX OF SHEETS

SHEET NO.	DESCRIPTION
1	TITLE SHEET
2	TYPICAL SECTION
3-23	ROAD SIDE IMPROVEMENTS-LANDSCAPING

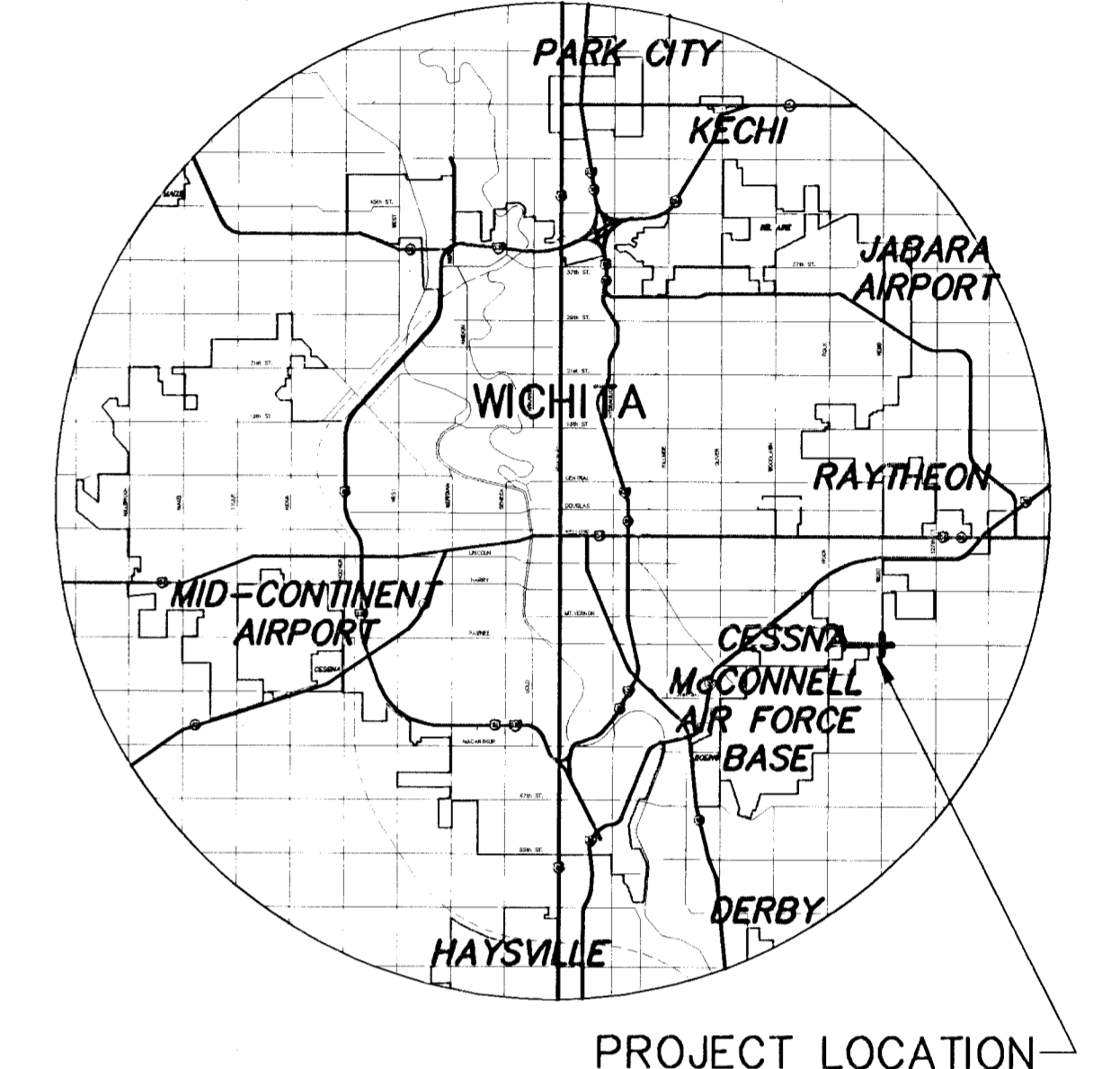
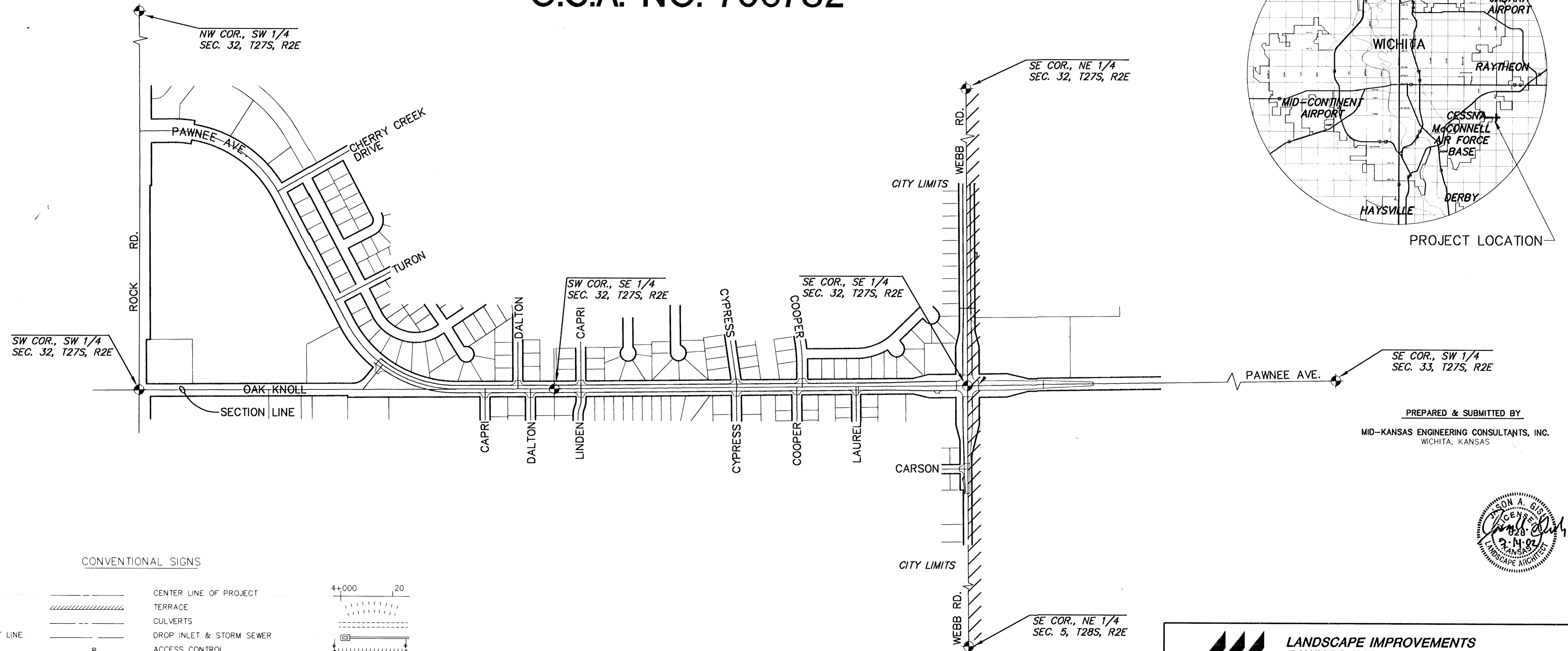
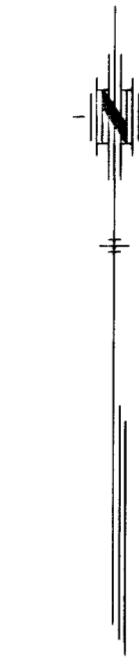

PROJECT LOCATION

PREPARED & SUBMITTED BY  
MID-KANSAS ENGINEERING CONSULTANTS, INC.  
WICHITA, KANSAS

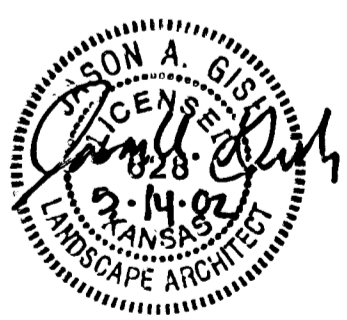

### CONVENTIONAL SIGNS

COUNTY LINE	-----	CENTER LINE OF PROJECT	-----
CITY LIMITS	-----	TERRACE	-----
STATE OR NATIONAL LINE	-----	CULVERTS	-----
TOWNSHIP, SECTION or GRANT LINE	-----	DROP INLET & STORM SEWER	-----
PROPERTY LINE	-----	ACCESS CONTROL	-----
HIGHWAY FENCE	-----	POWER POLE	PP
EXISTING FENCE	-----	TELEPHONE POLE	PP
GUARD FENCE	-----	MARSH	-----
CONSTRUCTION LIMITS	-----	HEDGE	-----
RIGHT OF WAY LINE	-----	TREES	-----
TRAVELED WAY	-----	PROFILE ELEVATION	-----
RAILROADS	-----	STREAM or CREEK	-----

**MKEC**  
ENGINEERING  
CONSULTANTS  
411 N. WEBB ROAD  
WICHITA, KS. 67206  
316 - 684 - 9600

**LANDSCAPE IMPROVEMENTS  
PAWNEE AVE.**  
PROJECT NAME

---

**TITLE SHEET**  
SHEET TITLE

---

JAG	NRP	JAG
DESIGN BY:	DRAWN BY:	CHECKED BY:
APRIL 2002	98171	1 / 23
DATE	JOB NO.	SHEET/OF

G:\CT\1\PAW-WEBB\98171\ROADSIDE\LANDSCAP\Title.dwg Mon May 13 14:07:50 2002