

PLANT LIST FOR THIS SHEET

FHWA REG. NO.	STATE	PROJECT NO.	YEAR	SHEET NO.	TOTAL SHEETS
7	KANSAS	STP-N012(901)	2001	13	23

QTY.	COMMON NAME	BOTANICAL NAME	SIZE	CONDITION/REMARKS
LARGE DECIDUOUS TREES				
3	CHINESE PISTACHE	<i>Pistacia chinensis</i>	2.5" cal.	Balled-in-Burlap
EVERGREEN TREES				
1	AUSTRIAN PINE	<i>Pinus nigra</i>	8'	Balled-in-Burlap
ORNAMENTAL TREES				
4	OKLAHOMA REDBUD	<i>Cercia reniformis</i>	1.5" cal.	Balled-in-Burlap
LAWN				
-	K-31 FESCUE	<i>Festuca arundinacea 'K-31'</i>	80D	

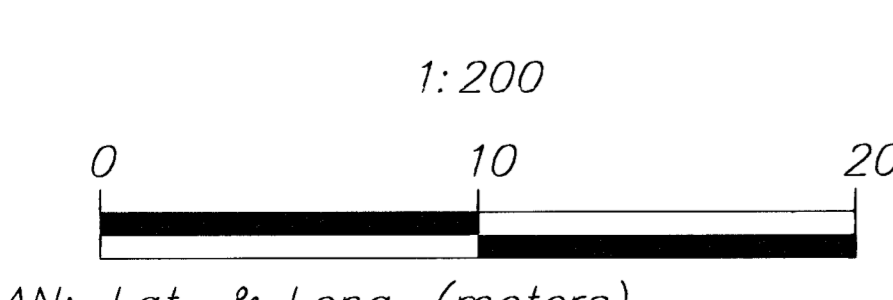
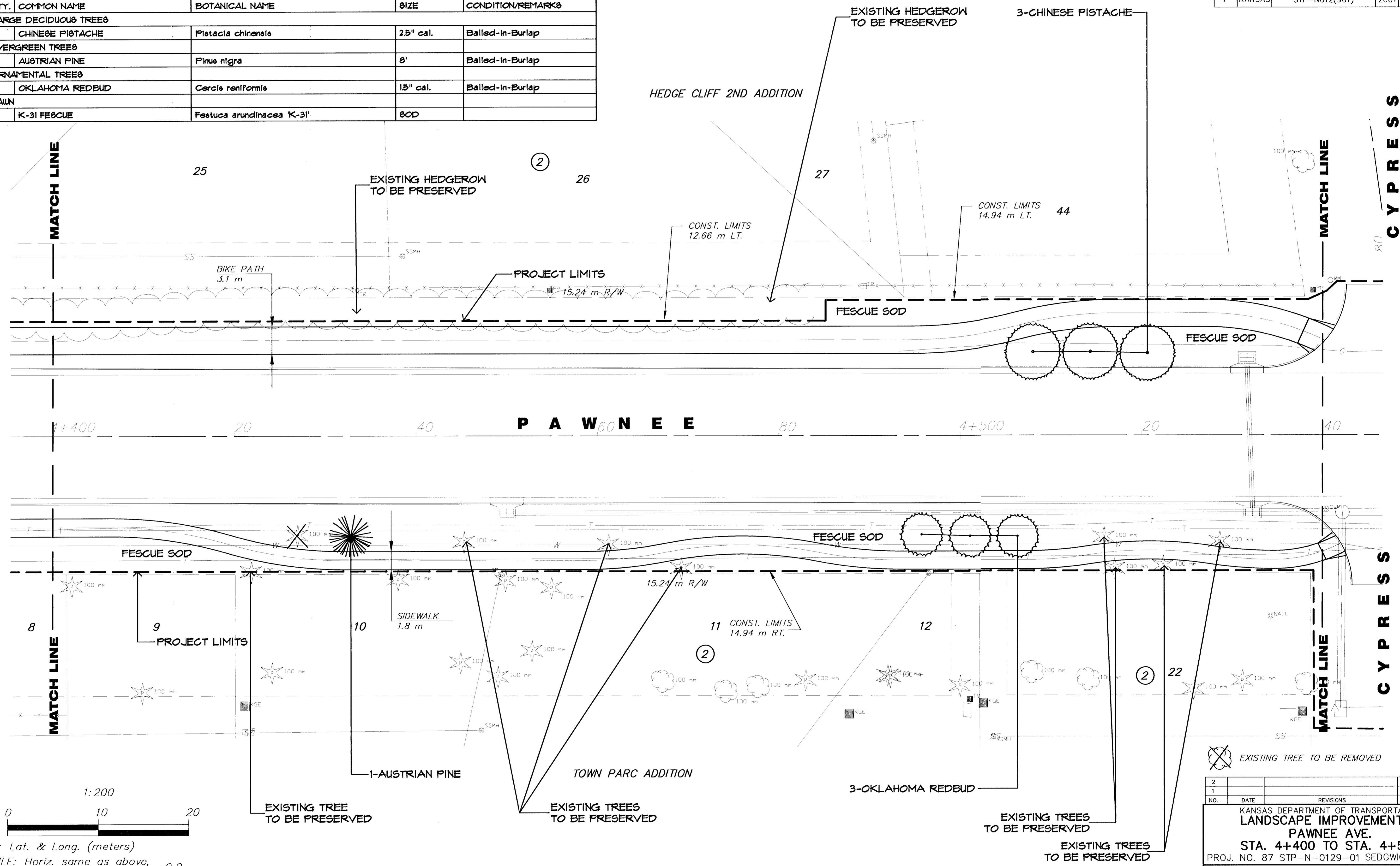

PROFILE: Horiz. same as above, Vert. 0.2
SCALE: 1 : 20

2				
1				
NO.	DATE	REVISIONS	BY	APP'D

KANSAS DEPARTMENT OF TRANSPORTATION
LANDSCAPE IMPROVEMENTS
PAWNEE AVE.
STA. 4+400 TO STA. 4+540
 PROJ. NO. 87 STP-N-0129-01 SEDGWICK COUNTY
MID-KANSAS ENGINEERING CONSULTANTS, INC.
 WICHITA, KANSAS

DESIGNED BY: JTC	CHECKED BY: JTC
DRAWN BY: GJR	DATE: APRIL 2002

SHEET 13 OF 23

G:\CIVIL\PAWNEE\WEBB\98171\ROADSIDE\LANDSCAPE\LANDSCAPE\LANDSCAPE.dwg Mon May 06 15:10:00 2002