

STREET IMPROVEMENTS FOR
21ST & OLIVER INTERSECTION
WICHITA, KANSAS

©2016
MKEC Engineering
All Rights Reserved
www.mkec.com
These drawings and their contents, including, but not limited to, all concepts, designs, & ideas are the exclusive property of MKEC Engineering (MKEC), and may not be used or reproduced in any way without the express consent of MKEC.

BASELINE BUBBLE MAP

PROJECT NO.	472-85213	
DATE	SEPT. 2016	
SCALE	AS SHOWN	
DESIGNED	DRAWN	CHECKED
JTC	DM	JTC
#	---	##/###/###
NO.	REVISION	DATE

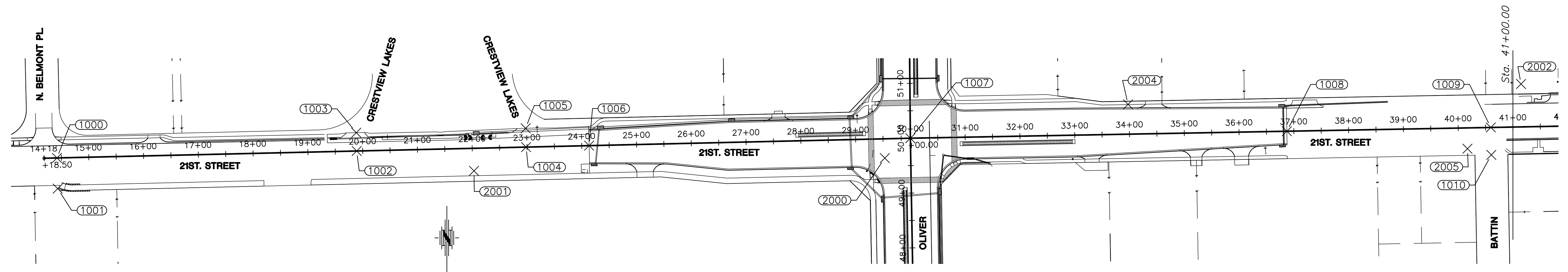

21ST. STREET

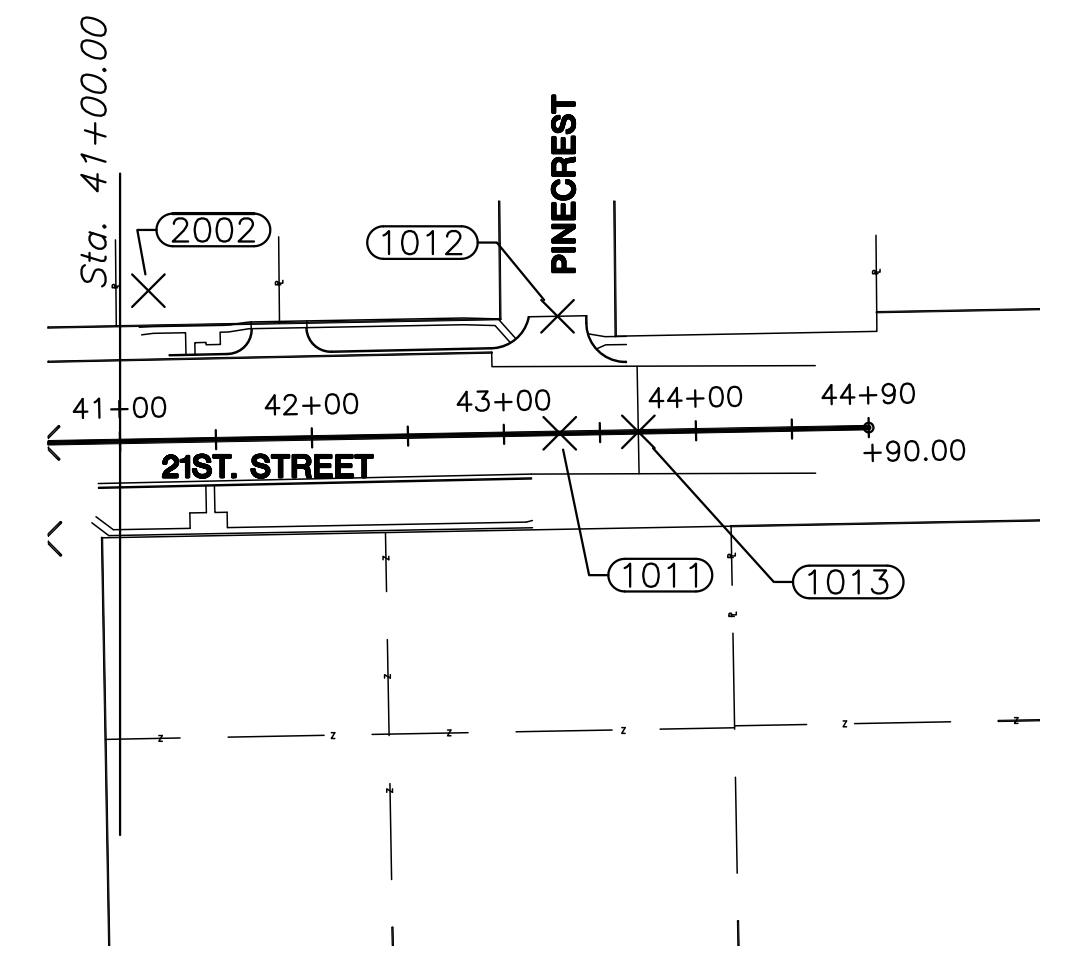

21ST. STREET

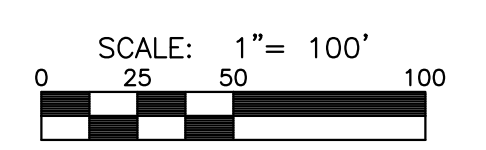

CONTROL POINTS					
Point #	STATION	OFFSET	Northing	Easting	Desc.
2000	29+52.48	35.12' Rt	1699416.2100	1665136.2320	BM#4
2001	22+02.31	41.15' Rt	1699392.8742	1664386.4004	BM#5
2002	41+16.24	78.23' Lt	1699551.2852	1666297.5330	BM#21
2003	44+22.98	40.66' Rt	1698876.2120	1665233.7660	116 MKEC CP 2IN ALUM
2004	33+98.41	54.30' Lt	1699514.0780	1665580.2680	202 MKEC CP
2005	40+16.29	37.87' Rt	1699433.3570	1666199.7460	203 5/8 MKEC ALUM CP
2006	54+80.49	63.19' Rt	1699933.4780	1665241.5970	204 MKEC CP
2007	59+93.76	29.43' Lt	1700445.8570	1665144.1560	205 5/8 MKEC ALUM CP

BASELINE POINTS					
Point #	STATION	OFFSET	Northing	Easting	Desc.
1000	14+41.94	0.00'	1699416.4619	1663625.2870	BEG. PROJ.
1001	14+41.94	55.97' Rt	1699360.5099	1663626.5786	SW
1002	19+89.14	0.00'	1699429.0903	1664172.3360	INT CRESTVIEW LK
1003	19+89.14	33.45' Lt	1699462.5319	1664171.5640	CRESTVIEW LAKE LMTS
1004	22+98.38	0.00'	1699436.2272	1664481.4968	INT CRESTVIEW LAKE
1005	22+98.38	34.29' Lt	1699470.5047	1664480.7055	CRESTVIEW LAKE REM. LMTS
1006	24+13.52	0.00'	1699438.8846	1664596.6090	PT
1007	30+00.00	0.00'	1699452.4196	1665182.9313	INT OLIVER
1008	36+87.32	0.00'	1699465.1362	1665870.1287	PT
1009	40+59.67	0.00'	1699472.0254	1666242.4195	INT BATTIN
1010	40+59.67	49.97' Rt	1699422.0653	1666243.3441	BATTIN REM.
1011	43+29.06	0.00'	1699477.0097	1666511.7656	INT PINECREST
1012	43+29.06	60.96' Lt	1699537.9571	1666510.6377	PINECREST REM.
1013	43+70.00	0.00'	1699477.7671	1666552.6967	PROJ. END
1014	38+20.99	0.00'	1698273.5980	1665203.7426	BEG. PROJ.
1015	41+63.49	0.00'	1698616.0446	1665197.6970	INT 19th(E.B.)
1016	41+63.49	85.00' Lt	1698614.5443	1665112.7114	19th REM.(E.B.)
1017	42+02.49	89.00' Lt	1698653.4676	1665108.0224	19th REM.(W.B.)
1018	42+02.49	0.00'	1698655.0386	1665197.0085	INT 19th(W.B.)
1019	46+08.43	0.00'	1699060.9125	1665189.8431	INT SHADYBROOK
1020	46+08.43	79.93' Rt	1699062.3234	1665269.7605	SHADYBROOK REM.
1021	56+76.41	0.00'	1700128.7965	1665176.5689	PROJ. END

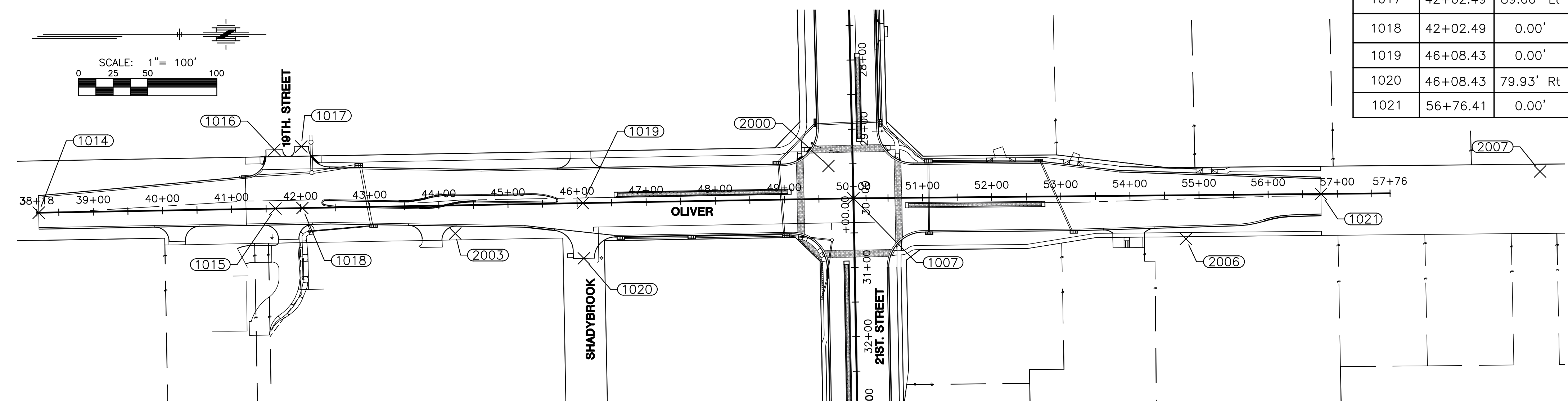

OLIVER

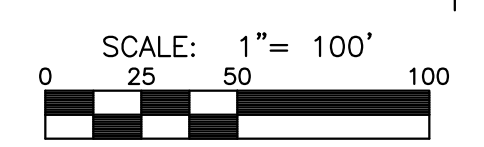

- LEGEND**
- PC—Point of Curve
 - PCC—Point on Compound Curve
 - RP—Radius Curve
 - BC—Back of Curb
 - EP—Edge of Pavement
 - PT—Point on Tangent
 - INT—Point of Intersection

J:\PROJECTS\2016\1910104078_COW_21ST & OLIVER_XXXXXX CAD\SHITS\05 CIVIL\CONTROL-BUBBLE\15178\BL01.DWG
 PLOTTED: Thursday, September 22, 2016 @ 01:41PM