

PLOTTED: Thursday, September 22, 2016 @ 02:35PM

J:\PROJECTS\2016\19104078\_COW\_21ST & OLIVER\_XXXXXX CAD\SHS\165 CIVIL\TRAFFIC\16787C PLAN PHASE 1A-21ST.DWG

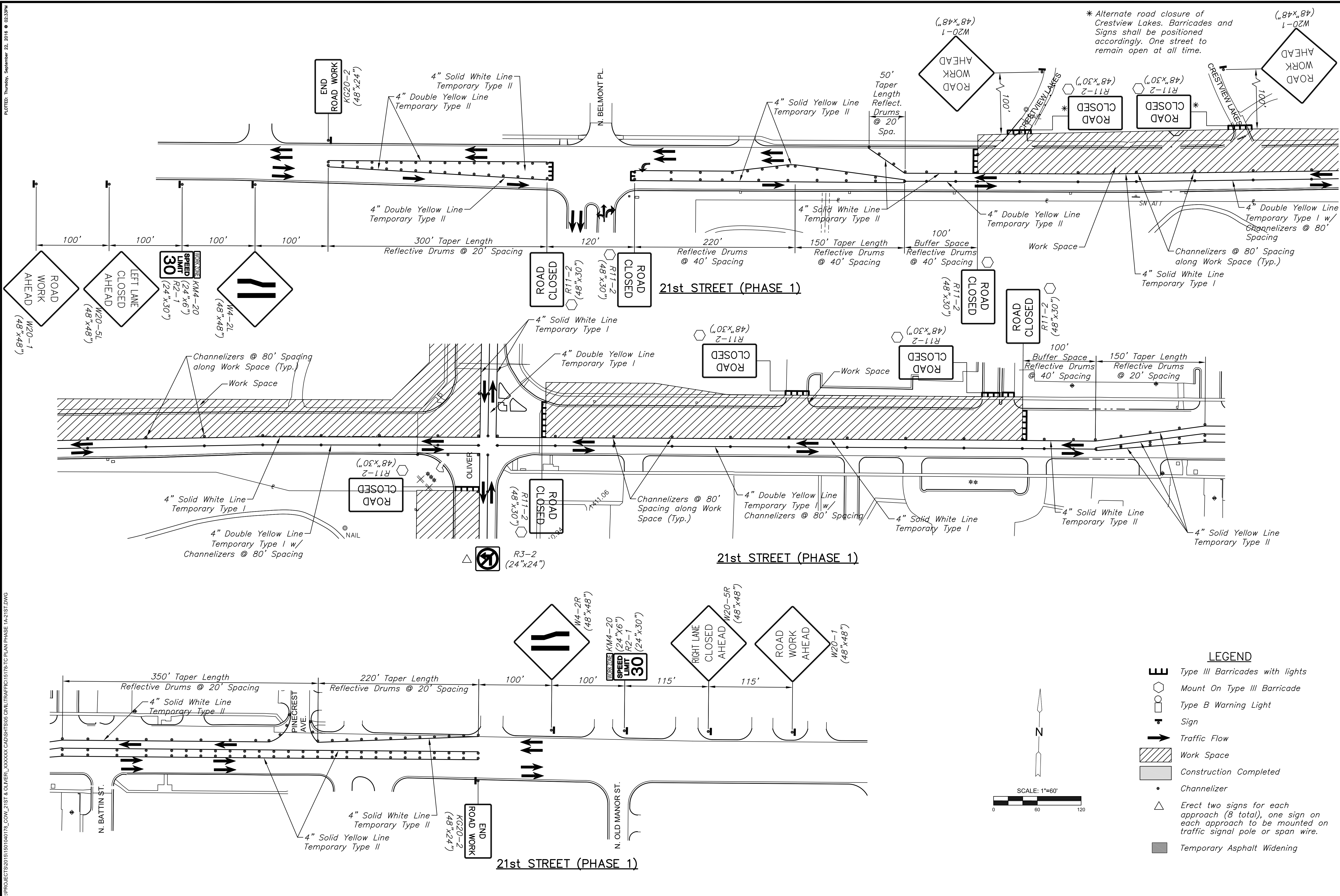

\* Alternate road closure of Crestview Lakes. Barricades and Signs shall be positioned accordingly. One street to remain open at all time.

- LEGEND**
- Type III Barricades with lights
  - Mount On Type III Barricade
  - Type B Warning Light
  - Sign
  - Traffic Flow
  - Work Space
  - Construction Completed
  - Channelizer
  - Erect two signs for each approach (8 total), one sign on each approach to be mounted on traffic signal pole or span wire.
  - Temporary Asphalt Widening

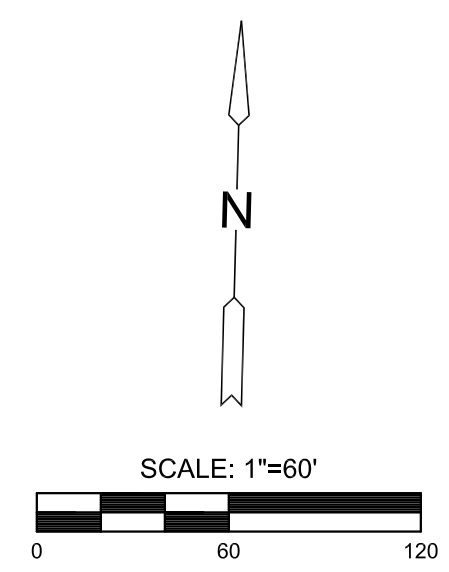

STREET IMPROVEMENTS FOR  
**21ST & OLIVER INTERSECTION**  
WICHITA, KANSAS

©2016 MKEC Engineering All Rights Reserved www.mkec.com  
These drawings and their contents, including, but not limited to, all concepts, designs, & ideas are the exclusive property of MKEC Engineering (MKEC), and may not be used or reproduced in any way without the express consent of MKEC.

**TRAFFIC CONTROL PHASE 1 - 21ST STREET**

PROJECT NO.	472-85213	
DATE	SEPT. 2016	
SCALE	1"=60'	
DESIGNED	DRAWN	CHECKED
JRA	WNJ	JRA
NO.	REVISION	DATE
SHEET NO.		
88 OF 125		