

F.H.W.A. REGION NO.	STATE	PROJECT NO.	YEAR	SHEET NO.	TOTAL SHEETS
7	KANSAS	87 N-0230-01	2003	25	73

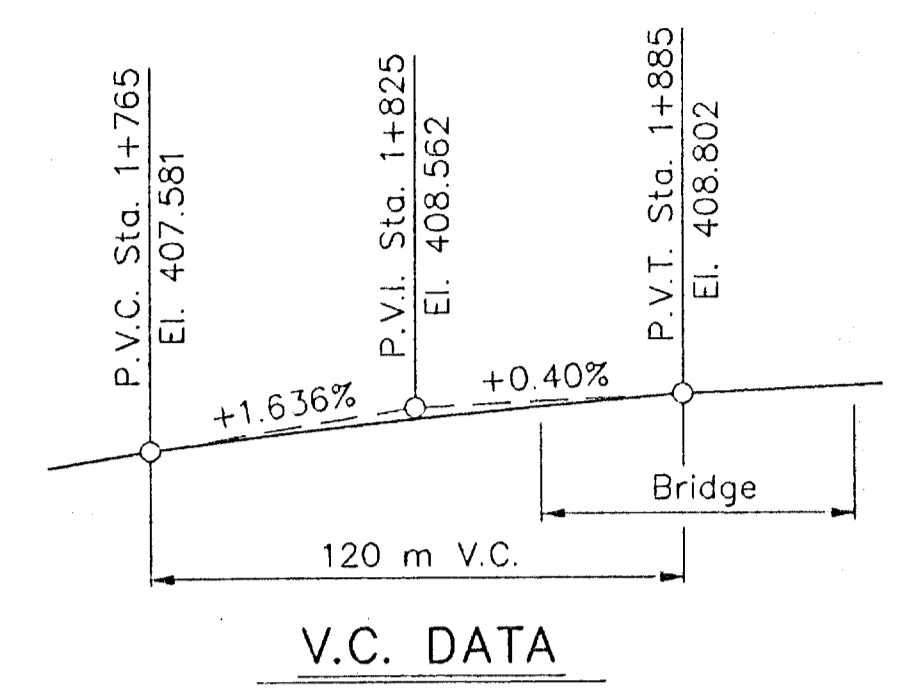

Note: Thermal movement at the abutments = 61 mm.  
(Type C only) W = 63 mm.

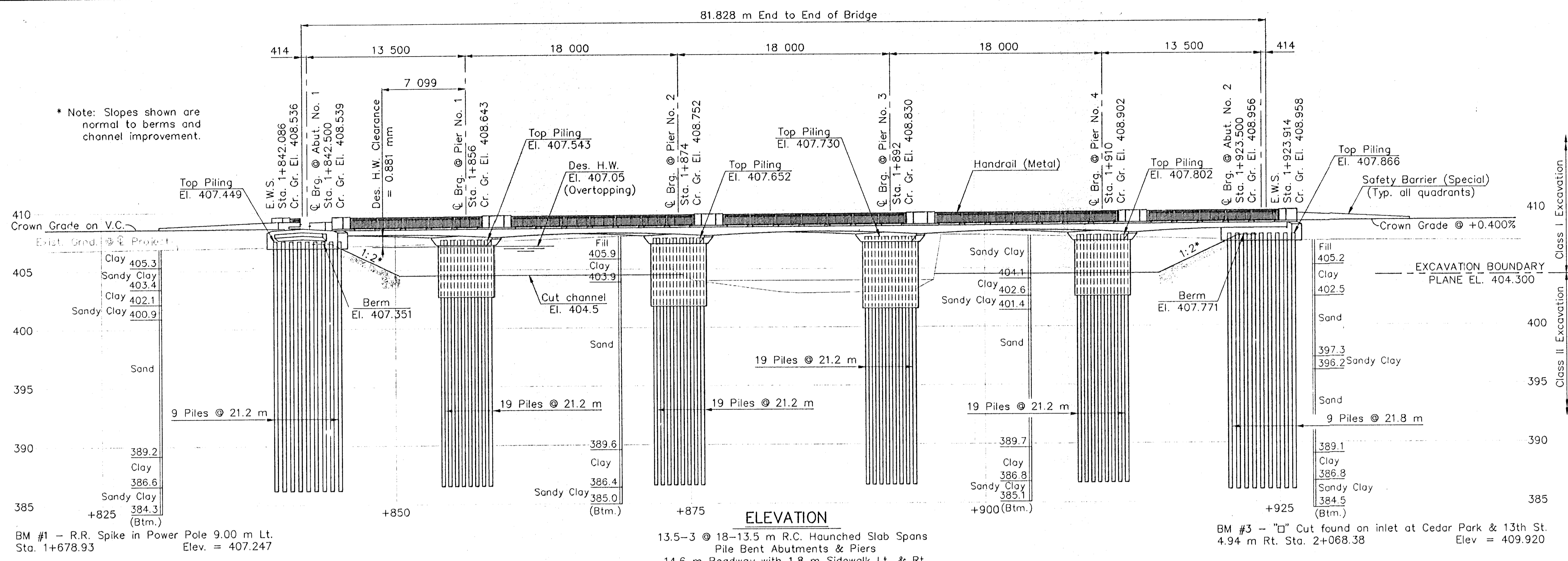
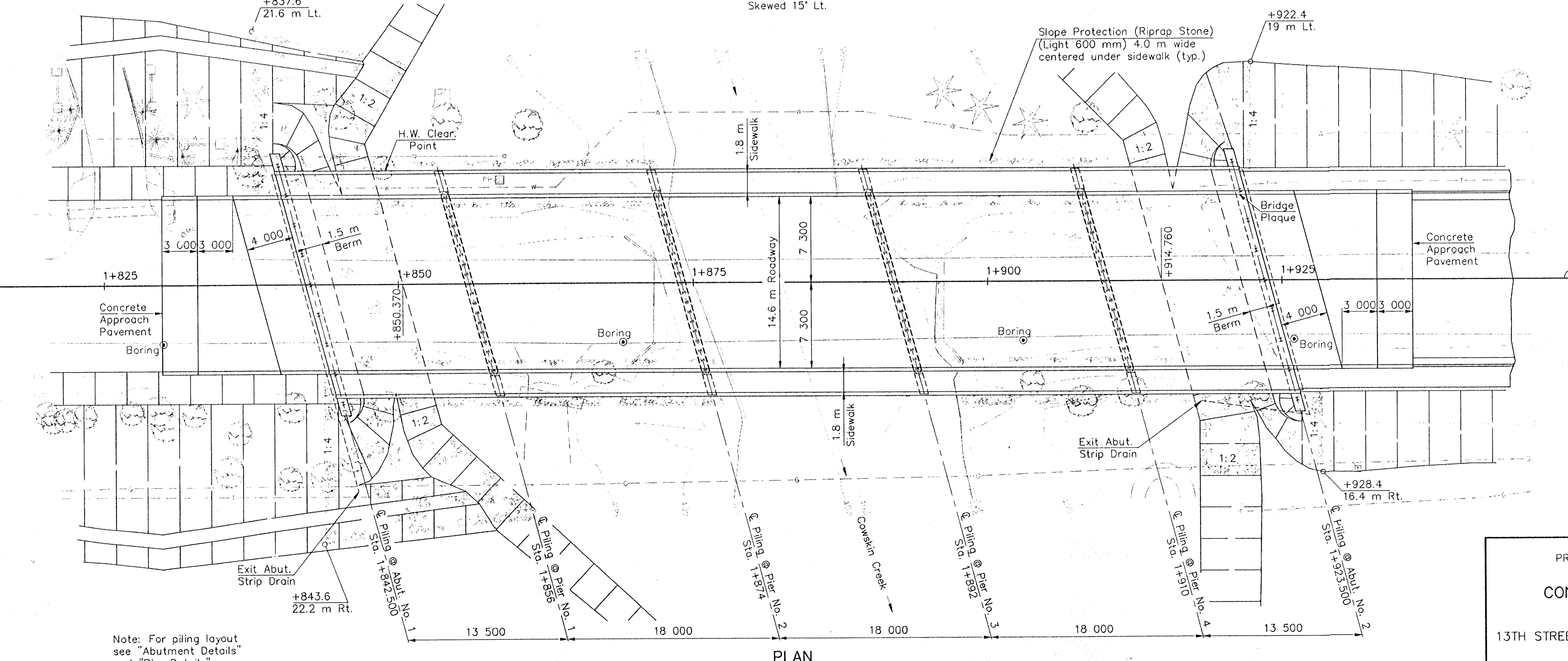

**DRAINAGE DATA**

DRAINAGE AREA = 207.6 sq km  
OBSERVED H.W. ELEV. = 407.0

FLOOD	Q-m <sup>3</sup> /s	V-m/s	**ELEVATION
10 YEAR	182	1.4	406.58
*15 YEAR	212	1.5	407.05
25 YEAR	262	1.5	407.26
50 YEAR	337	1.5	407.53
100 YEAR	416	1.4	407.74

\* OVERTOPPING  
\*\* INCLUDES BACKWATER

DESIGN WATERWAY PROVIDED (BELOW ELEV. 407.05) = 191 sq m  
TOTAL WATERWAY PROVIDED = 270 sq m  
DESIGN FREQUENCY = 15 YEAR

PROJECT NO. 87 N-0230-01

**CONSTRUCTION LAYOUT**

13TH STREET NORTH OVER COWSKIN CREEK

STA. 1+883 CITY OF WICHITA

Cook, Flatt & Strobel  
ENGINEERS, P.A.

DESIGNED	KMB	SCALE
DETAILED	DEG	DATE
QUANTITIES	DEG	SHEET
		OF

J:\02517\DWG\CL 1:200 (1:2)