

SUBDIVISION BENCH MARKS				
NO.	STREET AND STATION	FROM CL	DESCRIPTION	ELEVATIONS
3	IRONHORSE STA., 11+77	17.5' RT	TOP OF CURB AT END OF RETURN, IRONHORSE	

NOTE: CONTRACTOR SHALL INSTALL SUBDIVISION BENCH MARKS ("FLAT SURVEY MARKERS NO. 8134-08 3" TOP DIAMETER" PROVIDED BY KANSAS BLUE PRINT CO., INC.) COSTS TO BE CONSIDERED SUBSIDIARY TO CONSTRUCTION OF COMBINED CURB AND GUTTER.

IRONHORSE AT OXFORD ADD.

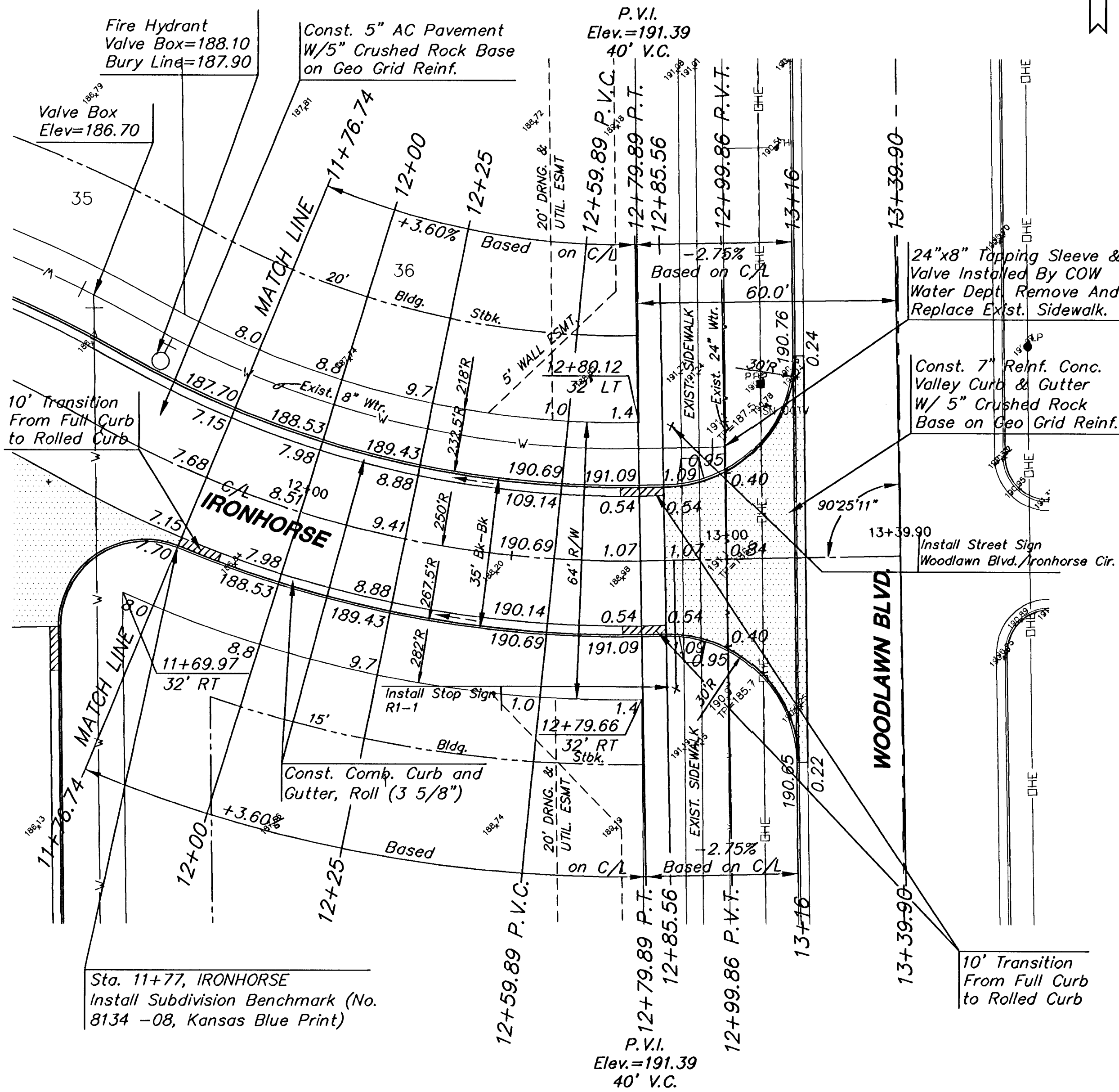
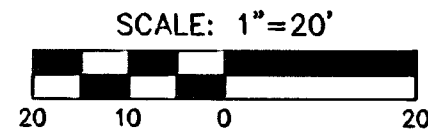

IRONHORSE AT OXFORD ADD.

CURVE TABLE					
$\Delta = 30^{\circ}40'59''$ R = 250.00' T = 68.59' L = 133.88' LC = 132.29'					
CURVE DATA BASED ON CENTERLINE $\Delta/2 = 15^{\circ}20'29''$					
STATION	ARC	CHORD LENGTH		DEFLECTION	TOTAL DEFLECTION
		' Off LtCb	' Off RtCb		
11+46.01	-	-	-	00°00'00"	00°00'00"
11+75.00	28.99'	27.00'	30.94'	03°19'19"	03°19'19"
12+00.00	25.00'	23.29'	26.69'	02°51'53"	06°11'12"
12+25.00	25.00'	23.29'	26.69'	02°51'53"	09°03'06"
12+50.00	25.00'	23.29'	26.69'	02°51'53"	11°54'59"
12+75.00	25.00'	23.29'	26.69'	02°51'53"	14°46'52"
12+79.89	4.89'	4.56'	5.22'	00°33'37"	15°20'30"

Def/Ft = 6.87549 Min.

IRONHORSE AT OXFORD ADD.

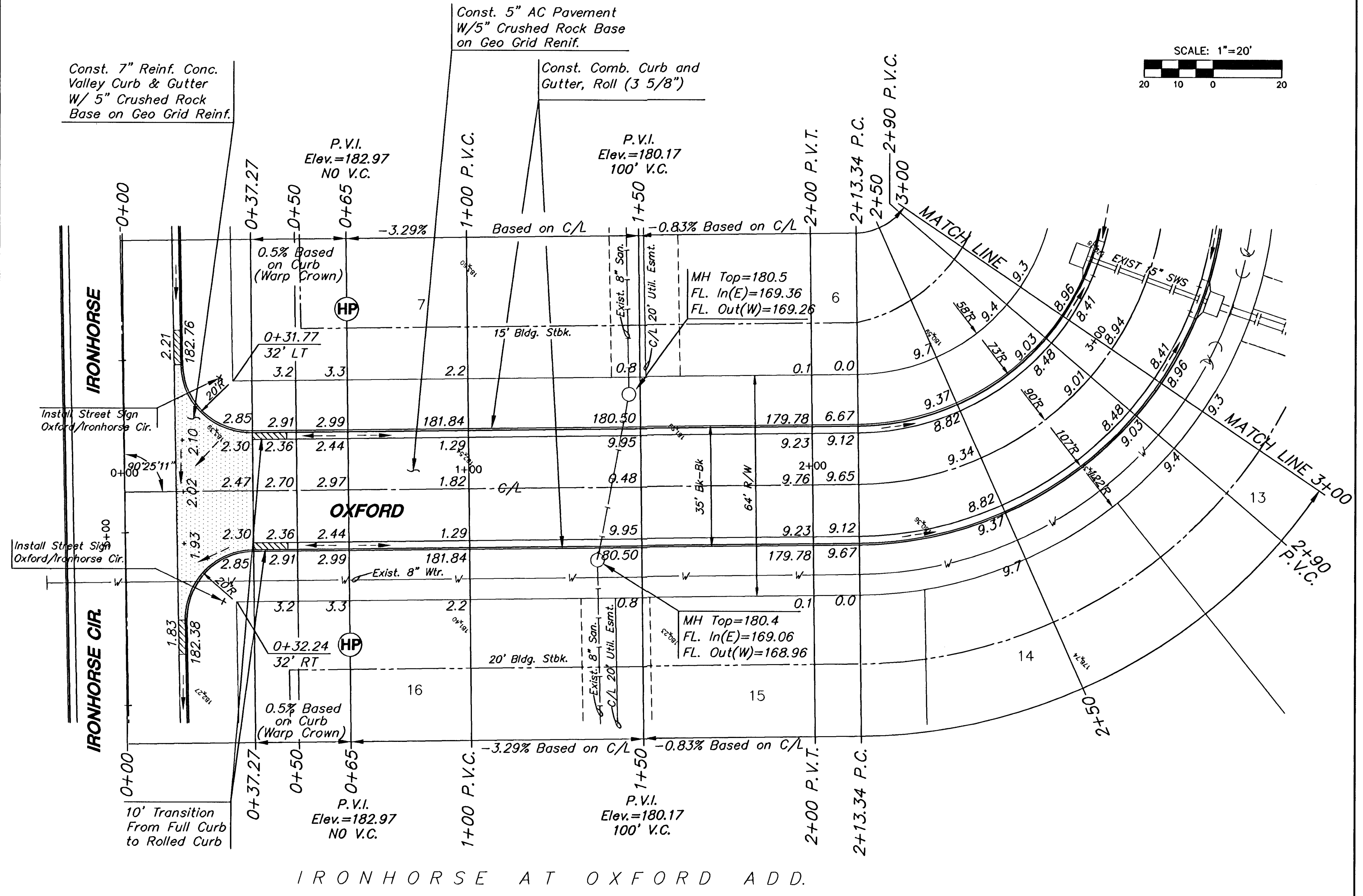
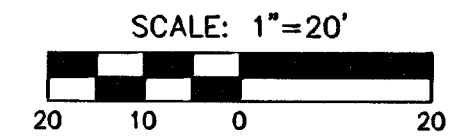

IRONHORSE AT OXFORD ADD.

CURVE TABLE					
$\Delta = 90^{\circ}24'47''$ R = 116.00' T = 116.84' L = 183.05' LC = 164.64'					
CURVE DATA BASED ON WATERLINE $\Delta/2 = 45^{\circ}12'24''$					
STATION	ARC	CHORD LENGTH		DEFLECTION	TOTAL DEFLECTION
		6' LT Offset	6' RT Offset		
2+39.16	-	-	-	00°00'00"	00°00'00"
2+50.00	10.84'	-	11.40'	02°40'38"	02°40'38"
2+75.00	25.00'	-	26.24'	06°10'27"	08°51'04"
3+00.00	25.00'	-	26.24'	06°10'27"	15°01'31"
3+25.00	25.00'	-	26.24'	06°10'27"	21°11'58"
3+50.00	25.00'	-	26.24'	06°10'27"	27°22'25"
3+75.00	25.00'	-	26.24'	06°10'27"	33°32'52"
4+00.00	25.00'	-	26.24'	06°10'27"	39°43'18"
4+22.21	22.21'	-	23.32'	05°29'05"	45°12'23"

Def/Ft = 14.81787 Min.

**MKEC**  
ENGINEERING  
CONSULTANTS

411 N. WEBB ROAD  
WICHITA, KS. 67206  
316 - 684 - 9600

**IRONHORSE AT OXFORD ADDITION**  
PROJECT NAME

**IRONHORSE / OXFORD PAVING PLAN**  
SHEET TITLE

ASH  
DESIGN BY: RLH  
DRAWN BY: ASH  
CHECKED BY: ASH

MARCH 2003  
DATE

02173\_E3  
JOB NO.

7 / 24  
SHEET/OF