

CONTROLLER DESCRIPTION

The Traffic Signal Controller shall comply with the requirements defined in the Specifications for a Type 170E Controller with 412b2 prom module and a 400 modem. It shall be furnished and installed with a Model 332 cabinet, 3-type 242 isolator units, 1 video detection unit, 8 switch packs, 2-type 204 flashers, 4 flash transfer relay, and a Model 210P conflict monitor MS or or ECL. The Controller shall also be furnished with WAIKS Version 58 or latest version of software developed by WAPITI MICRO SYSTEMS.

SCALE: 1"=20'

- THE CONTRACTOR SHALL COORDINATE THE PLACEMENT OF THE PAVEMENT MARKING WITH PAVING AND STORM WATER IMPROVEMENTS CONTRACTOR (CITY OF WICHITA PROJ. NO. 472-83676).
- THE CONTRACTOR SHALL RECONNECT INKING THE POWER SUPPLY LINE TO THE EXISTING SIGN IN THE ISLAND OF WILSON ESTATES PARKWAY. INSTALL A 1 INCH RISER AND WEATHER HEAD ON THE EXISTING POLE AT THE SOUTHEAST CORNER OF THE INTERSECTION. CONNECT TO THE EXISTING UNDERGROUND CONDUIT AND PROVIDE NEW WIRING PER LOCAL CODE REQUIREMENTS. POWER SUPPLY SHALL BE IN A SEPARATE CONDUIT FROM THE TRAFFIC SIGNAL SYSTEM. THE CONTRACTOR IS RESPONSIBLE FOR THE CONDUIT, WIRING AND ALL MISCELLANEOUS ITEMS REQUIRED FROM THE WEATHER HEAD TO THE METER LOCATED ON THE WEST SIDE OF THE SIGN. ALL WORK AND MATERIAL ARE INCIDENTAL TO THE LUMP SUM BID PRICE FOR THE TRAFFIC SIGNAL.

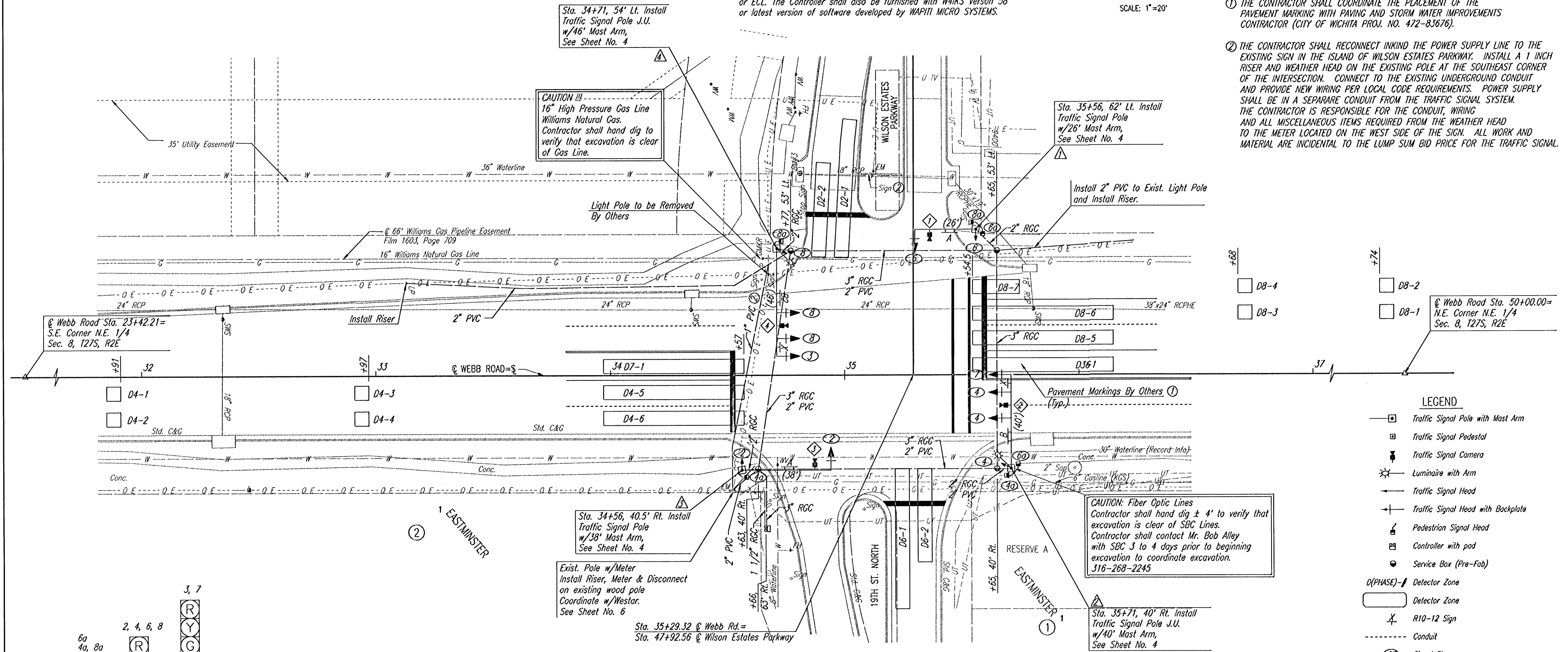

- #### LEGEND
- Traffic Signal Pole with Mast Arm
 - Traffic Signal Pedestal
 - Traffic Signal Camera
 - Luminaire with Arm
 - Traffic Signal Head
 - Traffic Signal Head with Backplate
 - Pedestrian Signal Head
 - Controller with pod
 - Service Box (Pre-Fab)
 - D(PHASE)-# Detector Zone
 - Detector Zone
 - R10-12 Sign
 - Conduit
 - Signal Phase
 - Signal Pole Reference Number
 - Street Name Sign

SEE SHEET NO. 4 FOR WIRING DIAGRAM

WILSON ESTATES PARKWAY AND WEBB ROAD

TRAFFIC SIGNAL PLAN

Professional Engineering Consultants, P.A.
 303 S. TOPEKA • WICHITA, KANSAS 67202
 316-262-2691 • FAX 316-262-3003

Designed by	BER	Checked by	
Drawn by	SAW, BJS	Date	JANUARY 2003
		Job No.	02620-004

WILSON ESTATES PARKWAY & WEBB ROAD	PHASE							
	1	2	3	4	5	6	7	8
MAX. I	-	30	30	80	-	30	30	80
MAX. II/HFDW	-	30	30	80	-	30	30	80
WALK	-	-	-	8	-	8	-	8
FLASH DW	-	-	-	25	-	21	-	22
MAX. INITIAL	-	8.0	6.0	8.0	-	8.0	6.0	8.0
MIN. GREEN	-	10.0	5.0	10.0	-	10.0	5.0	10.0
T T R	-	-	1.0	-	-	-	1.0	-
OBSERVE GAP	-	-	-	-	-	-	-	-
PASSAGE	-	1.0	1.0	-	-	1.0	1.0	1.0
MIN. GAP	-	-	1.0	-	-	-	1.0	-
ADDED ACTUATION	-	2.0	1.0	2.0	-	2.0	1.0	2.0
YELLOW	-	3.5	3.0	4.0	-	3.5	3.0	4.0
RED CLEAR	-	2.0	1.0	2.0	-	2.0	1.0	2.0
RED REVERT	-	-	-	-	-	-	-	-
WALK II	-	-	-	-	-	-	-	-

The signal shall dwell green in #4 & #8.

FUNCTION	PHASE							
	1	2	3	4	5	6	7	8
VEHICLE RECALL	-	-	-	X	-	-	-	X
PED RECALL	-	-	-	-	-	-	-	-
RED LOCK	-	-	-	-	-	-	-	-
YELLOW LOCK	-	X	X	-	-	X	X	-
PERMIT	-	X	X	X	-	X	X	X
PED PHASES	-	-	-	X	-	X	-	X
LEAD PHASES	X	-	X	-	X	-	X	-
DOUBLE ENTRY	-	X	-	X	-	X	-	X
SEQUENTIAL TIMING	-	-	-	-	-	-	-	-
START-UP YELLOW	-	X	-	-	-	X	-	-
OVERLAP A	-	-	-	-	-	-	-	-
OVERLAP B	-	-	-	-	-	-	-	-
OVERLAP C	-	-	-	-	-	-	-	-
OVERLAP D	-	-	-	-	-	-	-	-
EXCLUSIVE	-	-	-	-	-	-	-	-
SIMULTANEOUS GAP	-	-	-	-	-	-	-	-

DETECTOR SUMMARY							
CAMERA NO.	DETECTION ZONE	MODE	SIZE (LxW)	PHASE CALLED	PHASE EXTENDED	DELAY/STRETCH TIMER	INITIAL SETTING (SEC.)
1	D6-1	PRESENCE	60x6	6	6	-	-
1	D6-2	PRESENCE	40x6	6	6	D	3.0
2	D4-1104	PULSE	60x6	4	4	S	1.0
2	D4-5&6	PRESENCE	60x6	4	4	-	-
2	D7-1	PRESENCE	60x6	7	7	-	-
3	D2-1	PRESENCE	60x6	2	2	-	-
3	D2-2	PRESENCE	40x6	2	2	D	3.0
4	D8-1104	PULSE	6x6	8	8	S	1.0
4	D8-5&6	PRESENCE	60x6	8	8	D	3.0
4	D8-7	PRESENCE	20x6	8	8	D	3.0
4	D3-1	PRESENCE	60x6	3	3	-	-

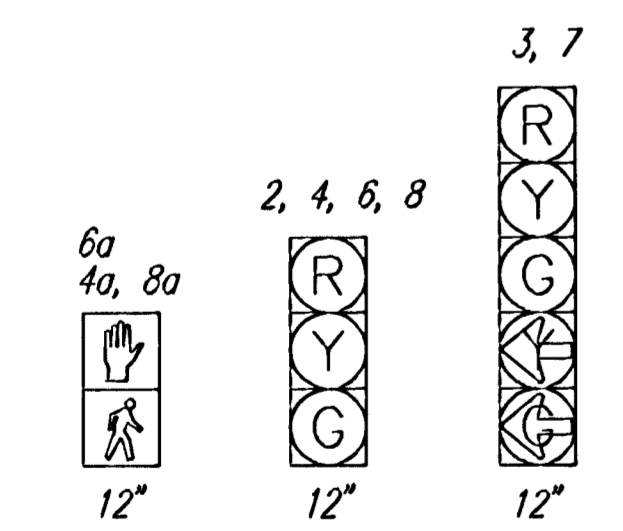

SIGNAL HEAD ARRANGEMENT

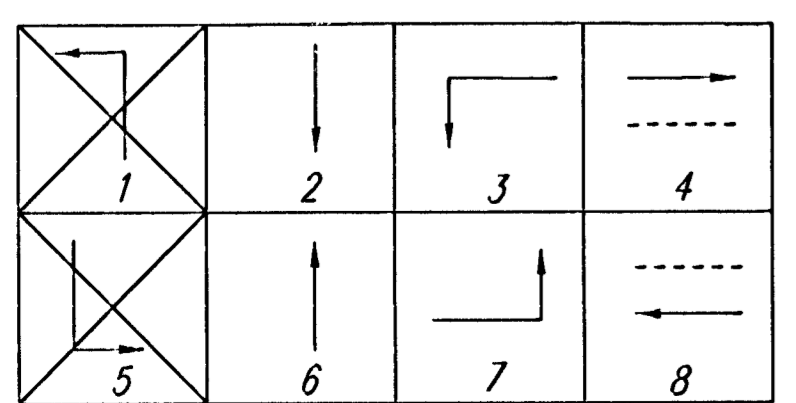

PHASE DIAGRAM

DSNR: BER OPER: BJS SCALE: 1"=20.00
 G:\2002\02620\004\TrafSignalPlan 02-11-2003 01:44:22 pm