

BENCHMARKS:
 BM #1: "□" Cut in top of curb, east return of SE corner of Lotus & Parkridge.
 Elev. = 145.99 (City Datum)

BM #2: "X" Cut on walk at NW corner of Lot 1, Block F, Flat Creek Addition
 Elev. = 146.22 (City Datum)

BM #3: "□" Cut in top of curb at the NW corner of Lot 1, Block B, Hunter's Ridge Addition.
 Elev. = 146.63 (City Datum)

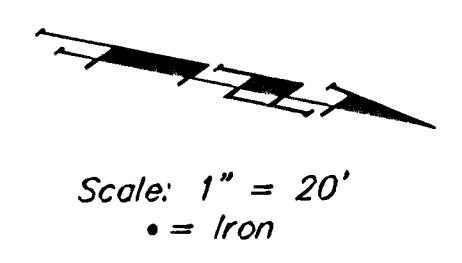

FLAT CREEK ADDITION

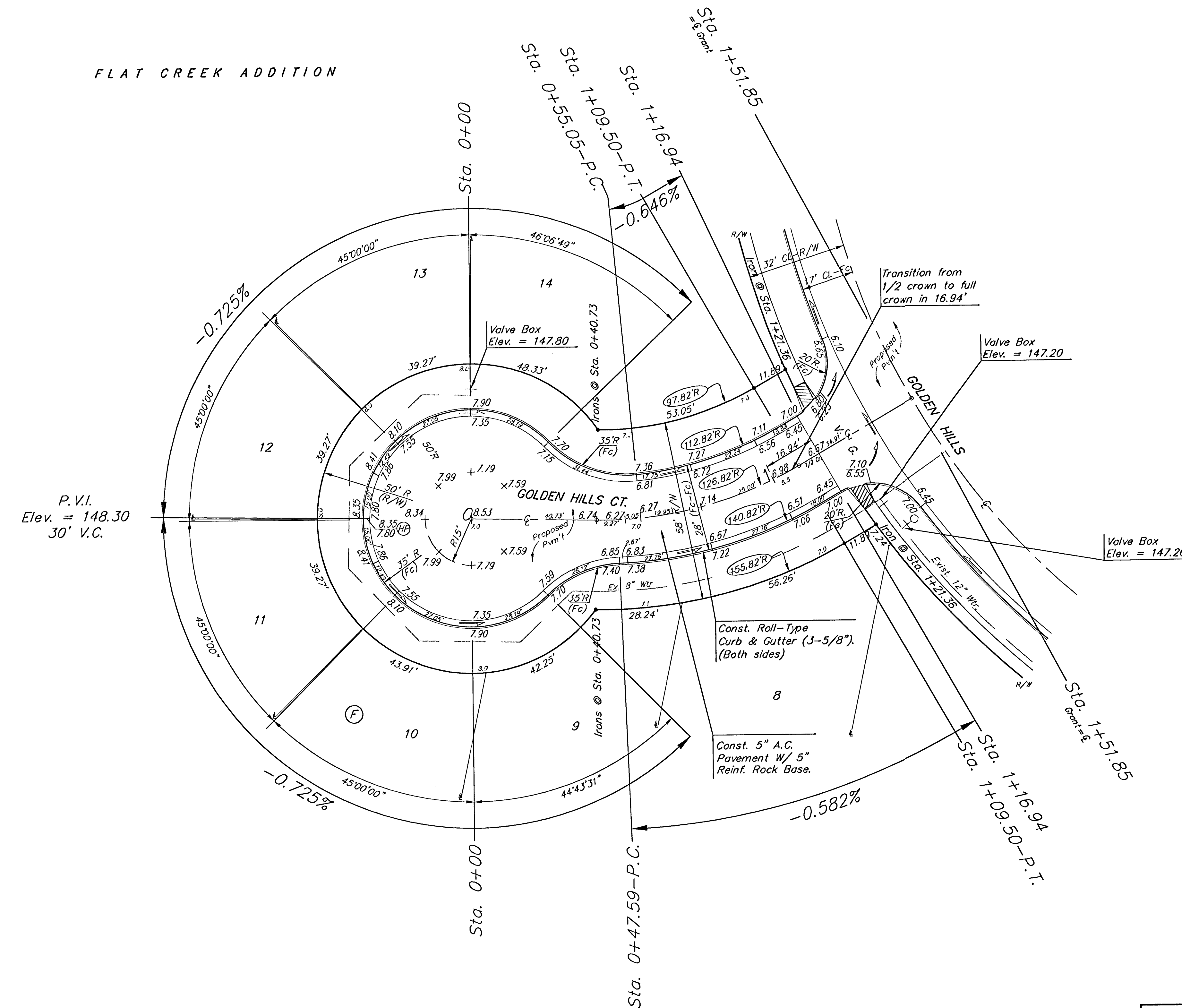

P.V.I.
 Elev. = 148.30
 30' V.C.

Curve #9
 Curve Data Based on Centerline
 Rad. = 126.82' Delta = 31° 04' 18" Tangent = 35.26'
 Arc = 68.77' L.C. = 67.94' Del/Pl. = 13.55460 Min.

Station	Arc	FACE CHORD LENGTHS		Defl.	
		B' Lt.	B' Rt.		
0+40.73	-	-	-	0°00'00"	0°00'00"
0+50.00	9.27'	7.66'	10.88'	2°05'39"	2°05'39"
0+75.00	25.00'	20.63'	29.29'	3°38'52"	7°44'31"
1+00.00	25.00'	13.34'	18.94'	3°38'51"	13°23'22"
1+09.50	9.50'	7.85'	11.15'	2°08'47"	15°32'09"

NOTE: ROLL TYPE CURB & GUTTER TO BE CONSTRUCTED ON THE PAVEMENT SHOWN ON THIS SHEET. TOP OF CURB ELEVATIONS ARE GIVEN FOR FULL HEIGHT CURB.

FLAT CREEK ADDITION

FLAT CREEK ADDITION PHASE II
GOLDEN HILLS CT.
 STA. 0+00 TO STA. 1+51.85

BAUGHMAN COMPANY P.A.
 ENGINEERING, SURVEYING, & PLANNING
 316-262-7271 • 315 ELLIS • WICHITA, KANSAS 67211

PROJECT NUMBER
472-83384

DESIGN: NGW | DRAWN: ESB/GNX | APPROVED: | DATE: 8/21/02 | SCALE: NOTED

SHEET **11** OF **43**