

BENCHMARKS:

BM #1: "□" Cut in top of curb, east return of SE corner of Lotus & Parkridge.
Elev. = 145.99 (City Datum)

BM #2: "X" Cut on walk at NW corner of Lot 1, Block F, Flat Creek Addition
Elev. = 146.22 (City Datum)

BM #3: "□" Cut in top of curb at the NW corner of Lot 1, Block B, Hunter's Ridge Addition.
Elev. = 146.63 (City Datum)



Scale: 1" = 20'
• = Iron

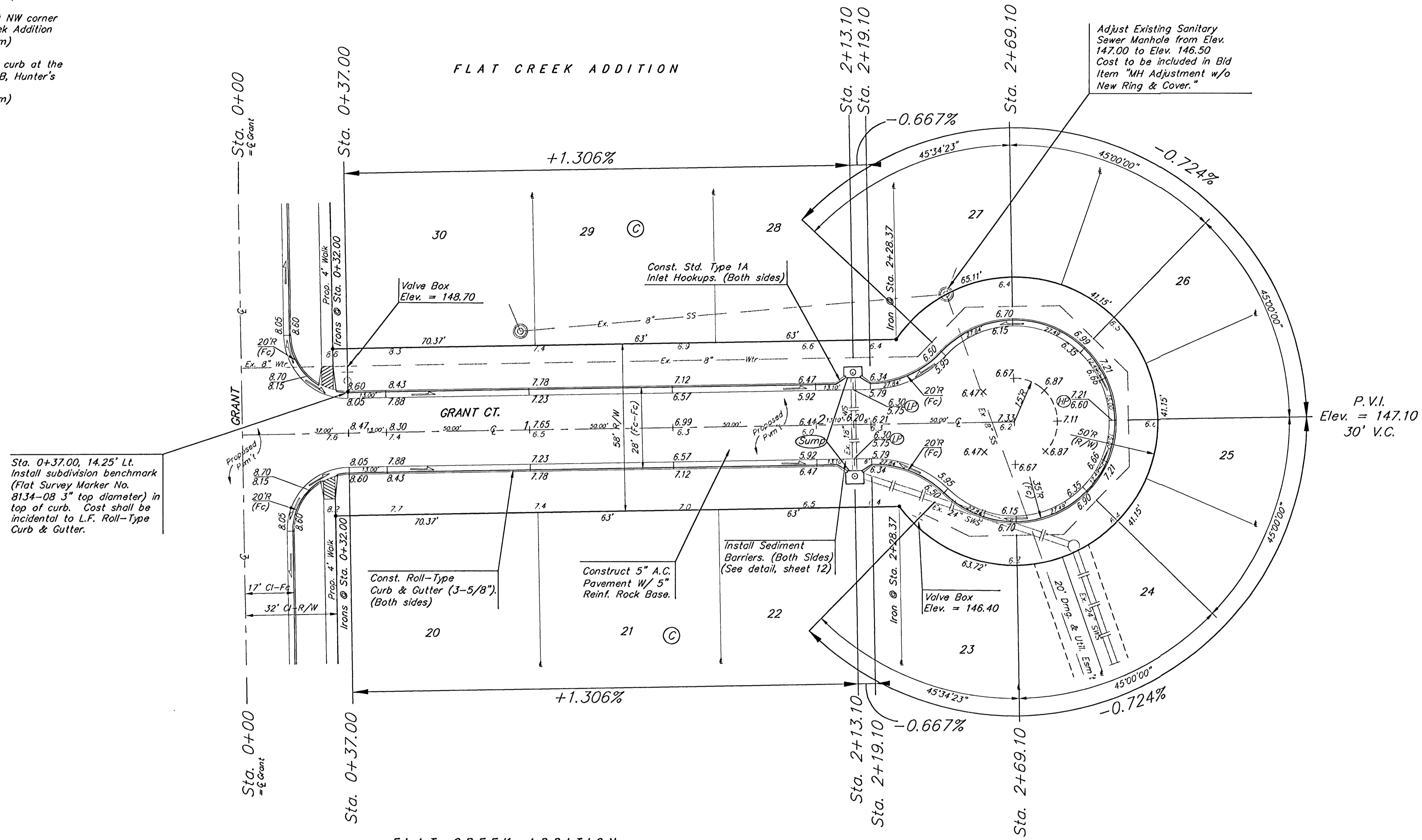

Sta. 0+37.00, 14.25' Lt. Install subdivision benchmark (Flat Survey Marker No. 8134-08 3" top diameter) in top of curb. Cost shall be incidental to L.F. Roll-Type Curb & Gutter.

Adjust Existing Sanitary Sewer Manhole from Elev. 147.00 to Elev. 146.50
Cost to be included in Bid Item "MH Adjustment w/o New Ring & Cover."

P.V.I.
Elev. = 147.10
30' V.C.

NOTE: ROLL TYPE CURB & GUTTER TO BE CONSTRUCTED ON THE PAVEMENT SHOWN ON THIS SHEET. TOP OF CURB ELEVATIONS ARE GIVEN FOR FULL HEIGHT CURB.

FLAT CREEK PHASE II				
GRANT CT.				
0+00 to 2+69.10, Block D				
BAUGHMAN COMPANY P.A.				
ENGINEERING, SURVEYING, & PLANNING				
316-262-7271 • 315 ELLIS • WICHITA, KANSAS 67211				
PROJECT NUMBER				
472-83384				
DESIGN	DRAWN	APPROVED	DATE	SCALE
NBW	ESB/GNX		8/21/02	NOTED
				SHEET 13 OF 43

FlatCreek-Ph21Str8