

BENCHMARKS:
 Oliver and 45th St. N. - Top of Brass Plate on SW Corner of R.C.B.C. East of Intersection. ELEV. = 1398.88 NGVD (211.48 City Datum)
 60d Nail in H.L.P., 33' S. of the NW Corner of Gov't. Lot 1 in the NE1/4 of Sec. 26, TWP. 26-S, R-1-E. of the 6th P.M. Elev. = 1377.19 NGVD (189.79 City Datum)

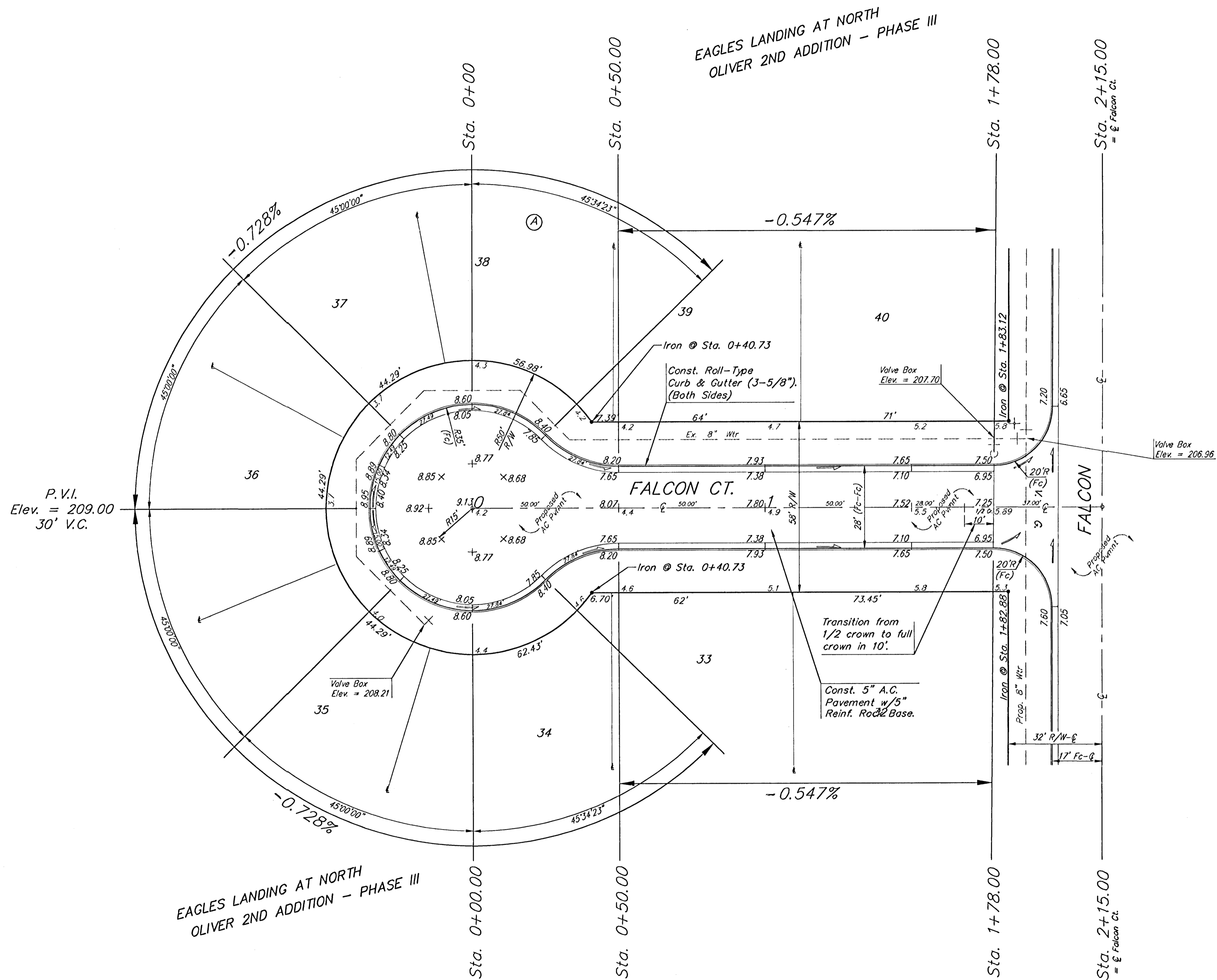

SCALE: 1" = 20'
 • = Iron



NOTE: ROLL TYPE CURB & GUTTER TO BE CONSTRUCTED ON THE PAVEMENT SHOWN ON THIS SHEET. TOP OF CURB ELEVATIONS ARE GIVEN FOR FULL HEIGHT CURB.

EAGLES LANDING AT NORTH OLIVER 2ND ADDITION - PHASE III
FALCON CT.
 STA. 0+00 TO STA. 1+78.00

BAUGHMAN COMPANY P.A.
 ENGINEERING, SURVEYING, & PLANNING
 316-262-7271 • 315 ELLIS • WICHITA, KANSAS 67211

PROJECT NUMBER
472-83488

DESIGN: BLP/AEG DRAWN: MK1/GHX APPROVED: DATE: 02/03 SCALE: NOTED SHEET: **8** OF **22**