

1" = 20'

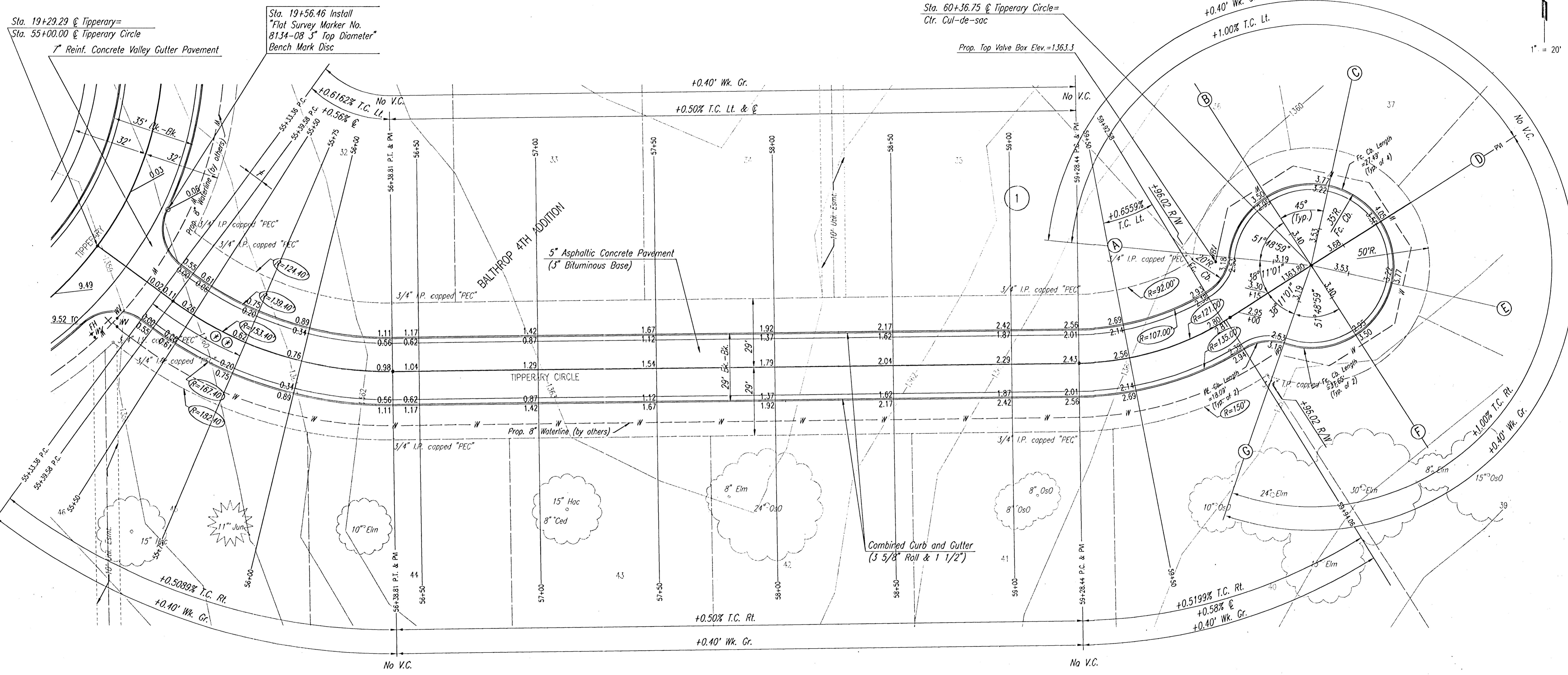

Δ=37°03'41\" L
D=37' 21\" 02.1\" R=153.40' L=99.23' T=51.42' E=8.39'

CURVE DATA BASED ON Δ radius Δ/2= 18° 31' 50.4\"

STATION	ARC LENGTH	FACE CURB LENGTH		CHORD LENGTH		DEFLECTION ANGLE	TOTAL DEFLECTION
		LEFT	RIGHT	8' OFF LEFT FACE CURB	8' OFF RIGHT FACE CURB		
55+39.58	10.42'	9.47'	11.37'	9.74'	13.00'	0°00'00.0"	0°00'00.0"
55+50.00	25.00'	22.72'	27.28'	23.34'	31.15'	01°58'45.5"	01°58'45.5"
55+75.00	25.00'	22.72'	27.28'	23.34'	31.15'	04°40'07.8"	08°36'53.3"
56+00.00	25.00'	22.72'	27.28'	23.34'	31.15'	04°40'07.8"	11°17'01.1"
56+25.00	25.00'	22.72'	27.28'	23.34'	31.15'	04°40'07.8"	15°57'08.8"
56+38.81	13.81'	12.55'	15.07'	12.90'	17.22'	02°34'44.6"	18°31'50.5"
TOTAL	99.23'	90.17'	108.28'				

Defl./ft. = 11.205172 min.

Δ=32°00'00\" L
D=47' 21\" 06.8\" R=121.00' L=67.58' T=34.70' E=4.88'

CURVE DATA BASED ON Δ radius Δ/2= 16° 00' 00\"

STATION	ARC LENGTH	FACE CURB LENGTH		CHORD LENGTH		DEFLECTION ANGLE	TOTAL DEFLECTION
		LEFT	RIGHT	8' OFF LEFT FACE CURB	8' OFF RIGHT FACE CURB		
59+28.44	21.56'	19.07'	24.05'	19.65'	28.38'	0°00'00.0"	0°00'00.0"
59+50.00	25.00'	22.11'	27.89'	22.77'	32.89'	05°06'16.3"	05°06'16.3"
59+75.00	25.00'	22.11'	27.89'	22.77'	32.89'	09°55'08.4"	11°01'24.7"
59+94.06	19.06'	16.85'	21.27'	17.38'	25.10'	04°30'45.5"	15°32'10.2"
59+36.02	1.38'	1.73'	2.19'	1.79'	2.58'	00°27'50.6"	16°00'00.0"
TOTAL	67.58'	59.76'	75.40'				

Defl./ft. = 14.205565 min.

≠ 5' TRANSITION FROM COMBINED CURB AND GUTTER 3 5/8\" ROLL & 1 1/2\" TO COMBINED CURB AND GUTTER (6 5/8\" & 1 1/2\"). TO BE BID AND AID FOR AS COMBINED CURB AND GUTTER (3 5/8\" ROLL & 1 1/2\").

⊗ ⊕ TRANSITION FROM NO CROWN TO NORMAL CROWN (3/8\" FT. X-SLOPE)

NOTE: THIS STREET TO BE CONSTRUCTED WITH ROLL-TYPE CURB. TOP OF CURB ELEVATIONS GIVEN ARE FOR FULL HEIGHT CURB.

DSNR: BER OPER: JGA SCALE: 1"=20.00'
 C:\2002\02608\000\TIPP CIR 55-60 02-10-2003 10:14:28 am



No.	Revision	By	Date

CITY OF WICHITA, KANSAS
 NEIL D. CABLE, P.E. - CITY ENGINEER
 BALTHROP 4TH ADDITION - PHASE 2
TIPPERARY CIRCLE
 STA. 55+00.00 TO STA. 60+36.75
 CITY OF WICHITA PROJECT NO. 472-83469

Professional Engineering Consultants, P.A.
 303 S. TOPEKA • WICHITA, KANSAS 67202
 316-262-2691 • FAX 316-262-3003

Designed by	BER	Job No.	35-02608-0
Drawn by	JGA	Date	January 2003

Sht. 8 of 43