

Sta. 21+83.28 @ White Tail=
Sta. 50+00.00 @ White Tail Court

Saw Cut, Remove, and Replace
A.C. Wearing Surface
as necessary to provide neat line.
This work to be Subsidiary
to "Asphalt Pavement".

1" = 20'

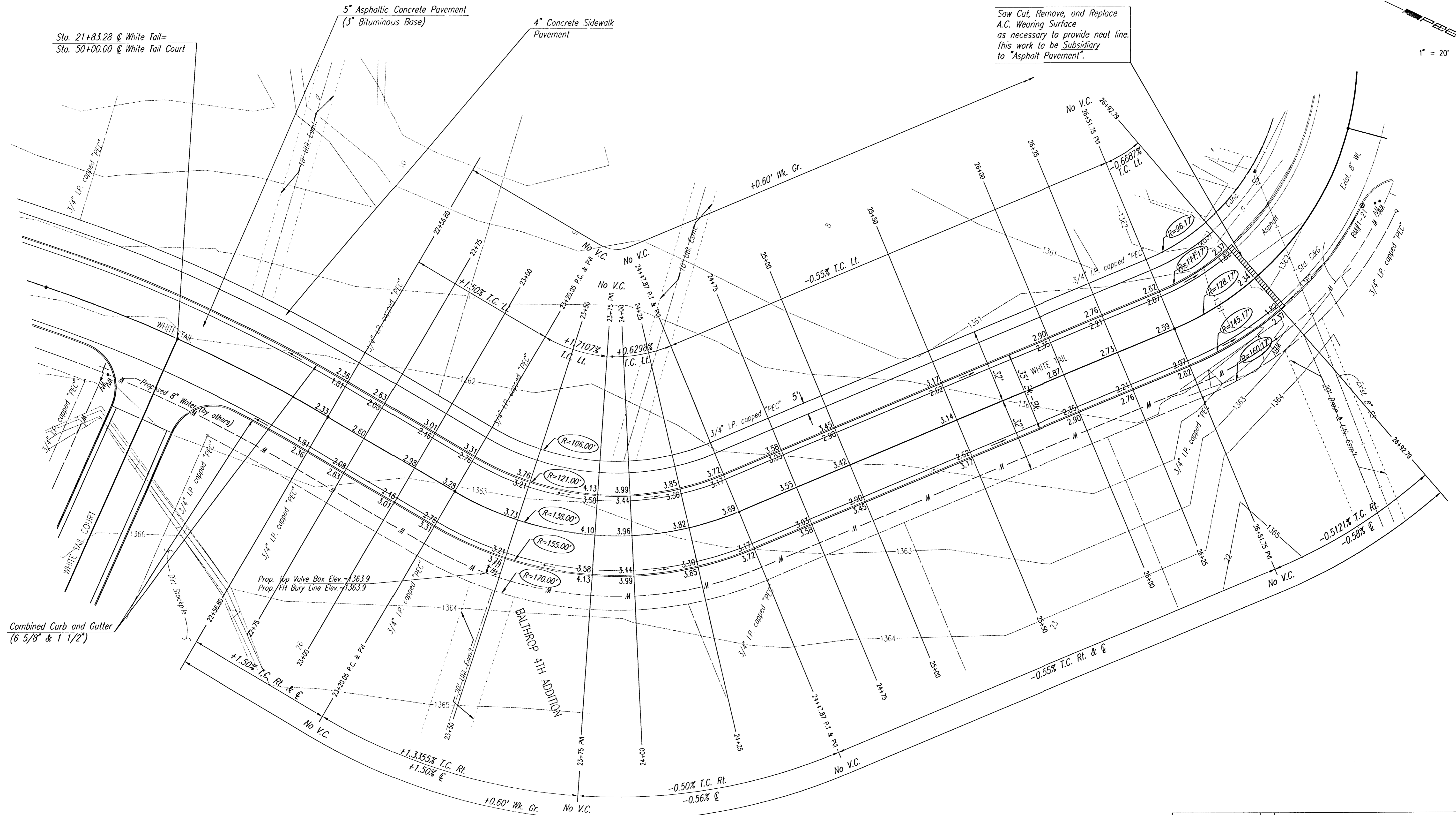

Δ=53°04'00" L D=41' 31' 07.5" R=138.00' L=127.81' T=68.90' E=16.25'

CURVE DATA BASED ON Δ radius Δ/2= 26° 32' 00"

STATION	ARC LENGTH	FACE CURB LENGTH		CHORD LENGTH		DEFLECTION ANGLE	TOTAL DEFLECTION
		LEFT	RIGHT	8' OFF LEFT FACE CURB	8' OFF RIGHT FACE CURB		
23+20.05	4.95'	4.34'	5.56'	4.55'	6.57'	0°00'00.0"	0°00'00.0"
23+25.00	25.00'	21.92'	28.08'	22.95'	33.11'	05°11'23.4"	08°13'02.7"
23+75.00	25.00'	21.92'	28.08'	22.95'	33.11'	05°11'23.4"	11°24'26.2"
24+00.00	25.00'	21.92'	28.08'	22.95'	33.11'	05°11'23.4"	18°35'49.6"
24+25.00	25.00'	21.92'	28.08'	22.95'	33.11'	05°11'23.4"	21°47'13.0"
24+47.86	22.86'	20.03'	25.98'	21.00'	30.29'	04°44'44.1"	26°32'00.1"
TOTAL	127.81'	112.07'	143.56'				

Defl./ft. = 12.455604 min.

Δ=18°20'36.8" L D=44' 42' 10.6" R=128.17' L=41.03' T=20.69' E=1.66'

CURVE DATA BASED ON Δ radius Δ/2= 9° 10' 18.4"

STATION	ARC LENGTH	FACE CURB LENGTH		CHORD LENGTH		DEFLECTION ANGLE	TOTAL DEFLECTION
		LEFT	RIGHT	8' OFF LEFT FACE CURB	8' OFF RIGHT FACE CURB		
26+51.75						0°00'00.0"	0°00'00.0"
26+75.00	23.25'	20.17'	26.33'	21.16'	31.41'	05°11'48.2"	05°11'48.2"
26+92.78	17.78'	15.43'	20.14'	16.20'	24.05'	05°58'26.7"	09°10'18.5"
TOTAL	41.03'	35.59'	46.48'				

Defl./ft. = 13.410887 min.

DSNR: BER OPER: JCA SCALE: 1"=20.00'
0:\2002\02608\000\W TAIL 22-26 02-07-2003 10:26:47 am

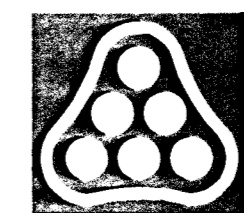

No.	Revision	By	Date
CITY OF WICHITA, KANSAS NEIL D. CABLE, P.E. - CITY ENGINEER BALTHROP 4TH ADDITION - PHASE 2 WHITE TAIL STA. 22+58.80 TO STA. 26+92.75 CITY OF WICHITA PROJECT NO. 472-83469 Professional Engineering Consultants, P.A. 303 S. TOPEKA - WICHITA, KANSAS 67202 316-262-2691 - FAX 316-262-3003			
Designed by	BER	Job No.	35-02608-0
Drawn by	JCA	Date	January 2003

Sht. 7 of 43