

**BENCHMARKS:**  
 "□" Cut in top of curb south end of east curb return 10th St. & Forestview adjacent to Lot 9, Block A, Liberty Park 3rd Addition Elev. = 168.43 (City Datum)

"□" Cut in top of curb 10' east of end of existing pavement adjacent to Lot 52, Block C, Liberty Park 3rd Addition Elev. = 164.21 (City Datum)

C.O.W. Benchmark Disk. 56' E and 55' N of  $\angle$  135th St. W. & 13th St. N. Elev. = 167.83 (City Datum)

C.O.W. Benchmark Disk. 1/2 mile south of 13th St. 39' east of  $\angle$  135th St. 18' south of hedge row. Elev. = 159.71 (City Datum)

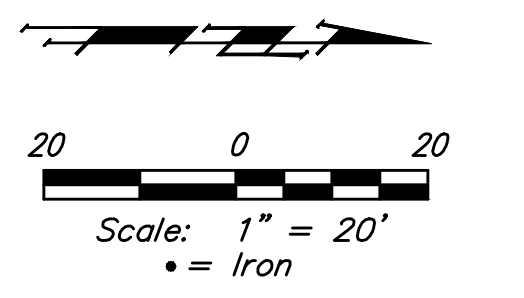

LIBERTY PARK 3RD ADDITION

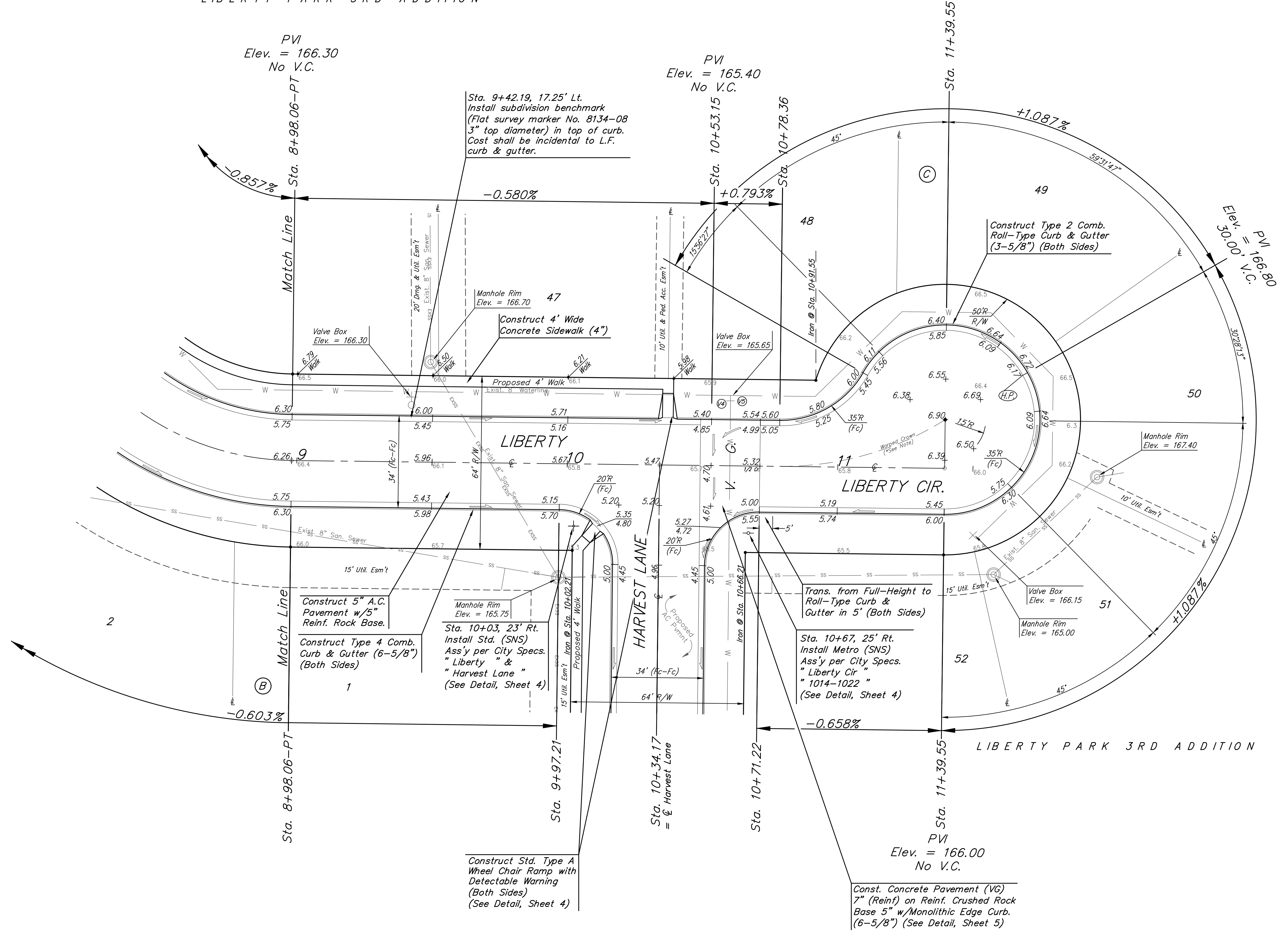

Roll type curb & gutter to be constructed on the pavement on this sheet. Top of curb elevation are given for full height curb.

NOTE: Warp Crown to Conform to the Approximate Center of Proposed Pavement.

		Liberty Park 3rd Addition - Phase 2C	
		<b>LIBERTY &amp; LIBERTY CIR</b> Sta. 8+98.06 to Sta. 11+39.55	
<small>Baughman Company, P.A. 315 Ellis St. Wichita, KS 67211 P 316-262-7271 F 316-262-0149          ENGINEERING   SURVEYING   PLANNING   LANDSCAPE ARCHITECTURE</small>			
PROJECT NUMBER 472-85140	DESIGN NBW	DRAWN JAK	
REVISIONS:	APPROVED	DATE 12/27/16	
	SCALE Noted	SHEET	
			<b>8 OF 22</b>