

- LEGEND:**
- (LP) = LOW POINT
 - (HP) = HIGH POINT
 - (PC) = POINT OF CURVATURE
 - (PT) = POINT OF TANGENCY
 - TC = TOP OF CURB
 - CN = CROWN
 - FL = FLOWLINE
 - = DIRECTION OF STORMWATER FLOW

- BENCHMARK:**
- CITY OF WICHITA DISC. ON W. SIDE OF CONCRETE BASE FOR KG&E TOWER, AT SE CORNER OF HOOVER & 2ND STREET.
ELEV. = 120.47 CITY DATUM
- NORTH BOLT OF FIRE HYDRANT, AT THE SE CORNER OF HOOVER & ST. LOUIS.
ELEV. = 124.13 CITY DATUM

STORM SEWER LINE NO. 1

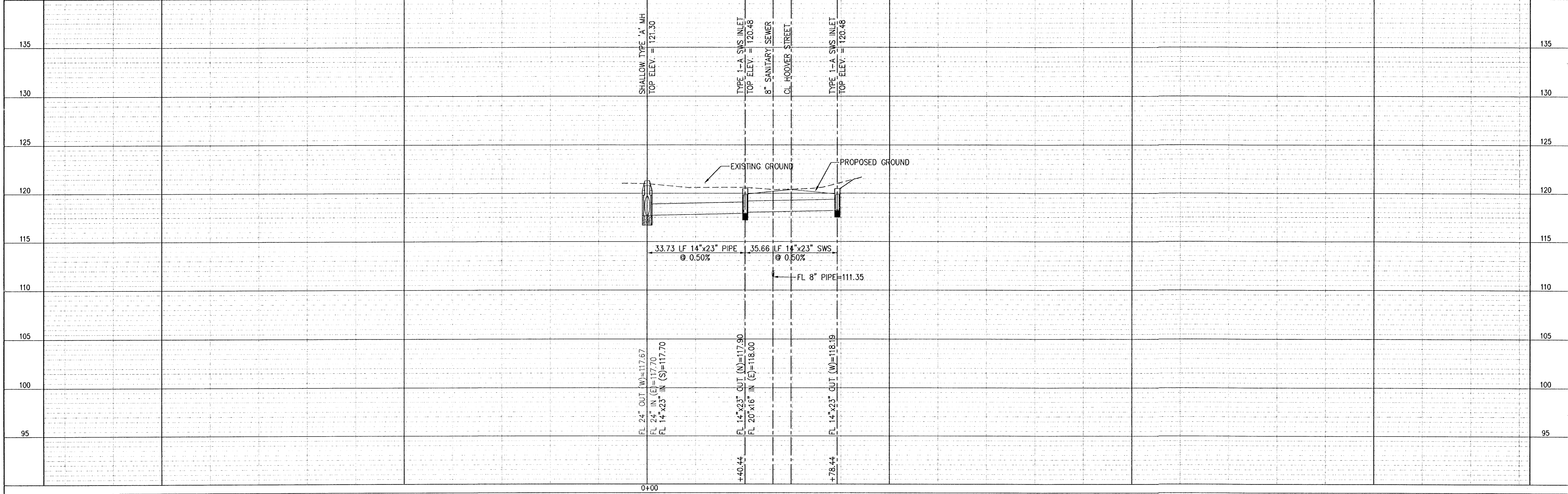

City of Wichita
 Sedgewick County, Kansas
SWS LINE NO. 1
PLAN / PROFILE
 Street and Storm Sewer Improvements

YOUNG & ASSOCIATES, PA
 Civil and Environmental Engineers
 100 South George
 Derby Kansas, 67037
 Project No.: 02-145
 Date: October 2002

Tel: (316) 788-2552
 Fax: (316) 788-4408
 Engr.: CRY
 Tech.: DAS, JVS

Sheet No. 6 of 16

C:\Acadwin\145\Final\145swspp1.dwg Tue Oct 15 09:01:06 2002