

- LEGEND:**
- (LP) = LOW POINT
 - (HP) = HIGH POINT
 - (PC) = POINT OF CURVATURE
 - (PT) = POINT OF TANGENCY
 - TC = TOP OF CURB
 - CN = CROWN
 - FL = FLOWLINE
 - ME = MATCH EXISTING ELEVATION
 - = DIRECTION OF STORMWATER FLOW
 - [Hatched] = PAVEMENT REMOVAL

- NOTES:**
1. UNLESS OTHERWISE INDICATED, DIMENSIONS ARE MEASURED TO BACK OF CURB.
 2. ALL TOP OF CURB GRADES ARE TO TOP OF COMBINED CURB & GUTTER. 0.25' MUST BE SUBTRACTED FROM TOP OF CURB ELEVATIONS TO TOP OF ROLL CURB.

BENCHMARK:
 CITY OF WICHITA DISC. AT THE NW COR. OF MAY & WEST ST. 65' W. OF CL WEST ST., 50' N. OF CL MAY
 ELEV. = 108.63 CITY DATUM
 NORTH BOLT OF FIRE HYDRANT, AT THE NW CORNER KESSLER & MAY
 ELEV. = 112.78 CITY DATUM

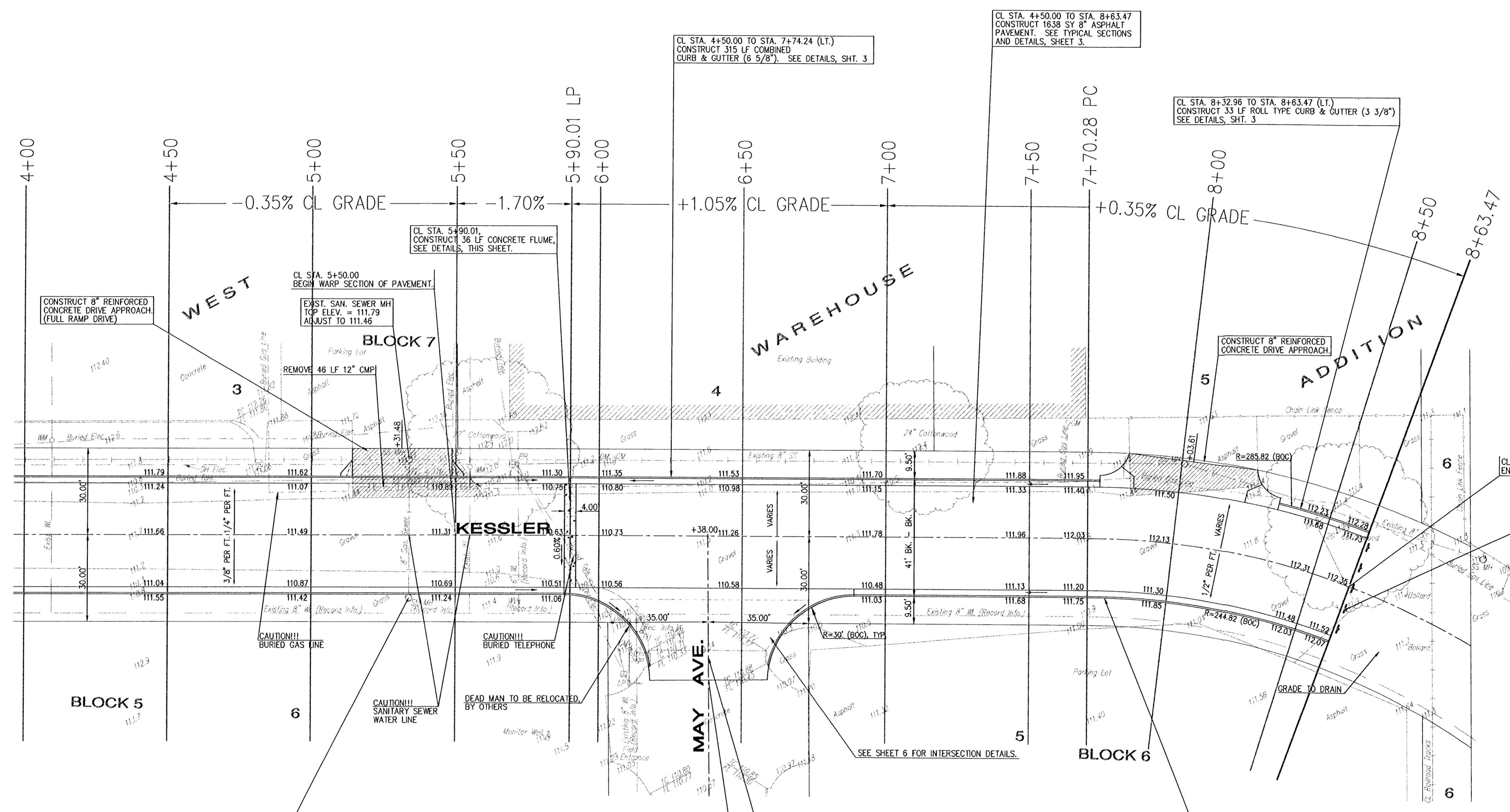

INSTALL END OF ROAD MARKERS (RED) AS SHOWN. (SEE DETAILS, THIS SHEET)

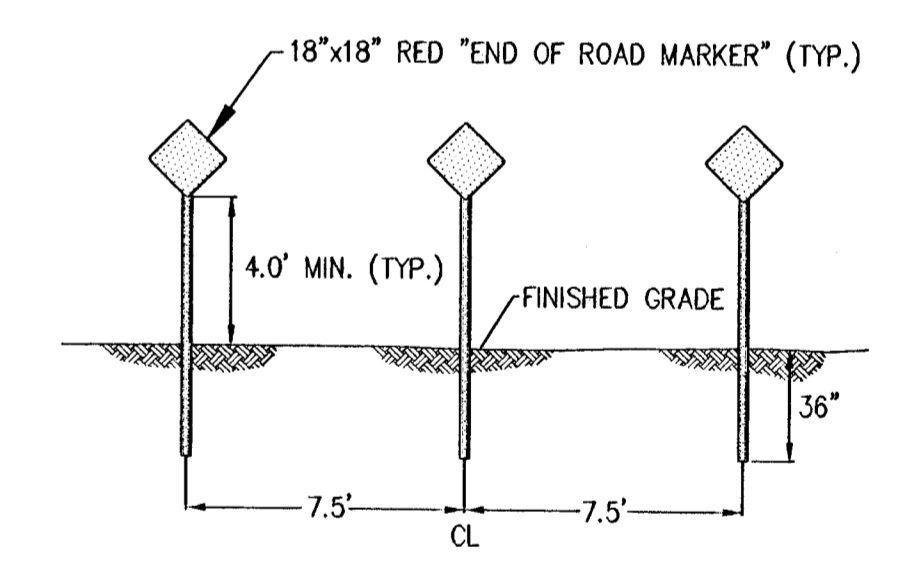

BARRICADE DETAIL

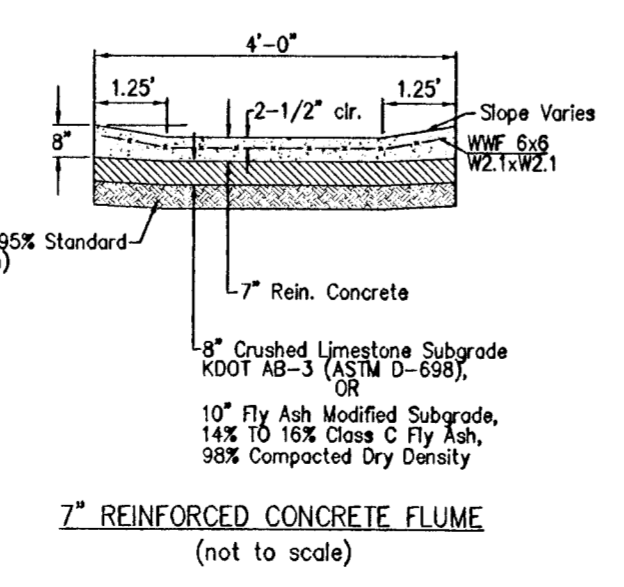

7" REINFORCED CONCRETE FLUME (not to scale)

YOUNG & ASSOCIATES, PA
 Civil and Environmental Engineers
 100 South Georgia
 Derby Kansas, 67037
 Tel: (316) 788-2552
 Fax: (316) 788-4408

City of Wichita
 Sedgwick County, Kansas

KESSLER STREET
 (Sta. 4+50.00 TO 8+63.47)
 PAVING PLAN

Date: October 2002	Engr.: CRY	Tech.: DAS, JVS
Y&A Proj. No.: 02-144	Scale: As Noted	

Sheet No. 5 of 15

C:\acadm\144\FINAL\144strpp2.dwg Men Nov 25 12:01:07 2002